



## 55 Coleman Drive

Staddiscombe, Plymouth, PL9 9UN

**£925 PCM**



VIEWING APPOINTMENTS NOW FULLY BOOKED. A lovely modern corner terraced house available unfurnished from June 2025. It is unfurnished and has accommodation including 2 bedrooms. Modern kitchen and bathroom and lounge.

There is an enclosed garden and parking space. It is available on a long term basis.



55 COLEMAN DRIVE, STADDISCOMBE, PL9 9UN

ACCOMMODATION

Part-obscured double-glazed door leading into the entrance lobby.

ENTRANCE LOBBY

2 built-in storage cupboards. Doorway leading into the kitchen.

KITCHEN 5'6" x 9'7" maximum (1.68 x 2.94 maximum)

A series of matching eye level and base units with tiled splash-backs and rolled-edge work surfaces. Inset sink unit with mixer tap. Space and plumbing for washing machine. Space for gas or electric cooker. Space for upright fridge-freezer.

LOUNGE 14'0" x 11'9" maximum (4.28 x 3.60 maximum)

Stairs rising to the first floor accommodation. Double-glazed bay window to the front elevation.

FIRST FLOOR LANDING

Loft hatch. Doorways leading into the first floor accommodation.

BATHROOM 6'3" x 5'6" (1.92 x 1.69)

Obscured double-glazed window to the side elevation. A coloured suite including panelled bath with twin hand-grips, mixer tap, over the bath shower unit with spray attachment, shower screen, low level wc and pedestal wash handbasin. Vertical towel rail/radiator.

BEDROOM ONE 10'4" x 8'7" (3.15 x 2.62)

Built-in storage cupboard. Double-glazed window to the front elevation.

BEDROOM TWO 8'7" x 7'1" (2.64 x 2.17)

Double-glazed windows to front and rear elevations.

OUTSIDE

At the front of the property is a fence-enclosed garden area with a paved area and a sloped lawn section, along with a timber shed. Allocated parking.

Area Map



Floor Plans

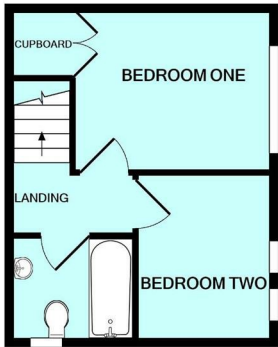

Energy Efficiency Graph

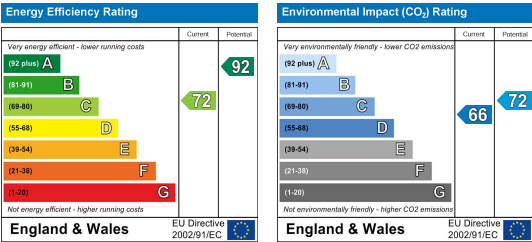

These particulars, whilst believed to be accurate are set out as a general outline only for guidance and do not constitute any part of an offer or contract. Intending purchasers should not rely on them as statements of representation of fact, but must satisfy themselves by inspection or otherwise as to their accuracy. No person in this firm's employment has the authority to make or give any representation or warranty in respect of the property.