



**BENJAMIN
STEVENS.**
estate agents



Greatham Road, Bushey WD23 2HT

Asking Price £420,000

TWO DOUBLE BEDROOM MID TERRACE HOUSE situated on a sought after residential road in Bushey, conveniently located and within walking distance to all local shopping and transport facilities. The property benefits from: Two Double Bedrooms, Two Bathrooms, Replacement Double Glazed Windows, Gas Fired Heating To Radiators, Reception Room, Dining Room, Fully Fitted Kitchen, Rear Garden.
NO UPPER CHAIN

Greatham Road, Bushey WD23 2HT

Exterior:



Bedroom One:



Living/Dining Room:



Ensuite:



Reception:



Bedroom Two:



Greatham Road, Bushey WD23 2HT

Shower Room:

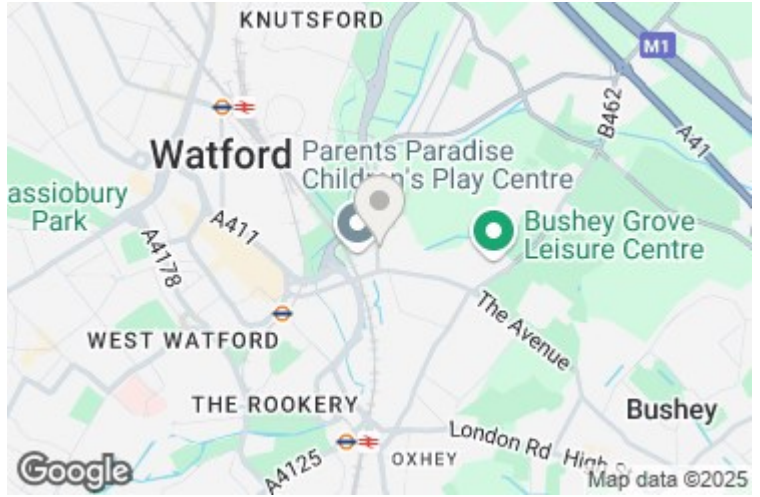

Kitchen:



Garden:



Tenure:

This is a freehold property.

Council Tax Band C £2,035 per annum.

As always buyers are advised to gain verification from their surveyor/solicitor during the conveyancing process.

Disclaimer:

While every care and effort has been made to ensure these details are correct their accuracy cannot be guaranteed and so should not form part of any contract.

GROUND FLOOR
473 sq.ft. (43.9 sq.m.) approx.

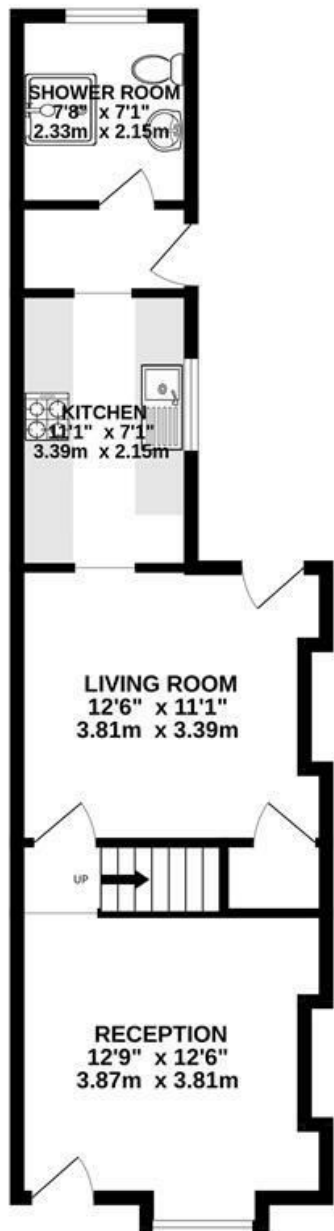

1ST FLOOR
390 sq.ft. (36.3 sq.m.) approx.



TOTAL FLOOR AREA : 863 sq.ft. (80.2 sq.m.) approx.

Whilst every attempt has been made to ensure the accuracy of the floorplan contained here, measurements of doors, windows, rooms and any other items are approximate and no responsibility is taken for any error, omission or mis-statement. This plan is for illustrative purposes only and should be used as such by any prospective purchaser. The services, systems and appliances shown have not been tested and no guarantee as to their operability or efficiency can be given.
Made with Metropix ©2024

