

66 West End · Redruth · Cornwall · TR15 2SQ

t: 01209 210333

e: bill@billbannister.co.uk · www.billbannister.co.uk

BILL BANNISTER

Sales & Lettings



24 Claremont Road

Redruth, TR15 1LP

Guide price £325,000



This lovely character house has been carefully updated by the current vendors and offers very well presented family sized accommodation. It benefits from three bedrooms, two reception rooms, a fitted kitchen, useful utility, a ground floor shower and first floor family bathroom. The property is double glazed and this is complemented by gas fired heating. Externally there is parking to the front and a well enclosed south west facing rear garden taking advantage of the sun.



Situated in the popular area of Claremont Road, this property has been carefully and thoughtfully updated over recent years to provide modern family accommodation with traditional features. It has three bedrooms to the first floor together with a family bathroom and an extra WC. To the ground floor there are two reception rooms, one of which has a fine fireplace as has the master bedroom. The kitchen is particularly well appointed with plenty of appliances. To the rear a utility room leads to a shower room and wc. The property has gas fired heating and this is complemented by double glazing. Features include a lovely coved ceiling in the lounge with an ornate ceiling rose and the dining room also has a centre rose. Good use is made of tiled flooring throughout the vestibule and hallway. The dining room has pine flooring and there is laminate flooring in the kitchen. Externally there is the bonus of parking for two vehicles to the front and the rear garden is well enclosed being south west facing taking advantage of the sun. It is simply laid out and has rear vehicular access. Redruth town is within approximately a quarter of a mile virtually level walk and Tesco and the A30 are within easy reach.

ENTRANCE VESTIBULE

4'1" x 4'10" (1.26m x 1.49m)

Single glazed door with two obscure panels, tiled floor and consumer unit. Part obscure glazed door to:

HALLWAY

Focusing on a fine staircase with a generous understairs cupboard. Radiator with a shelf above.

LOUNGE

12'10" x 14'6" (3.93m x 4.42m)

A lovely centre ceiling rose and coving. Bay window and a focal point wood burner and hearth. Radiator.

DINING ROOM

11'7" x 11'3" (3.55m x 3.43m)

A lovely pine floor that quite possibly maybe original. There is an ornate cast and tiled fireplace with a slate hearth. External door, radiator and a centre ceiling rose.

KITCHEN

9'6" x 14'4" (2.92m x 4.39m)

Well appointed with various appliances to include an oven, hob, cooker hood and fridge. Fitted with plenty of units incorporating a one and a half bowl sink unit, working surfaces with cupboards and drawers beneath and a wine rack. Splash backs are provided and there is a built-in shelved cupboard plus a breakfast bar. Radiator, spot lighting and a granite mantel above the cooker hood.

UTILITY ROOM

9'7" x 5'5" (2.93m x 1.67m)

With laminate flooring, a single drainer stainless steel sink unit, working surfaces and space for white goods. Radiator, double glazed door to the rear and a wall mounted Glow Worm gas combi boiler.

SHOWER ROOM

9'3" x 2'3" (2.84m x 0.70m)

Tiled shower cubicle, a wash hand basin and wc. Radiator.

FIRST FLOOR

BEDROOM 1

10'1" x 14'9" (3.09m x 4.50m)

With a bay window and a focal point cast fireplace (probably original). Wall panel, a shelved cupboard and a radiator.

BEDROOM 2

11'10" x 11'4" (3.62m x 3.47m)

Wall panel, cupboard with a shelf and a radiator. Window to the rear elevation and a raised cupboard giving access to some storage in the rear sloping roof.

BEDROOM 3

6'4" x 8'2" (1.94m x 2.49m)

Window to the front and a radiator.

LANDING

Loft hatch and ladder. Radiator.

REAR HALF LANDING

Access to:

BATHROOM

9'3" x 7'10" (2.82m x 2.41m)

Panelled bath, separate shower cubicle with a mains shower and tiling plus a circular wash hand basin with storage beneath and a shelf. WC, tiled floor, radiator, extractor fan and spot lighting.

SEPARATE THIRD WC

OUTSIDE

There is a hard standing to the front providing parking for two vehicles. To the rear the garden is well enclosed with a courtyard to the side having a tap and an external power point. Double fuel bunker. Beyond this is a side flower border leading to a rectangular lawned garden with a side path. This leads to a pedestrian gate to a vehicular access lane. The rear garden is south west facing and takes advantage of the sun.

DIRECTIONS

From our office in Redruth proceed along Chapel Street and into Foundry Row. Turn right by the playground into Roaches Row and this will then lead to Claremont Road. The property will be found on the right hand side identified by a For Sale board.

Area Map



Floor Plans

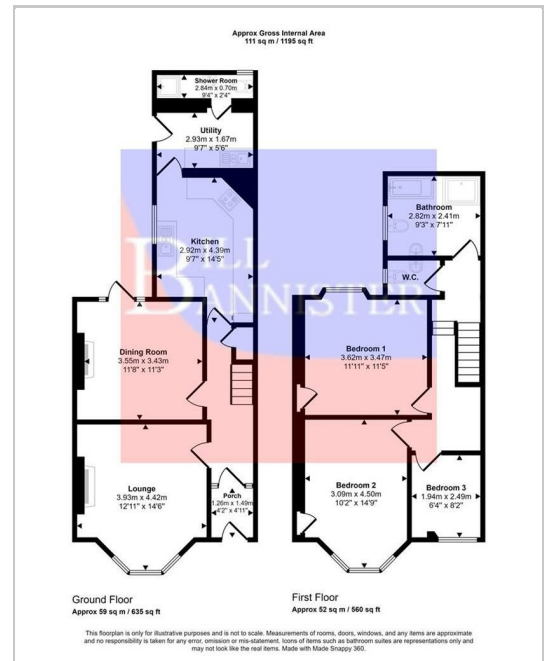

Energy Efficiency Graph

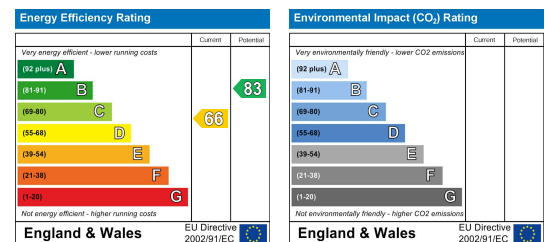

These particulars, whilst believed to be accurate are set out as a general outline only for guidance and do not constitute any part of an offer or contract. Intending purchasers should not rely on them as statements of representation of fact, but must satisfy themselves by inspection or otherwise as to their accuracy. No person in this firm's employment has the authority to make or give any representation or warranty in respect of the property.