



 **MovingInn**
sales, lettings & management

Reigate Road | | Bromley | BR1 5JL

Offers In Excess Of £380,000

 **MovingInn**
sales, lettings & management

Reigate Road | Bromley | BR1 5JL Offers In Excess Of £380,000

Moving Inn are pleased to bring to the market this immaculately presented two bedroom mid-terrace house in Bromley. Chain free, the house offers large accommodation arranged over two floors.

The beautiful windows allow an abundance of natural light. Both bedrooms are double size and the reception room is a good size too. The property boasts a beautiful bathroom with floor to ceiling tiled walls, and a nice kitchen. The property further benefits from a 78 foot rear garden and a front garden / driveway.

The house is located in a residential area with green spaces nearby.

EPC rating D

Council Tax: Lewisham band C

NB. All measurements and photographs are for a guide only.

- Chain Free
- Freehold
- Garden
- Modern Bathroom

Full description



Reigate Road, BR1

Approximate Gross Internal Area 64.4 sq m / 694 sq ft

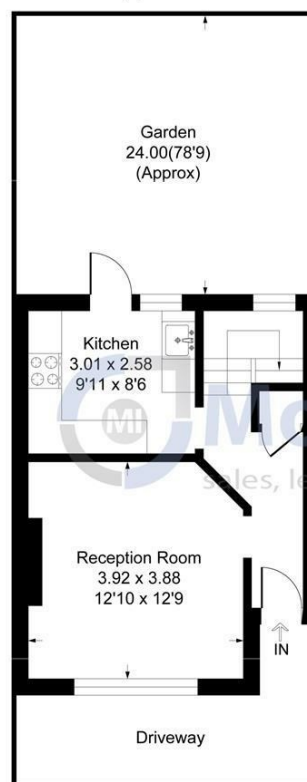

Ground Floor

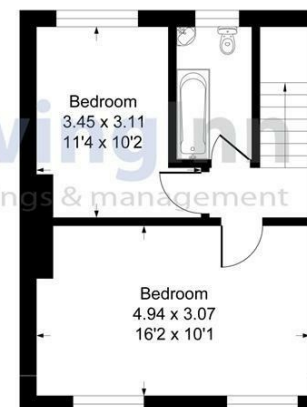

First Floor

This Plan is for layout guidance only. Not drawn to scale unless stated. Windows and door openings are approximate. Whilst every care is taken in the preparation of this plan, please check all dimensions shapes and compass bearings before making any decisions reliant upon them.
Produced by Squarefootphoto.co.uk

Energy Efficiency Rating		
	Current	Potential
Very energy efficient - lower running costs		
(92 plus) A		
(81-91) B		81
(69-80) C		
(55-68) D	61	
(39-54) E		
(21-38) F		
(1-20) G		
Not energy efficient - higher running costs		
England & Wales	EU Directive 2002/91/EC	

Council Tax Band C
EPC Rating D

467 Norwood Road
West Norwood
London
SE27 9DJ
02087610830

dean@movinginn.co.uk
www.movinginn.co.uk