



Finchley Road, London NW8 6DR

WAYNE
& SILVER

Finchley Road, London NW8 6DR

A well-presented two-bedroom apartment (964 sqft) set on the fourth floor situated within a private portered block. This home comprises 2 bedrooms, spacious reception room, separate eat-in kitchen, family bathroom and balcony. Hot water and heating included in the rent.

Queens Court is located on the corner of Finchley Road and Queens Terrace, about a minutes' walk from St Johns Wood Underground Station (Jubilee Line) and St Johns Wood High Street. 2 Bedrooms : Bathroom : Reception Room : Kitchen : Balcony : Porter : Lift : EPC Rating C

2 Bedrooms : Bathroom : Reception Room : Kitchen : Balcony : Porter : Lift : EPC Rating C

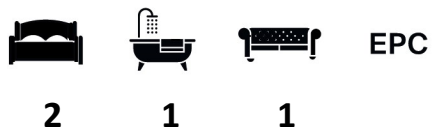

Guide price: £2,881 Per Month

Tenure:

Service Charge: Add text here

Local Authority: Westminster

Council Tax Band: F





WAYNE
& SILVER



WAYNE
& SILVER



Queens Court, NW8

Approximate Gross Internal Area = 962 sq ft / 89.4 sq m

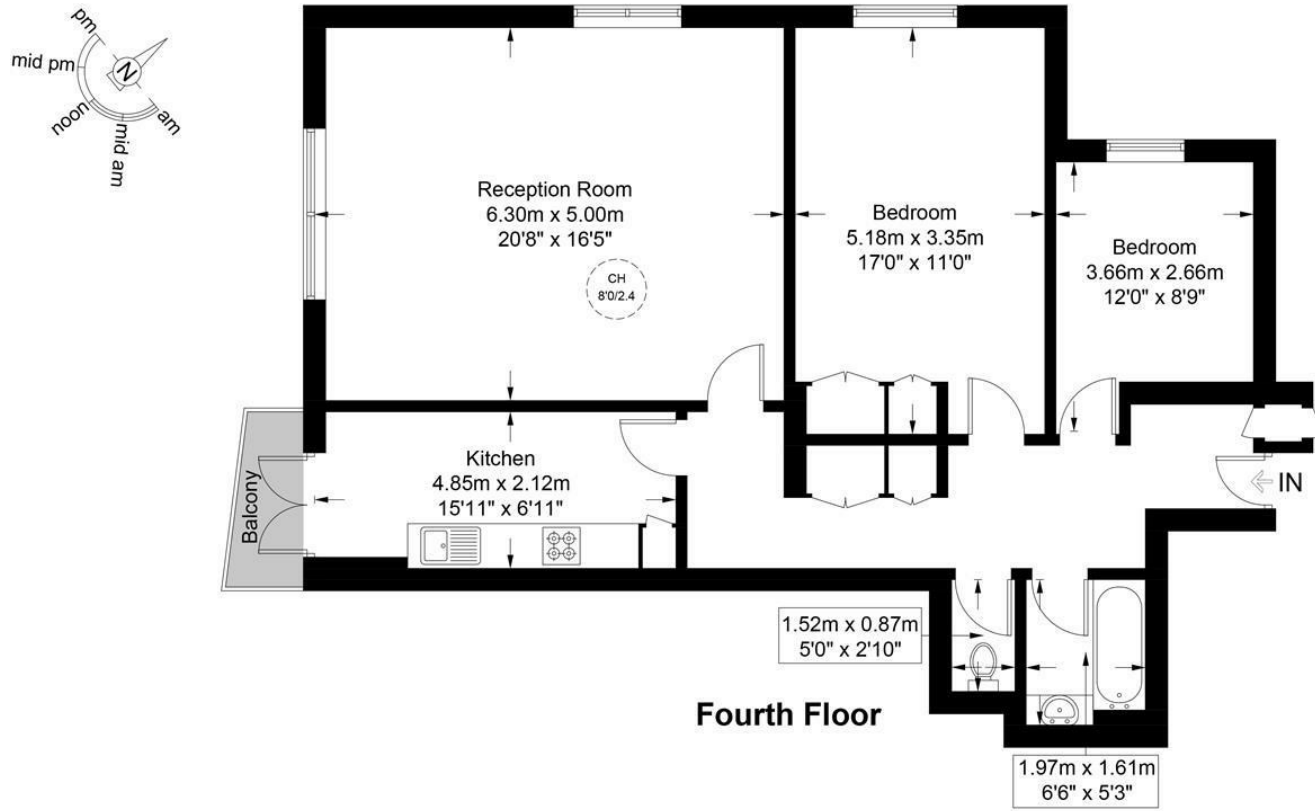

This plan is for layout guidance only and is not drawn to scale unless stated. All dimensions, including windows, doors, and the Total Gross Internal Area (GIA), are approximate. For precise measurements, please consult a qualified architect or surveyor before making any decisions based on this plan.



41 Heath Street
Hampstead
London
NW3 6UA

We would be delighted to tell you more
020 7431 4488
info@wayne-silver.com

wayne-silver.com

Important Notice: Wayne & Silver, its clients and any joint agents give notice that 1: They are not authorised to make or give any representations or warranties in relation to the property either here or elsewhere, either on their own behalf or on behalf of their client or otherwise. They assume no responsibility for any statement that may be made in these particulars. These particulars do not form part of any offer or contract and must not be relied upon as statements or representations of fact. 2: Any areas, measurements or distances are approximate. The text, photographs and plans are for guidance only and are not necessarily comprehensive. It should not be assumed that the property has all necessary planning, building regulation or other consents and Wayne & Silver have not tested any services, equipment or facilities. Purchasers must satisfy themselves by inspection or otherwise.