

# WAYNE & SILVER



2 Mapesbury Road, London, NW6 7PW

£519 Per Week

WAYNE  
& SILVER

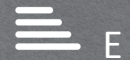



WAYNE  
& SILVER

£519 Per Week

## 2 Mapesbury Road

London, NW6 7PW

A fantastic two double bedroom second floor maisonette set within this popular block in the Mapesbury Conservation Area. This very well maintained block benefits from beautifully manicured communal gardens, off-street parking and communal hot water and heating.

The apartment is newly refurbished with big windows over-looking the communal gardens making it bright and airy, further accommodation includes a separate modern kitchen, two double bedrooms, a family bathroom and ample storage throughout.

Ideally located to Kilburn Underground station (Jubilee Line) and Brondesbury Overground station.







WAYNE  
& SILVER

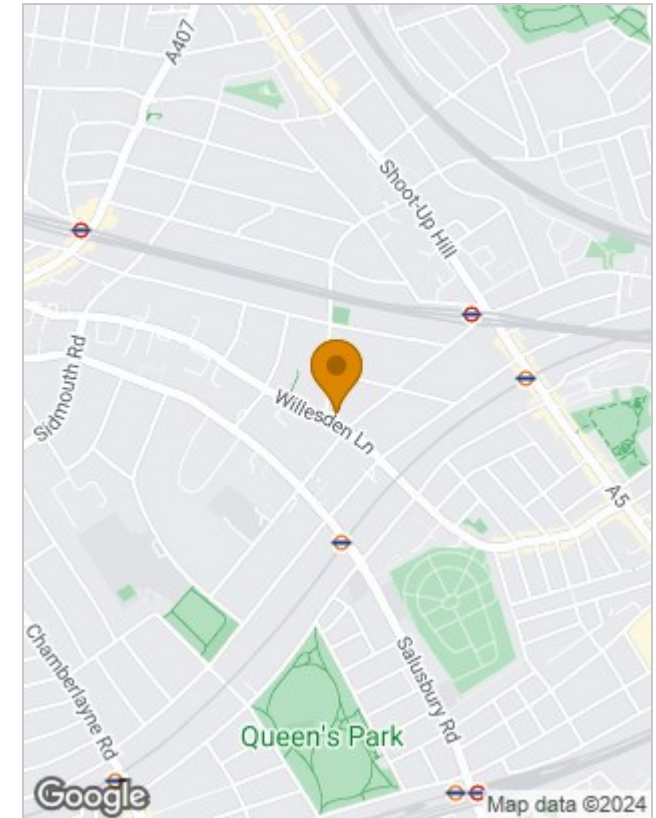
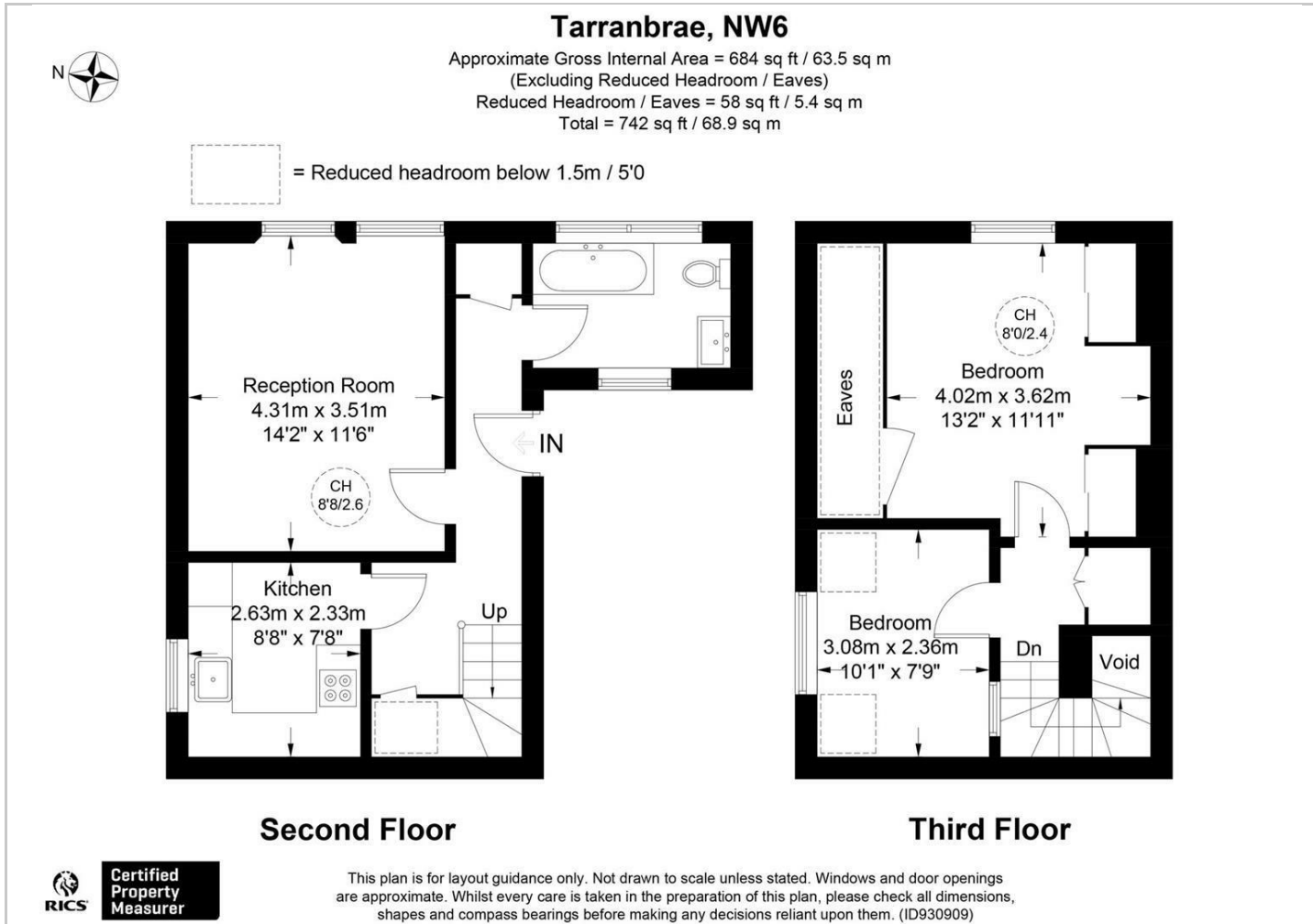

Energy Performance Graph

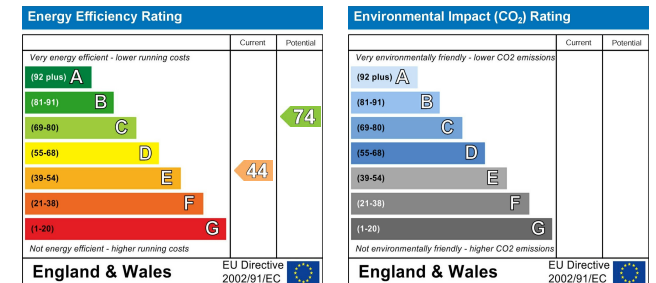

Viewing

Please contact our Wayne & Silver Lettings Office on 020 7431 4488 if you wish to arrange a viewing appointment for this property or require further information.

The particulars are set out as a general outline only for the guidance of intended purchasers or lessees, and do not constitute, any part of a contract. Nothing in these particulars shall be deemed to be a statement that the property is in good structural condition or otherwise nor that any of the services, appliances, equipment or facilities are in good working order. Purchasers should satisfy themselves of this prior to purchasing.