

Road Map



Hybrid Map



Terrain Map



Floor Plan

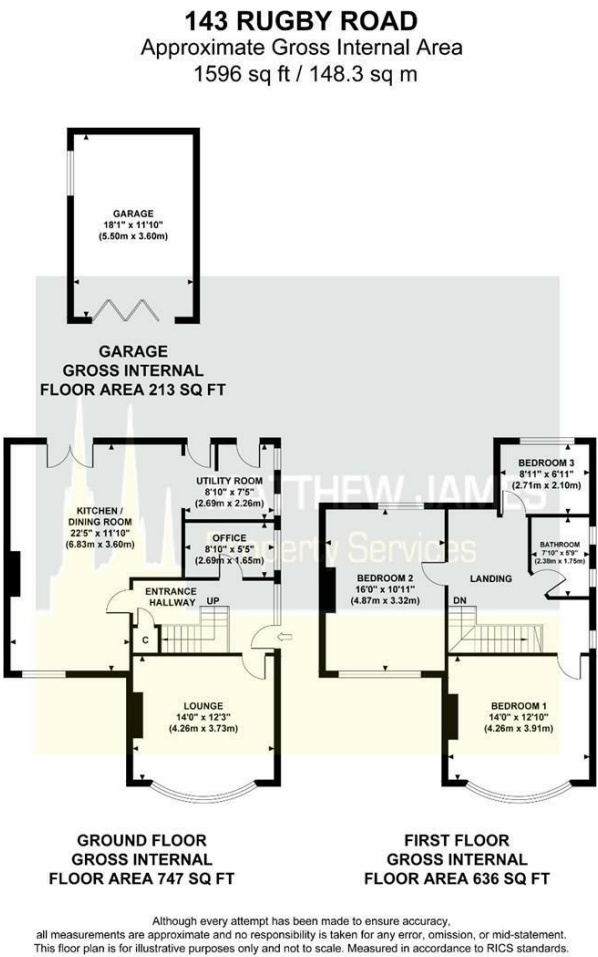

Viewing

Please contact us on 02477 170170 if you wish to arrange a viewing appointment for this property or require further information.

These particulars, whilst believed to be accurate are set out as a general outline only for guidance and do not constitute any part of an offer or contract. Intending purchasers should not rely on them as statements of representation of fact, but must satisfy themselves by inspection or otherwise as to their accuracy. No person in this firms employment has the authority to make or give any representation or warranty in respect of the property.

CONTACT INFORMATION

24a Warwick Row, Coventry CV1 1EY
02477 170170

info@matthewjames.uk.com
www.matthewjames.uk.com

Facebook
Twitter



143 Rugby Road
Binley Woods, Coventry CV3 2AY

£450,000



143 Rugby Road

Binley Woods, Coventry CV3 2AY

£450,000



Approach / Driveway

Entrance Hallway

Lounge
14'0 x 12'3

Office
8'10 x 5'5

Kitchen / Diner
22'5 x 11'10

Utility Room
8'10 x 7'5

First Floor Landing

Bedroom One
14'0 x 12'10

Bedroom Two
16'0 x 10'11

Bedroom Three
8'11 x 6'11

Family Bathroom
7'10 x 5'9

Garage
18'1 x 11'10

Rear Garden

