

Road Map



Hybrid Map



Terrain Map



Floor Plan

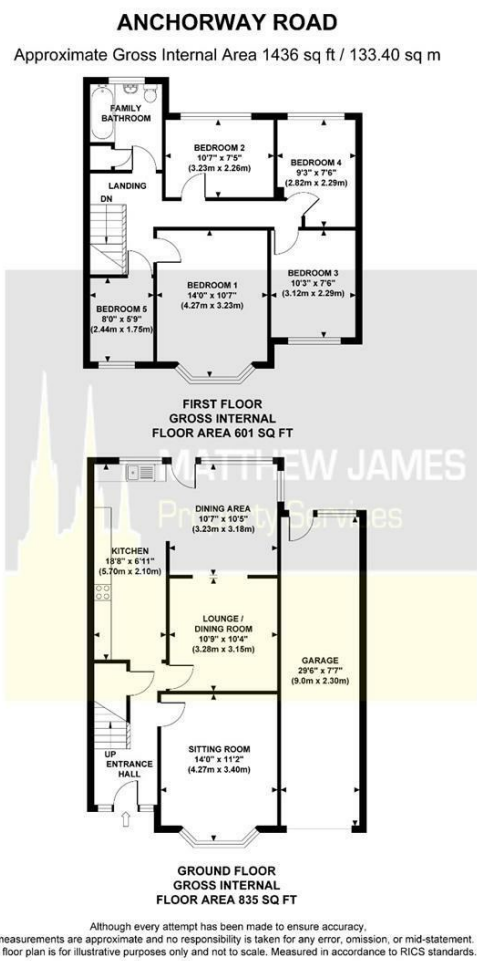

**165 Anchorway Road**  
Finham, Coventry CV3 6JH

Offers In Excess Of £390,000



Viewing

Please contact us on 02477 170170 if you wish to arrange a viewing appointment for this property or require further information.

Energy Efficiency Graph

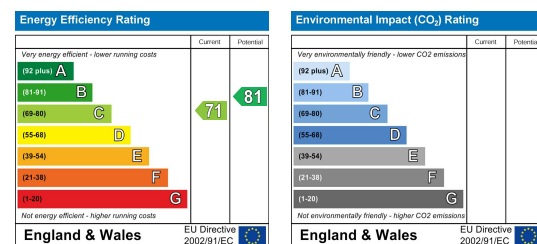

These particulars, whilst believed to be accurate are set out as a general outline only for guidance and do not constitute any part of an offer or contract. Intending purchasers should not rely on them as statements of representation of fact, but must satisfy themselves by inspection or otherwise as to their accuracy. No person in this firm's employment has the authority to make or give any representation or warranty in respect of the property.



CONTACT INFORMATION

24a Warwick Row, Coventry CV1 1EY  
02477 170170

info@matthewjames.uk.com  
www.matthewjames.uk.com

Facebook  
Twitter

# 165 Anchorway Road

Finham, Coventry CV3 6JH

Offers In Excess Of £390,000



**Approach**

**Entrance Hall**

**Lounge**  
10'9 x 10'4

**Kitchen**  
18'8 x 6'11

**Dining Area**  
10'7 x 10'5

**Sitting Room**  
14'0 x 11'2

**Upstairs Landing**

**Bedroom One**  
14,0 x 10'7

**Bedroom Two**  
10'7 x 7'5

**Bedroom Three**  
10'3 x 7'6

**Bedroom Four**  
9'3 x 7'6

**Bedroom Five**  
8'0 x 5'9

**Family Bathroom**

**Garage**  
27'11 x 7'6

**Rear Garden**

