



Church Gate Cottage

Llanfaes, LL58 8LP

£375,000



UNDER OFFER

Aptly named Church Gate Cottage, this character detached stone cottage is within a small cluster of six cottages built around the majestic St Catherine's Church, in a rural location just over a mile to the historic seaside town of Beaumaris. The cottage has been recently and thoughtfully upgraded and extended and is presently used as a very successful holiday let, achieving around 90% occupation.

The cottage has a large and light open plan kitchen and living room with Aga woodburning stove with patio door onto private gardens and patio enjoying a southerly aspect. There are two double bedrooms and a modern wet room. There are well tended private gardens with ample off road parking as well as a detached garage. It has the benefit of oil central heating and double glazing.

Well worthy of inspection and sold with no onward chain.

Kindly note Saturday viewing only during "changeover"

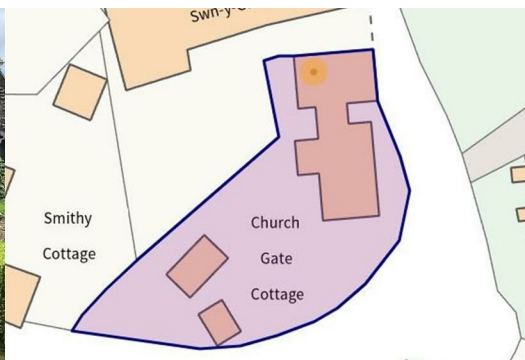

Spacious Hall 7'4" x 6'0" (2.25 x 1.83)

Having a composite double glazed entrance door and further double glazed patio door to give access to the rear. Timber effect ceramic floor tiling which extends throughout the whole cottage, ample coat hanging space, radiator.

Inner Hall

With linen cupboard with both shelving and radiator, further radiator, hatch to the roof space.

Open Plan Living/Kitchen

A naturally light living space with dual aspect windows offering far reaching views of Eryri's mountain tops, together with a patio door leading to the rear garden patio.

Kitchen Area 10'8" x 7'5" (3.26 x 2.27)

Having a modern range of base and wall units in a light grey timber finish with contrasting worktop surfaces and tiled surround. Integrated appliances include a ceramic hob with concealed extractor over and oven under, together with a dishwasher and washing machine. Stainless steel sink unit with monobloc tap under a front aspect window overlooking the Church.

Living Area 18'9" x 15'8" (5.74 x 4.79)

A spacious living area with feature inglenook fireplace housing an Aga woodburning stove on a polished slate hearth and with timber mantle over. Radiator, tv and telephone connections.

Bedroom 1 12'0" x 9'3" (3.68 x 2.84)

A double bedroom with dual aspect windows and radiator.

Bedroom 2 12'0" x 11'4" (3.67 x 3.47)

Another double bedroom with rear aspect window with radiator under.

Modern Wet Room 7'7" x 5'7" (2.33 x 1.71)

Recently upgraded with a ceramic tiled floor and paneled walls and to include a shower area with thermostatic twin head shower control and glazed shower screen. Wall hung WC and wash basin with mirror/light/shaver point over, towel radiator.

Outside

Enjoying a good sized proportional garden to the rear, this garden enjoys a good amount of privacy and has fine views of not only the Church but distant mountain views.

Adjacent to the rear living room patio is a spacious brick paved patio area being a perfect spot to sit out to enjoy the afternoon and evening sun, and this patio opens up onto a level lawned garden well screen by established boundary hedging. At the far corner of the garden is a Garden Shed 3.2m x 2.0m with electric provided and shelving.

The brick paving extends around the cottage and is wide enough adjacent to the front door to park a small car.

Access off the adopted highway is shared with other cottages and leads to both a detached Garage together with a second private parking area capable of parking 2 cars lengthwise, or caravan/boat.

Detached Garage 16'4" x 8'2" (5.00 x 2.50)

With an up and over door, workbench, power and light. Private gated area in front of the garage to park an additional car

Services

Mains water and electricity.

Private drainage.

Oil fired central heating.

Double glazed windows and doors.

Tenure

The cottage is understood to be freehold and this will be confirmed by the vendors' conveyancer.

Council Tax

Currently no Council Tax is payable under the Government Small Business Relief Scheme. (Previously banded D by the Council).

Energy Efficiency

Band E.

Agents Notes

The cottage is currently used as a very successful holiday let property, achieving circa 90% occupation.

As a consequence, the Vendors will consider selling as a "going concern" and negotiate on the contents.

Change over is on Saturday, and viewings can only be between 11am and 3pm on Saturday, by appointment only.

Area Map



Floor Plans

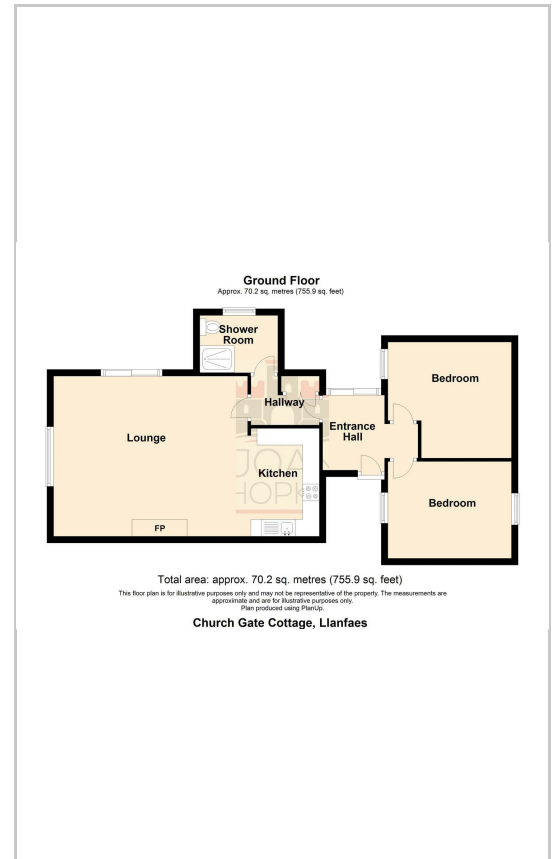

Energy Efficiency Graph

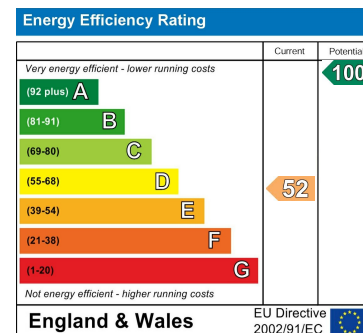

These particulars, whilst believed to be accurate are set out as a general outline only for guidance and do not constitute any part of an offer or contract. Intending purchasers should not rely on them as statements of representation of fact, but must satisfy themselves by inspection or otherwise as to their accuracy. No person in this firm's employment has the authority to make or give any representation or warranty in respect of the property.

Tudor Rose, 32 Castle Street, Beaumaris, Sir Ynys Mon, LL58 8AP

Tel: 01248 810847 Email: enquiries@joan-hopkin.co.uk https://www.joan-hopkin.co.uk