



Windsor Drive, Caldicot

4 Bedrooms
2 Bathrooms
2 Receptions

£430,000



Located in the charming village of Magor, and with No Onward Chain! This delightful detached house on Windsor Drive offers a perfect blend of comfort and style. With four spacious bedrooms, this property is ideal for families seeking a welcoming home. The two reception rooms provide ample space for relaxation and entertaining, making it easy to host gatherings with friends and family.

Entered via a welcoming reception hall featuring a convenient cloakroom, the house features a cosy family kitchen and sizable utility room. There is a warm and inviting atmosphere throughout this much loved family home. The layout of the property is both practical and appealing, catering to the needs of contemporary living.

Situated in a peaceful neighbourhood, this property benefits from the tranquillity of village life while remaining close to local amenities. Residents can enjoy the nearby parks, shops, and schools, making it an excellent choice for families and professionals alike.

This house on Windsor Drive is not just a place to live; it is a place to create lasting memories. With its generous living space and prime location, it presents a wonderful opportunity for those looking to settle in a vibrant community. Do not miss the chance to make this lovely house your new home.



Living Room
12'9x17'9

Kitchen
10'7x11'5

Utility
7'9x11'9

Sitting Room
12'8x10'9

Hallway
8'3x13'2

Cloakroom
4'7x5'9

Bedroom One
12'8x11'3

Bedroom Two
12'8x10'10

Bedroom Three
10'6x10'4

Bedroom Four
7'8x11'3

Sunroom
6'9x4'6

Bathroom
9'4x6'1

Landing
7'1x6'8





Floor 0

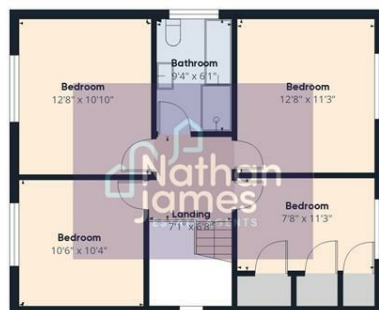

Floor 1

Approximate total area¹
1619.87 ft²

Reduced headroom
20.32 ft²

(1) Excluding balconies and terraces

Reduced headroom
..... Below 5 ft

While every attempt has been made to ensure accuracy, all measurements are approximate, not to scale. This floor plan is for illustrative purposes only.

Calculations were based on RICS IPMS 3C standard. Please note that calculations were adjusted by a third party and therefore may not comply with RICS IPMS 3C.

GIRAFFE360

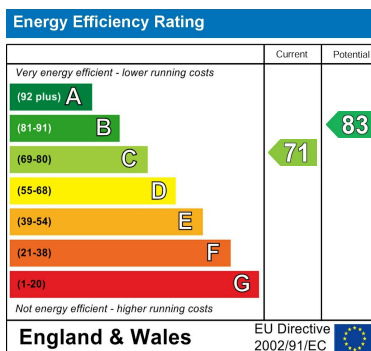

8 Newport Road
Caldicot
Monmouthshire
NP26 4HX

01291 421600

nj@nathanjamesestateagents.co.uk

nathanjamesestateagents.com