

Flat 1, 83 Bayham Street, Camden Town, London, NW1 0AG

£2,058 PCM

- A ONE DOUBLE BEDROOM, FIRST FLOOR FLAT IN THE HEART OF CAMDEN TOWN
- MODERN FULLY FITTED OPEN PLAN KITCHEN
- AMPLE STORAGE
- RECEPTION ROOM
- TILED BATHROOM SUITE
- APPROX 5 MINUTE WALK TO EITHER CAMDEN OR MORNINGTON CRESCENT UNDER GROUND STATION (NORTHERN LINE)
- ONE DOUBLE BEDROOM
- WOOD FLOORING THROUGHOUT

71 Parkway, London, NW1 7PP
020 7485 0112

lettings@mchughandcompany.co.uk
www.mchughandco.com

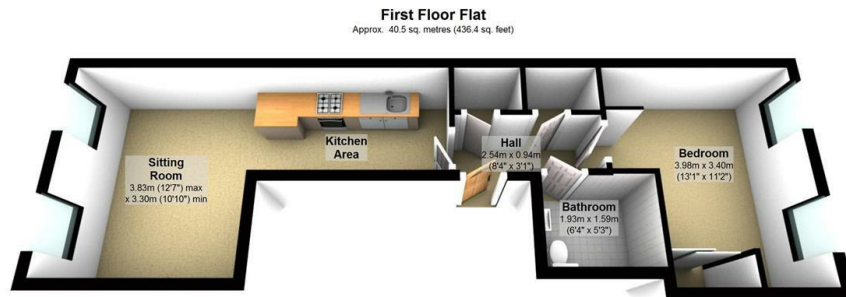

Total area: approx. 40.5 sq. metres (436.4 sq. feet)
Illustrations are for viewing purposes only. Measurements are not to scale.
Plan produced using PlanUp.

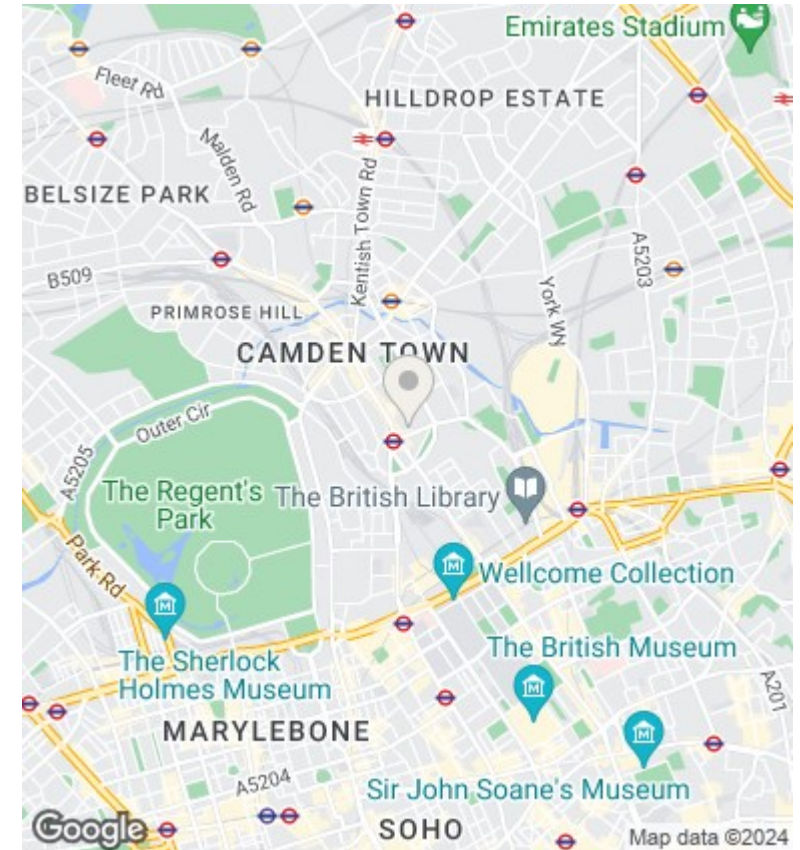

Viewings

Viewings by arrangement only. Call 020 7485 0112 to make an appointment.

Council Tax Band

C

EPC Rating:

C

Energy Efficiency Rating		Current	Potential
<i>Very energy efficient - lower running costs</i>			
(92 plus) A			
(81-91) B		77	77
(69-80) C			
(55-68) D			
(39-54) E			
(21-38) F			
(1-20) G			
<i>Not energy efficient - higher running costs</i>			
England & Wales		EU Directive 2002/91/EC	