

241 Deansgate, Manchester, Lancashire, M3 4EL

Tel: 0161 637 8336

Email: contactus@ascendproperties.com

www.ascendproperties.com

Ascend

Built on higher standards



City Link, Hessel Street, Salford

£1,100 PCM

Luxury and convenience in one - that's what you'll find at City Link.

The centrepiece of this three-bedroom property is the open plan kitchen/lounge complete with tiled kitchen area, high quality tables, seats, sofas and a large window which truly brings this apartment to life. The bedrooms are nice sized doubles so you'll be able to kick your shoes off after a long day, stretch out and enjoy the peaceful surroundings. This spacious property also benefits from soft carpets and a nice sized bathroom in a lovely white finish.

City Link has a bus stop and the Weaste Metrolink stop within 2 mins walk. MediaCityUK is just a stone's throw away and travelling to and from the city centre is an absolute breeze.

If you're interested in having a closer look, or have any questions, do get in touch. And just so you know, the pictures for this apartment are for marketing purposes only. The internal fixtures, fittings and furnishings may vary.

Available NOW (subject to application & referencing)

12 Month Tenancy.

Deposit: £1,260.

Council tax band B.



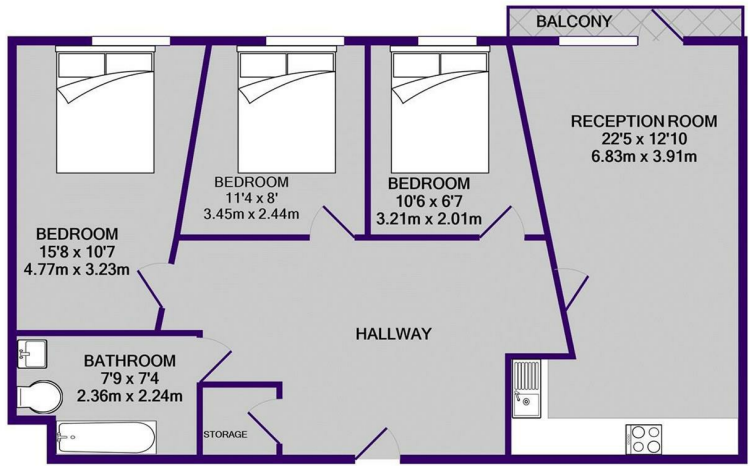

TOTAL APPROX. FLOOR AREA 872 SQ.FT. (81.0 SQ.M.)

Whilst every attempt has been made to ensure the accuracy of the floor plan contained here, measurements of doors, windows, rooms and any other items are approximate and no responsibility is taken for any error, omission, or mis-statement. This plan is for illustrative purposes only and should be used as such by any prospective purchaser. The services, systems and appliances shown have not been tested and no guarantee as to their operability or efficiency can be given
Made with Metropix ©2020

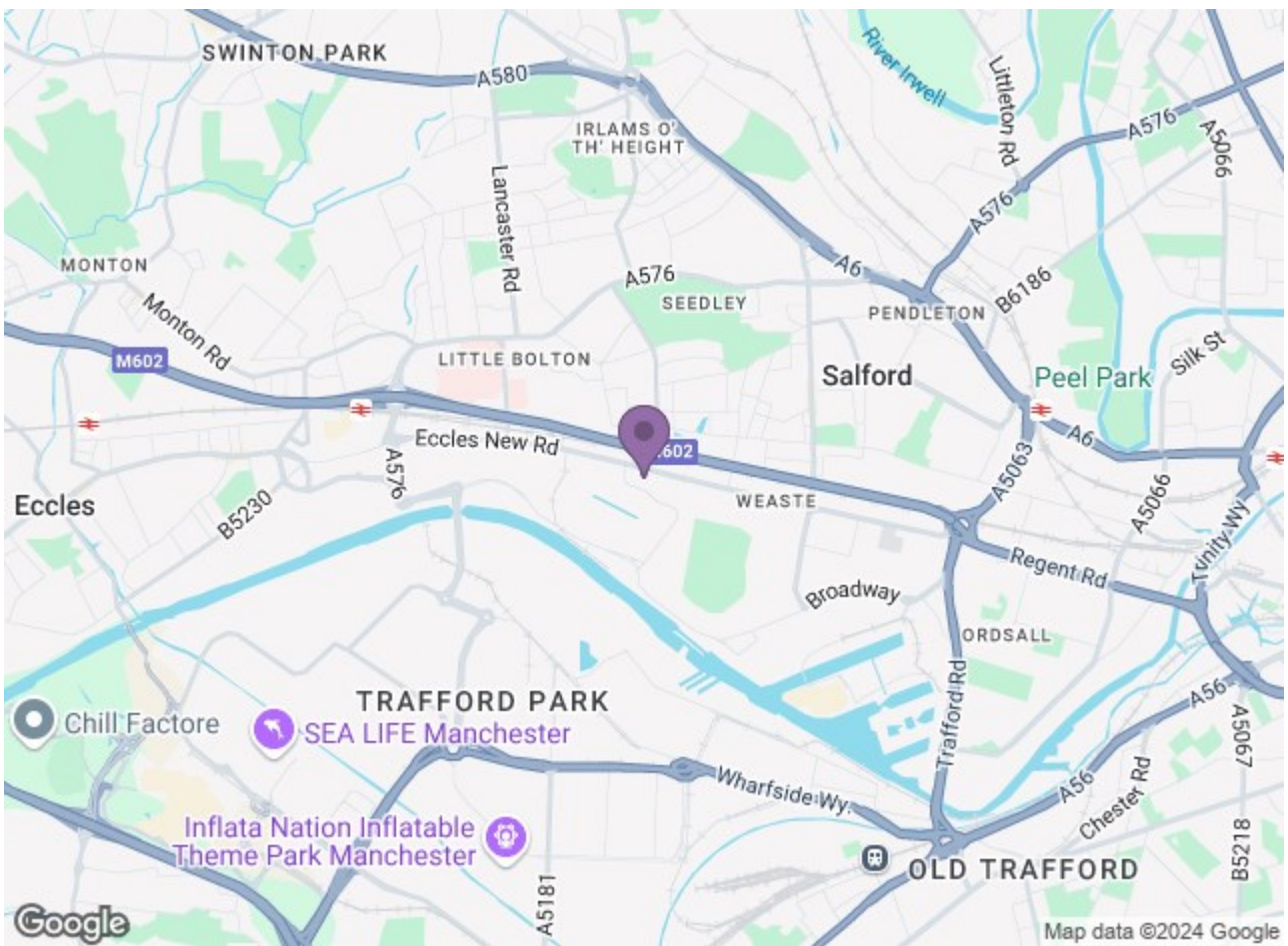

Energy Efficiency Rating		Environmental Impact (CO ₂) Rating	
Current	Potential	Current	Potential
G	B	F	D
72	60	73	74

England & Wales

Ascend
Built on higher standards