



NQ4, Bengal Street, Manchester

Price £210,000

**Ascend**  
Built on higher standards



## NQ4, Bengal Street, Manchester

**\*\*TWO Bedroom Apartment With Parking\*\***

Welcome to NQ4, Bengal Street, Manchester - a vibrant location that offers the best of city living! This stunning two-bedroom apartment is situated in a highly sought-after, well-established development, making it a prime choice for those looking for a modern urban lifestyle.

The property boasts a spacious reception room, perfect for entertaining guests or simply relaxing after a long day. With two cosy bedrooms, there's plenty of space for a small family, a couple, or even a home office.

The apartment features a sleek bathroom, adding a touch of luxury to your daily routine. Additionally, the secure allocated parking provides convenience and peace of mind for residents with vehicles.

Located close to the trendy Cutting Room Square, you'll have easy access to a variety of bars and famous eateries, perfect for enjoying evenings out with friends or family. Plus, with no onward chain, the process of making this apartment your own is smooth and hassle-free.

Whether you're looking for a savvy investment opportunity or searching for your first home, this property ticks all the boxes. Don't miss out on the chance to own a piece of



Please note that we have not tested any apparatus, equipment, fixtures, fittings or services, and so cannot verify they are in working order or fit for their purpose. Furthermore solicitors should confirm moveable items described in the sales particulars are, in fact, included in the sale since circumstances do change during marketing or negotiations. A final inspection prior to exchange of contracts is also recommended. Although we try to ensure accuracy, measurements used in this brochure may be approximate. Therefore if intending purchasers need accurate measurements to order carpeting or to ensure existing furniture will fit, they should take such measurements themselves.

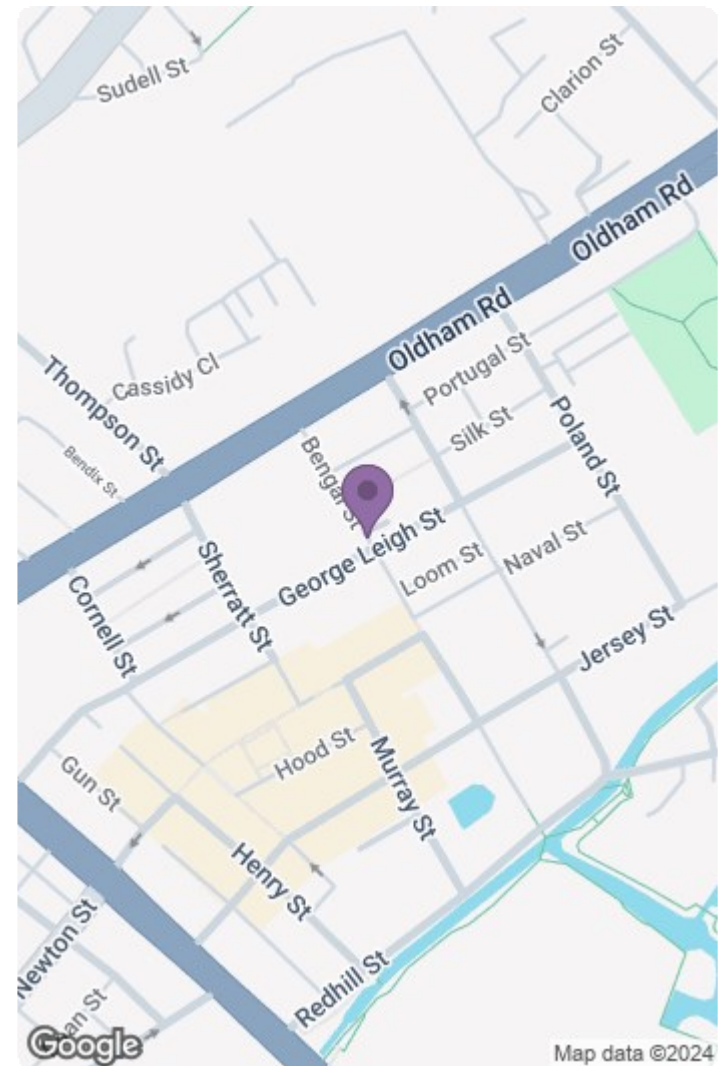
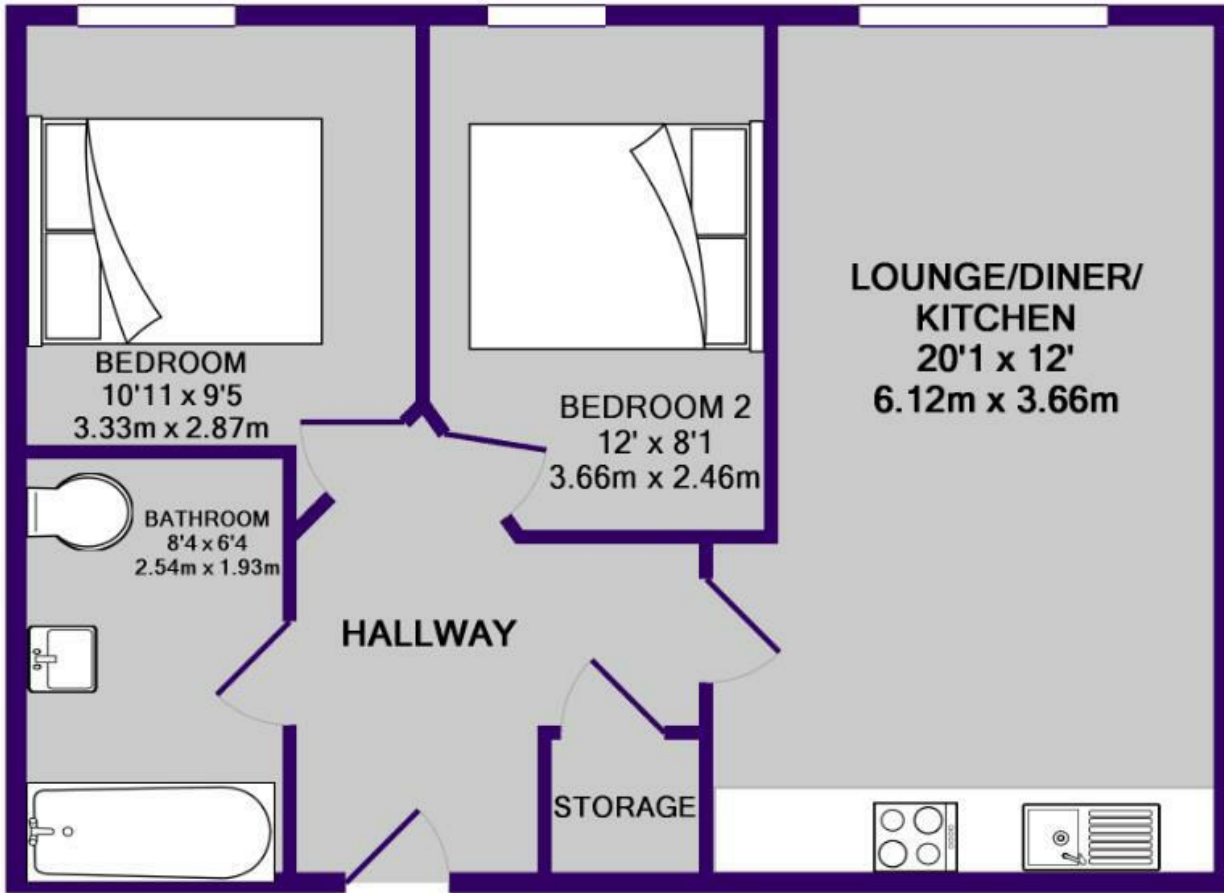

TOTAL APPROX. FLOOR AREA 562 SQ.FT. (52.2 SQ.M.)

Whilst every attempt has been made to ensure the accuracy of the floor plan contained here, measurements of doors, windows, rooms and any other items are approximate and no responsibility is taken for any error, omission, or mis-statement. This plan is for illustrative purposes only and should be used as such by any prospective purchaser. The services, systems and appliances shown have not been tested and no guarantee as to their operability or efficiency can be given

Made with Metropix ©2019

