

241 Deansgate, Manchester, Lancashire, M3 4EL

Tel: 0161 637 8336

Email: [contactus@ascendproperties.com](mailto:contactus@ascendproperties.com)

[www.ascendproperties.com](http://www.ascendproperties.com)

# Ascend

Built on higher standards



The Danube, City Road East, Manchester

Asking Price £180,000

\*CASH BUYERS & BUY TO LET INVESTORS ONLY - Tenanted until July 2024 at £1274pcm\*

Nestled between Castlefield and a short hop to Deansgate, these stunning apartments at The Danube blend a good splash of style with a natural homely comfort.

Kitted out with modern furnishings, this third floor apartment oozes unrivalled quality. The spacious open-plan kitchen/lounge is light and airy, and the benefit of two bathrooms - a master and an en-suite - is a major bonus. There really has been no stone left unturned whilst equipping this apartment with all the features that one has come to expect from Manchester city centre property.

The location couldn't be more perfect either. Just a hop, skip & a jump from Deansgate Metrolink, the Manchester world (and the surrounding area) is your oyster. The beating heart of Manchester is little but a minute stroll with the likes of Deansgate Locks, Spinningfields, Salford Quays and Castlefield all on your doorstep. The ring road is easily accessible, as are the canal boats; if floating through the city is more your thing. We wouldn't recommend swimming though.

What more can we say about this apartment, or Manchester for that matter? If you're looking for a beautiful apartment right in the thick of all the action, you really need to book a viewing and take a closer look. No amount of words or pictures can do this justice.





SECOND FLOOR  
588 sq.ft. (54.6 sq.m.) approx.

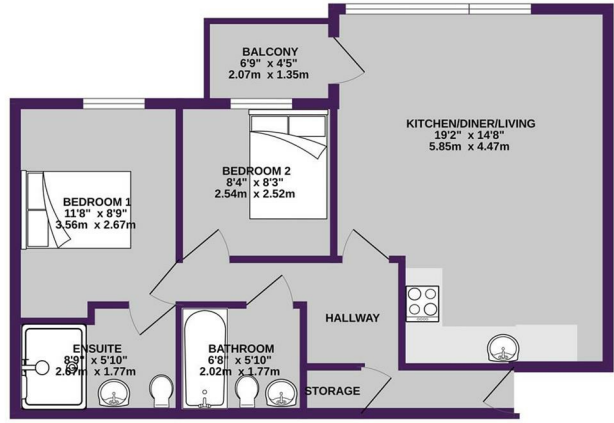

TOTAL FLOOR AREA: 588 sq.ft. (54.6 sq.m.) approx.  
While every attempt has been made to ensure the accuracy of the floorplan contained here, measurements of items, structures, views and angles given are approximate and should not be used as such for any prospective purchase. The services, fixtures and appliances shown have not been tested and no guarantee as to their operability or efficiency can be given.  
Made with SketchUp 2023

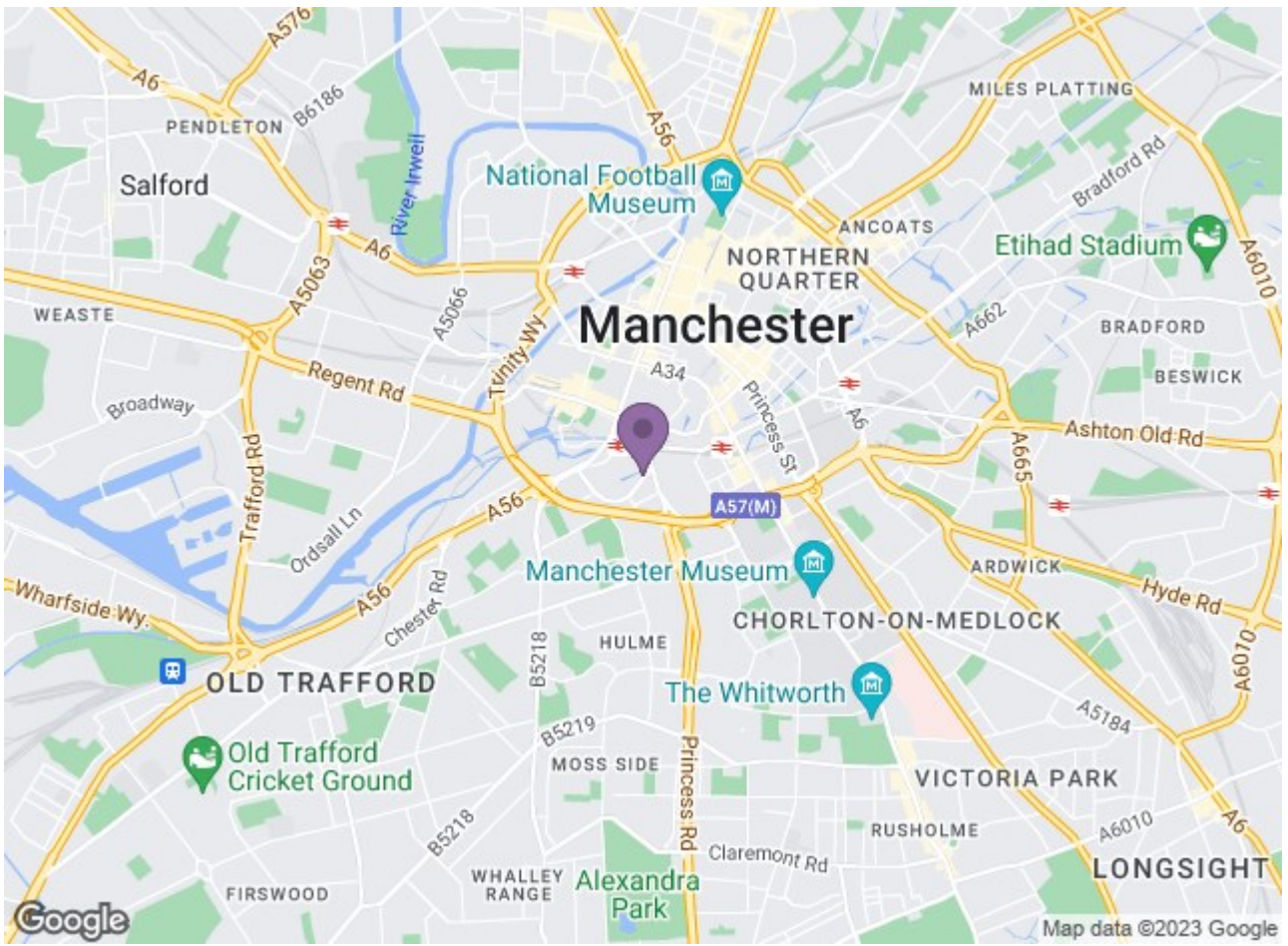

Energy Efficiency Rating		Environmental Impact (CO <sub>2</sub> ) Rating	
Current	Potential	Current	Potential
78	87	70	68