



Parkfields
Estates



Meadow Road, Southall, UB1 2JE

Asking Price £510,000



3



1



2



Floor Plan

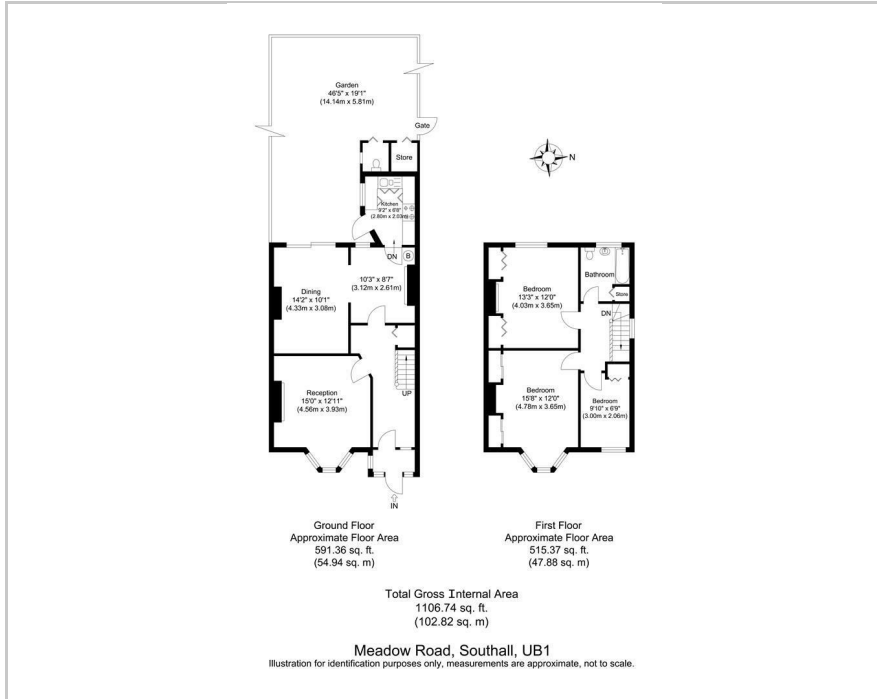

Area Map



Accommodation

- SPACIOUS END OF TERRACE
- POPULAR LOCATION JUST BY NORTH PRIMARY SCHOOL
- OVER 1100 SQFT
- THREE BEDROOMS
- TWO RECEPTIONS
- PLENTY OF SCOPE AND POTENTIAL TO EXTEND (STPP)
- WALKING DISTANCE TO LADY MARGARET ROAD
- ELIZABETH LINE WITHIN WALKING DISTANCE
- IDEAL FOR INVESTORS AND FIRST TIME BUYERS ALIKE

Viewing

Please contact our Southall Office on 0208 571 0253 if you wish to arrange a viewing appointment for this property or require further information.

Energy Efficiency Graph

Energy Efficiency Rating		Current	Potential
Very energy efficient - lower running costs			
(92 plus)	A		
(81-91)	B		
(69-80)	C		
(55-68)	D		
(39-54)	E		
(21-38)	F		
(1-20)	G		
Not energy efficient - higher running costs			
England & Wales		EU Directive 2002/91/EC	



These particulars, whilst believed to be accurate are set out as a general outline only for guidance and do not constitute any part of an offer or contract. Intending purchasers should not rely on them as statements of representation of fact, but must satisfy themselves by inspection or otherwise as to their accuracy. No person in this firm's employment has the authority to make or give any representation or warranty in respect of the property.