



**Parkfields**  
Estates

16 Biscoe Close, Hounslow, TW5 0UX

Asking Price £225,000



2



1



1



C



## Floor Plan

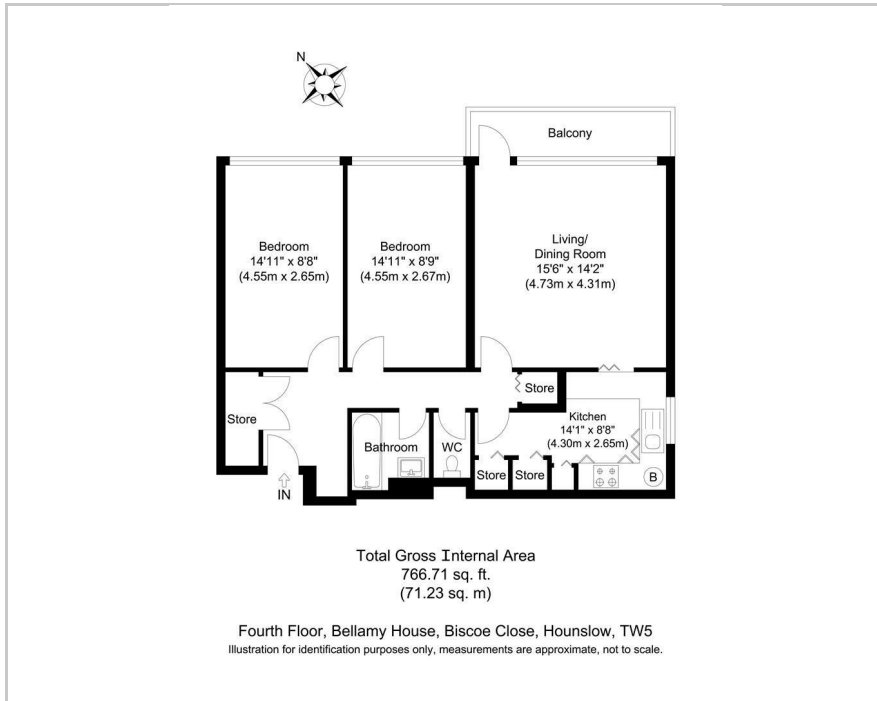

## Accommodation

- FOURTH FLOOR APARTMENT
- SUITABLE FOR CASH BUYERS ONLY
- TWO BEDROOMS
- LOUNGE
- KITCHEN
- OSTERLEY UNDERGROUND JUST 0.8 MILES AWAY
- VIEWS ACROSS LONDON
- IDEAL BUY TO LET WITH HIGH RETURN YIELD EXPECTED
- 90 YEAR LEASE
- NO CHAIN



## Viewing

Please contact our Southall Office on 0208 571 0253 if you wish to arrange a viewing appointment for this property or require further information.



## Area Map

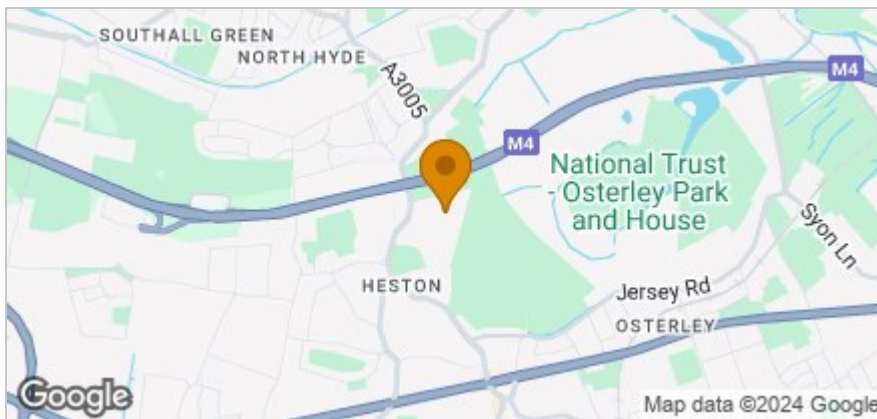

## Energy Efficiency Graph

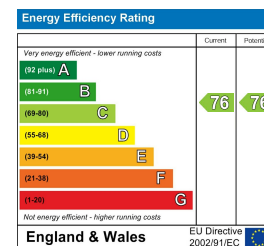

These particulars, whilst believed to be accurate are set out as a general outline only for guidance and do not constitute any part of an offer or contract. Intending purchasers should not rely on them as statements of representation of fact, but must satisfy themselves by inspection or otherwise as to their accuracy. No person in this firm's employment has the authority to make or give any representation or warranty in respect of the property.