



£2,500 pcm

Southway | Guildford

AVAILABLE FOR STUDENTS FOR THIS ACADEMIC YEAR *VIDEO TOUR AVAILABLE* *COVID SAFE PHYSICAL VIEWINGS AVAILABLE*

Cobbles are excited to bring the market this stunningly finished Five bedroom house, perfect for a family or professional sharers.

The ground floor comprises of a lounge/bedroom, spacious kitchen diner, newly fitted shower room.

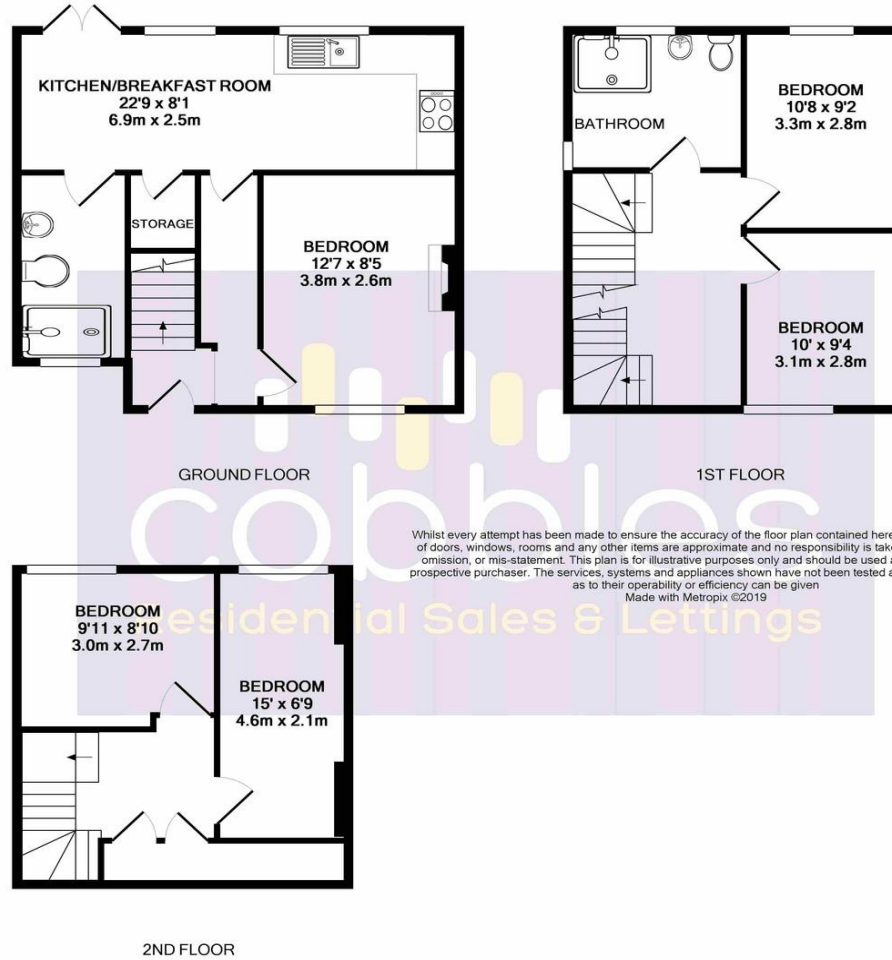
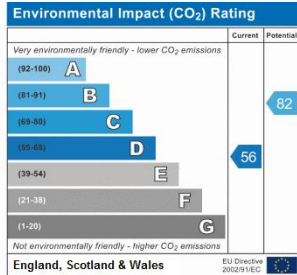
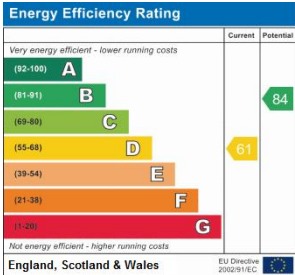

- Five Bedrooms
- Two Bathrooms
- Spacious Lounge/Diner
- Off Street Parking
- Private Rear Garden
- EPC Rating D