



£1,495 pcm

School Meadow | Guildford

Cobbles are pleased to bring to market this spacious two-bedroom property situated within the popular School Meadow development. The flat is located on the ground floor, and benefits from an allocated parking space as well as a Juliet balcony.

The property comprises a great sized family bathroom and two double bedrooms. The master bedroom also has the added benefit of an en-suite shower room.



Score	Energy rating	Current	Potential
92+	A		
81-91	B		82 B
69-80	C	79 C	
55-68	D		
39-54	E		
21-38	F		
1-20	G		

GROUND FLOOR
667 sq.ft. (62.0 sq.m.) approx.

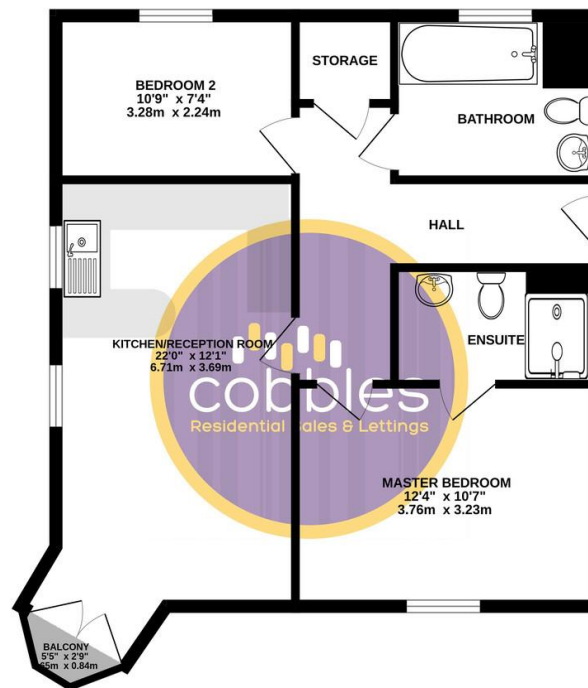

TOTAL FLOOR AREA: 667 sq.ft. (62.0 sq.m.) approx.
Whilst every attempt has been made to ensure the accuracy of the floorplan contained herein, measurements of doors, windows, rooms and any other items are approximate and no responsibility is taken for any error, omission or mis-statement. This plan is for illustrative purposes only and should be used as such by any prospective purchaser. The services, systems and appliances shown have not been tested and no guarantee as to their operability or efficiency can be given.
Made with Metroplex 02/2021

- Two Bedroom Flat
- Off Road Parking
- EPC Rating - C
- Balcony
- Unfurnished
- Council Tax Band - C