



Asking Price Of

**£450,000**

## Penny Drive | Guildford

### Freehold

Located in the highly desirable, Wood street village, this well-presented four-bedroom mid-terrace home offers the perfect blend of space, practicality, and versatility. With off-street parking and a separate external outhouse/office.



Score	Energy rating	Current	Potential
92+	A		94 A
81-91	B		
69-80	C	80 C	
55-68	D		
39-54	E		
21-38	F		
1-20	G		

GROUND FLOOR  
526 sq.ft. (48.9 sq.m.) approx.

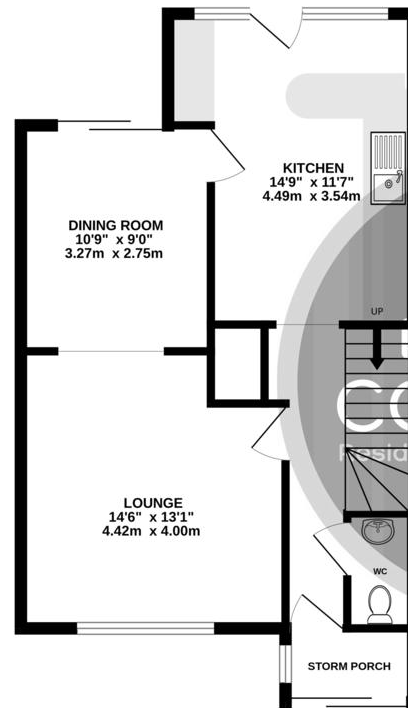

1ST FLOOR  
443 sq.ft. (41.2 sq.m.) approx.

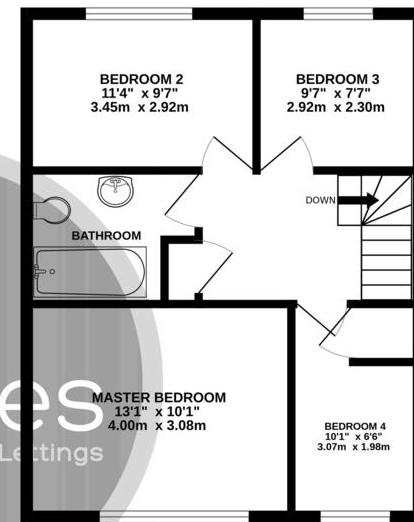

TOTAL FLOOR AREA: 969 sq.ft. (90.1 sq.m.) approx.

- Four Bedroom House
- Private Garden
- Council Tax Band - D
- Off Road Parking
- Large Lounge
- EPC Rating - TBC

18/05/2025