



£6,000 pcm

Whitmoor Lane | Guildford

This beautiful farmhouse is set in Sutton Green with a beautiful outlook. The accommodation comprises of an entrance hall leading to the living room, drawing room, dining room, large kitchen/breakfast room with a fitted Aga.

The master bedroom is a fantastic space set over two floors with 2 en-suite bathroom a terrace and access to a gym. There are four further bedrooms and two further bathrooms, one of which is an en-suite.

The property has character features throughout and is truly unique



Score	Energy rating	Current	Potential
92+	A		
81-91	B		
69-80	C		
55-68	D		63 D
39-54	E		
21-38	F	37 F	
1-20	G		

GROUND FLOOR 2162 sq.ft. (200.9 sq.m.) approx.

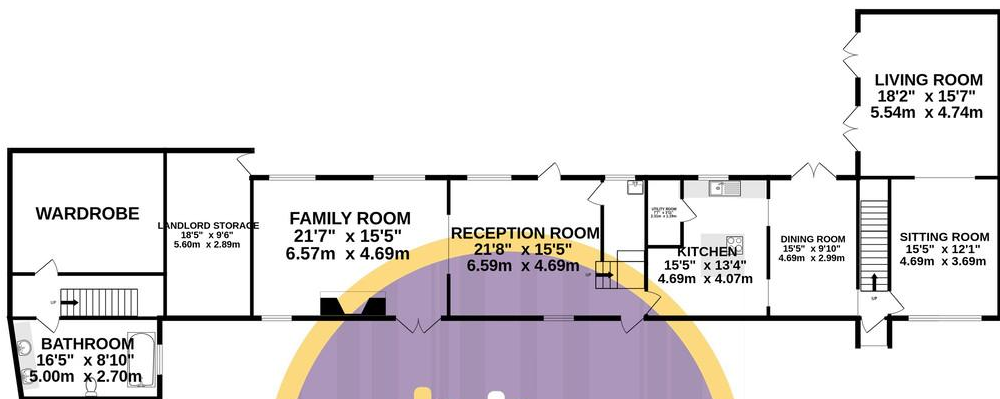

1ST FLOOR 1696 sq.ft. (157.5 sq.m.) approx.

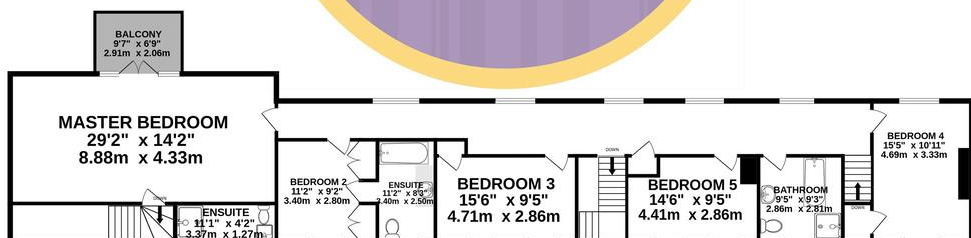

- Five Bedrooms
- Two Reception Rooms
- Council Tax Band - H
- Three En-Suites
- Swimming Pool
- EPC Rating - F