



£875 pcm

York Road | Guildford

Located in the highly desirable York Road this wonderful studio apartment is perfect for those looking to take advantage of the amenities Guildford town centre has to offer, or those who commute into London. The property consists of an entrance hall leading directly to the open spaced lounge/ bedroom which the current tenant has utilised to combine a desk to allow the ability to work from home.

Further benefits of the property is the ability for road parking with permit obtainable from the council.

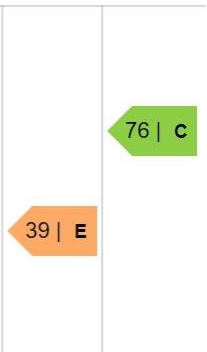
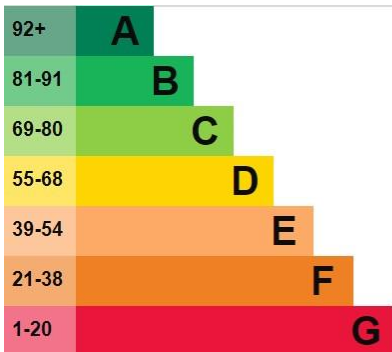

GROUND FLOOR
514 sq.ft. (47.7 sq.m.) approx.

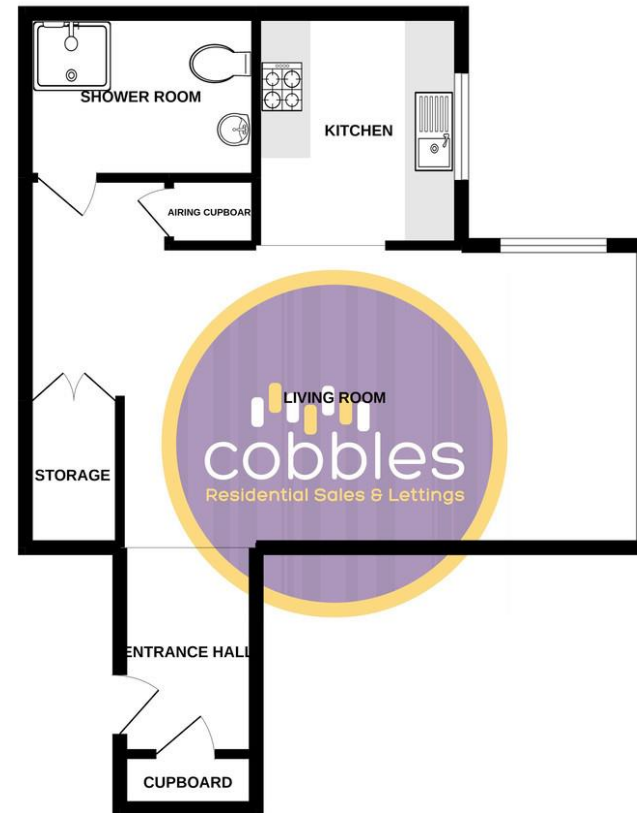

- Studio Apartment
- Ground Floor
- Council Tax Band B
- Town Centre Location
- Modern Bathroom
- EPC Rating - E