

18 Old Oak Common Lane
Acton
London
W3 7EL
T: 020 8749 9798
E: sales@churchillmathesons.com
www.churchillmathesons.com

Churchill & Mathesons

Sundew Avenue, London, W12 0RT

Asking Price £950,000 Freehold



KEY FEATURES:

- LICENCED HMO
- INCOME £5350PM
- LOW MAINTENANCE
- PERFECTLY LOCATED
- SUBURBAN
- 6 BEDROOMS
- 4 BATHROOMS
- WC

CALLING HMO INVESTORS THIS WILL SELL FAST

Churchill & Mathesons is proud to present this amazing FREEHOLD end terrace home in a great location comprising wooden floors and low maintenance paved gardens.

Income pm: £5350.00 fully let

Ground Floor 1 x 1 Bed flat private entrance, small kitchenette, shower room & toilet with a private garden, 1 x Studio flat house access, with shower room & toilet and a well appointed kitchen leading out onto a garden with a garden shed.

1st Floor 3 x Double rooms, 2 shower rooms and a separate kitchen.

Loft: 1 x Single room

Centrally located, close to stations, busses, Lidl Supermarket, shops, restaurants and parks.

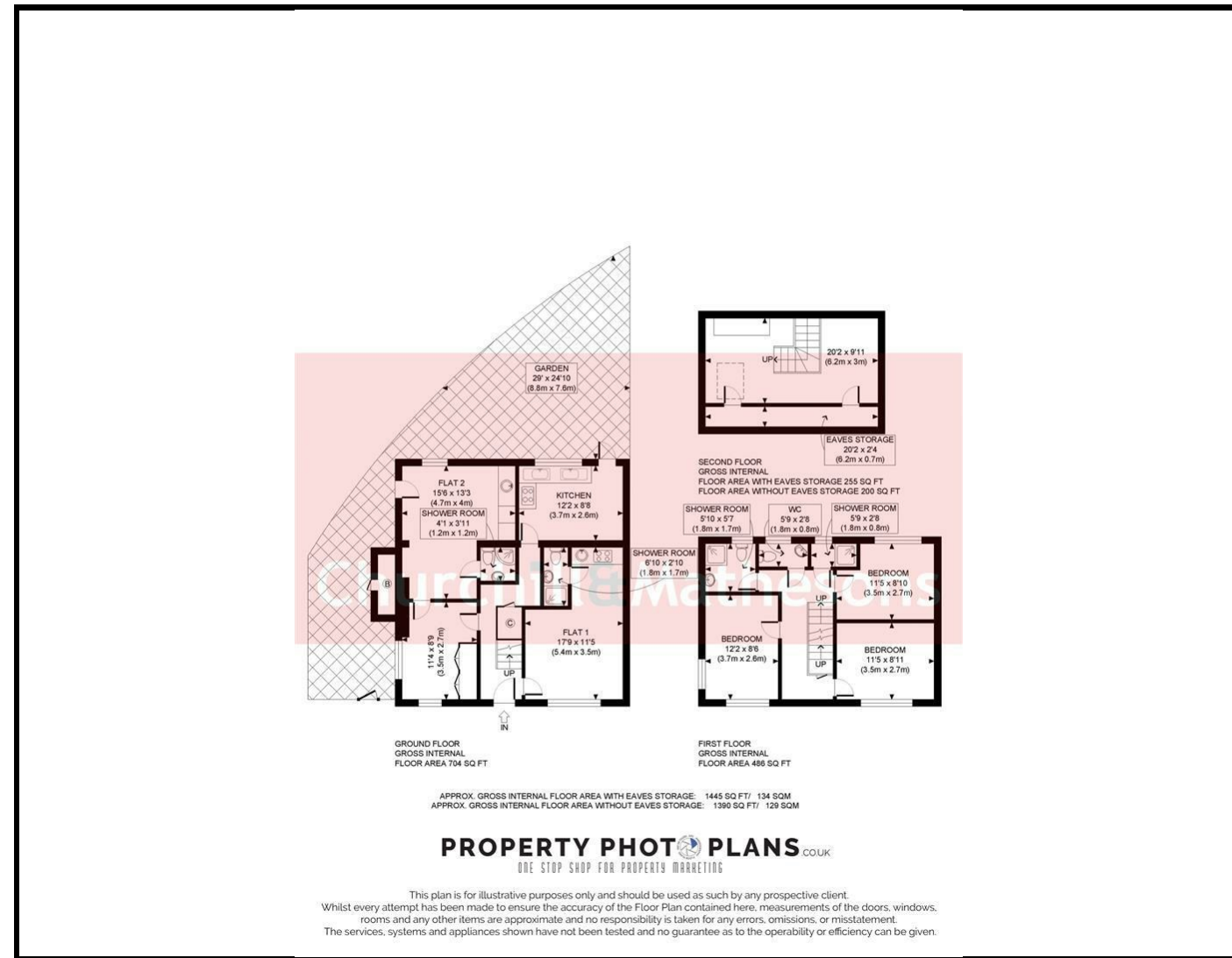

Energy Efficiency Rating		
	Current	Potential
Very energy efficient - lower running costs		
(92 plus) A		
(81-91) B		83
(69-80) C	70	
(55-68) D		
(39-54) E		
(21-38) F		
(1-20) G		
Not energy efficient - higher running costs		
England & Wales	EU Directive 2002/91/EC	

Environmental Impact (CO ₂) Rating		
	Current	Potential
Very environmentally friendly - lower CO ₂ emissions		
(92 plus) A		
(81-91) B		
(69-80) C		
(55-68) D		
(39-54) E		
(21-38) F		
(1-20) G		
Not environmentally friendly - higher CO ₂ emissions		
England & Wales	EU Directive 2002/91/EC	

Whilst every effort is made to give a fair description, the accuracy of these particulars is not guaranteed, neither do they constitute an offer or contract.

CHURCHILL & MATHESONS ESTATE AGENTS have not tested any apparatus, equipment, fitting or services and so cannot verify that they are in working order. The buyer is advised to obtain verification from their solicitor or surveyor. Measurements are correct to within +/-6 A sonic tape is used. None of the statements contained in these particulars or any of our properties are to be relied upon as a representation of fact.