



Beechwood Grove, London, W3 7HY

Asking Price £210,000 Leasehold



KEY FEATURES:

- 24-HOUR ALARM CALL SERVICE
- GUEST SUITE FOR VISITORS
- QUITE, BRIGHT AND SUNNY
- VISITOR PARKING
- LIFT
- CONSERVATORY SHARED BY ALL RESIDENTS
- SHARED LOUNGE
- A SHARED LAUNDRY
- MANAGEMENT OFFICE

LARGE FF 1 BEDROOM FLAT FOR OVER 55s

Churchill & Mathesons is proud to present this rare find for people over 55 years of age. Located close to all amenities, Lidl, bus and train routes. A quite well managed block with a in house management office, a lift and large communal lounge/library and garden This 500sqft flat at the rear of the building away from traffic has a good size west facing living room and double bedroom with large windows looking over the tranquil wooded well-maintained garden. The well-appointed kitchen opens onto the living room has plenty of cupboards. 1 DESIGNATED PARKING

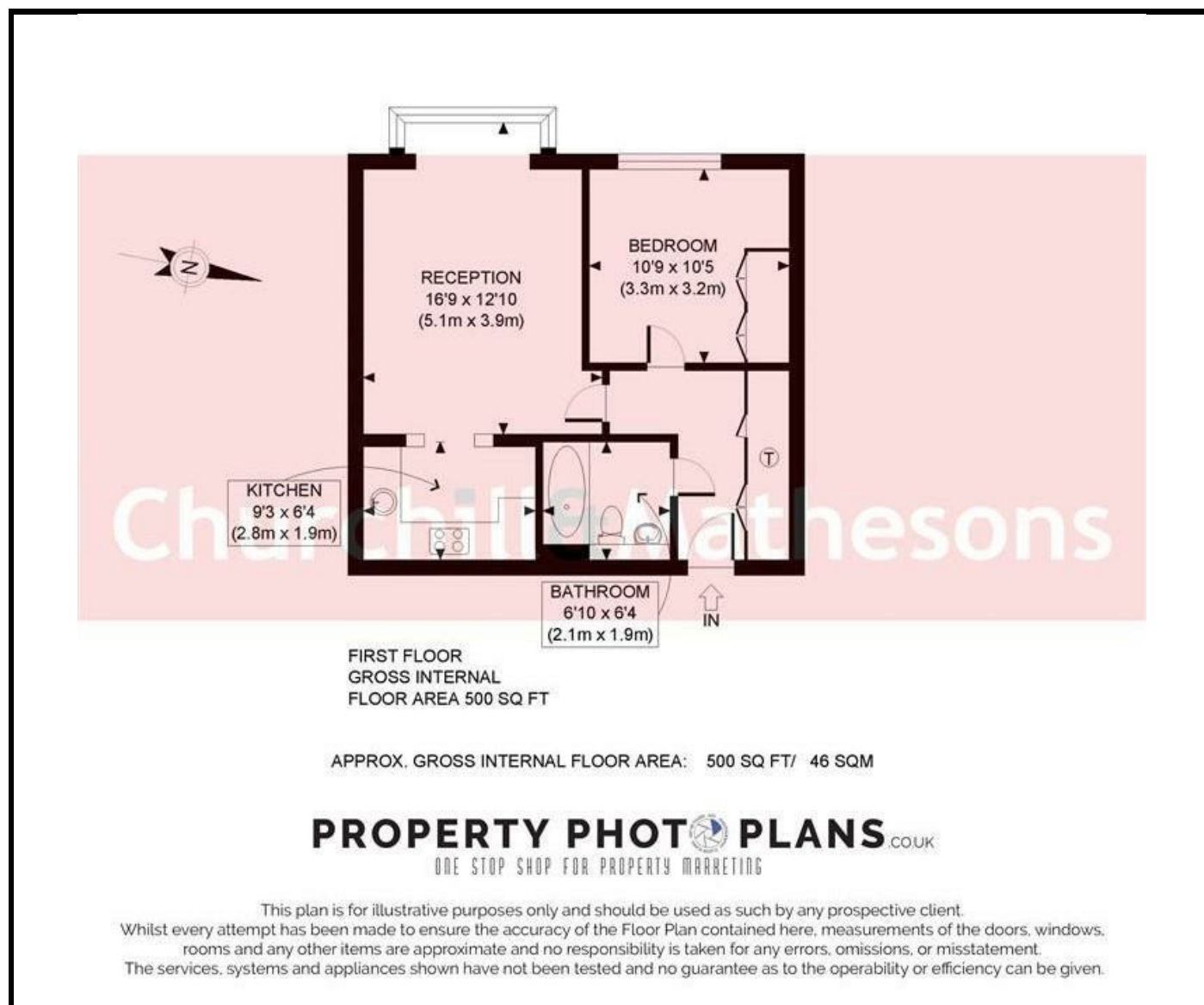

Energy Efficiency Rating		
	Current	Potential
Very energy efficient - lower running costs		
(92 plus) A		
(81-91) B		82
(69-80) C	68	
(55-68) D		
(39-54) E		
(21-38) F		
(1-20) G		
Not energy efficient - higher running costs		
England & Wales	EU Directive 2002/91/EC	

Environmental Impact (CO ₂) Rating		
	Current	Potential
Very environmentally friendly - lower CO ₂ emissions		
(92 plus) A		
(81-91) B		
(69-80) C		
(55-68) D		
(39-54) E		
(21-38) F		
(1-20) G		
Not environmentally friendly - higher CO ₂ emissions		
England & Wales	EU Directive 2002/91/EC	



Whilst every effort is made to give a fair description, the accuracy of these particulars is not guaranteed, neither do they constitute an offer or contract.

CHURCHILL & MATHESONS ESTATE AGENTS have not tested any apparatus, equipment, fitting or services and so cannot verify that they are in working order. The buyer is advised to obtain verification from their solicitor or surveyor. Measurements are correct to within +/- 6 A sonic tape is used. None of the statements contained in these particulars or any of our properties are to be relied upon as a representation of fact.