

Buy. Sell. Rent. Let.

lovelle



6 Chedworth Road, Lincoln LN2 4SL



When it comes to
property it must be

lovelle



£ 159,995



Two bedroom home in Glebe Park Area with lounge, modern kitchen, private garden, large driveway. Ideal for first time buyers or investors. *CLICK ON OUR INTERACTIVE VIRTUAL 360 TOUR*

Key Features

- 2-bedroom semi-detached home
- Lounge and modern kitchen downstairs
- Private rear garden
- Ample parking space
- Two bedrooms and a bathroom upstairs
- Ideal for first-time buyers or investment opportunity
- EPC rating D
- Tenure: Freehold
- Council Tax Band : A



Welcome to your new home on Chedworth Road! This inviting semi-detached property offers a comfortable lounge and a modern kitchen downstairs, providing ample space for relaxation. The private garden at the rear is perfect for enjoying outdoor activities, complemented by a convenient driveway for hassle-free parking.

Upstairs, two bedrooms with a well-equipped bathroom completes the upper level.

Nestled in the desirable Glebe Park neighborhood, this home grants easy access to local amenities, schools, and transportation options, making it an excellent choice for both first-time buyers and savvy investors looking to secure a promising asset in a sought-after location.

Agent Notes

These particulars are for guidance only. Lovelle Estate Agency, their clients and any joint agents give notice that:-

They have no authority to give or make representation/warranties regarding the property, or comment on the SERVICES, TENURE and RIGHT OF WAY of any property.

These particulars do not form part of any contract and must not be relied upon as statements or representation of fact.

All measurements/areas are approximate. The particulars including photographs and plans are for guidance only and are not necessarily comprehensive.



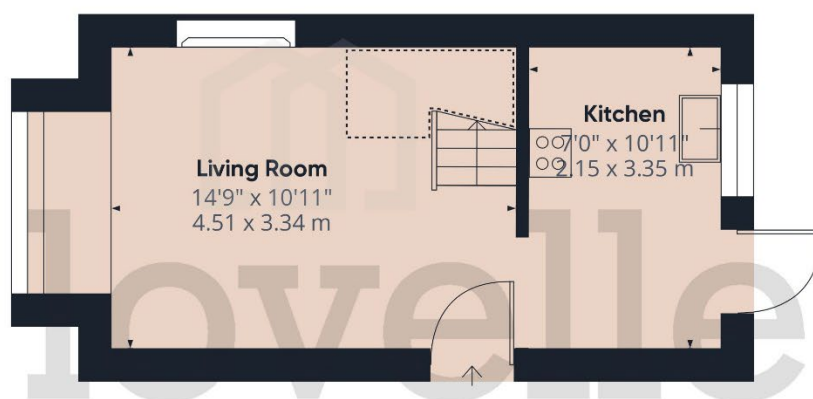

Ground Floor

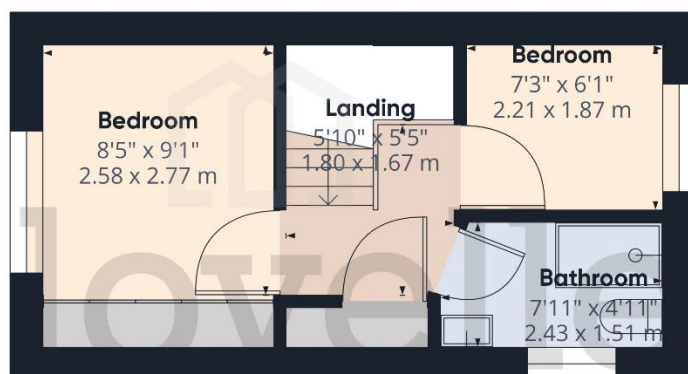

Floor 1

Approximate total area⁽¹⁾

472.27 ft²
43.87 m²

Reduced headroom

19.02 ft²
1.77 m²

(1) Excluding balconies and terraces

☒ Reduced headroom
(below 1.5m/4.92ft)

While every attempt has been made to ensure accuracy, all measurements are approximate, not to scale. This floor plan is for illustrative purposes only.

GIRAFFE360

When it comes to **property**
it must be