

Buy. Sell. Rent. Let.

lovelle



Waterloo Street, Market Rasen



When it comes to
property it must b

lovelle



£95,000



TERRACED HOUSE IN TOWN CENTRE LOCATION. In Need of modernisation, this excellent mid terrace offers an excellent opportunity for an investor or a first time buyer. Comprising lounge, kitchen diner, 2 bedrooms and shower room.

NO ONWARD CHAIN

Key Features

- Terraced House
- Town Centre Location
- Close to Local Amenities
- In Need of Modernisation
- Lounge, Kitchen Diner
- 2 Bedrooms, Shower Room
- EPC rating TBC
- Tenure: Freehold



lovelle



lovelle



lovelle



lovelle



lovelle



lovelle



lovelle

Situation

Market Rasen town is popular with walkers and there are great routes and trails just five minutes stroll from the town centre. You can also head out to Willingham Woods where there are numerous trails and paths for all ages and abilities.

In the town centre you will find traditional and long-standing family run shops including ironmongers, butchers, menswear confectionery, bakery & fruit & veg. The town boasts high-quality and award winning places to eat for all budgets.

Market Rasen is approximately 16 miles from Lincoln City and 15 miles from the market town of Louth. There are regular bus and train services.

Lounge

3.34m x 3.64m (11'0" x 11'11")

uPVC front entrance door, double glazed window to front aspect and feature fire place

Hallway

0.81m x 0.92m (2'8" x 3'0")

stairs to first floor accommodation

Kitchen Diner

3.19m x 3.67m (10'6" x 12'0")

a range of fitted wall and base units, space for under counter fridge, space for cooker, stainless steel sink unit, space and plumbing for washing machine, tiled splash backs, laminate flooring, 2 pantry cupboards, double glazed window to rear aspect and uPVC entrance door

Landing

0.90m x 2.09m (3'0" x 6'11")

Bedroom 1

3.38m x 3.66m (11'1" x 12'0")

double glazed window to front aspect, fitted storage and feature fire

Bedroom 2

2.24m x 2.10m (7'4" x 6'11")

double glazed window to rear aspect

Shower Room

3.19m x 1.57m (10'6" x 5'2")

3 piece suite comprising low level WC, vanity hand wash basin, shower cubicle, tiled splash backs, vinyl flooring, heated towel rail and double glazed window to rear aspect

Oubuildings

brick built outbuildings providing good storage

Agents Notes

These particulars are for guidance only. Lovelle Estate Agency, their clients and any joint agents give notice that:- They have no authority to give or make representation/warranties regarding the property, or comment on the SERVICES, TENURE and RIGHT OF WAY of any property.

These particulars do not form part of any contract and must not be relied upon as statements or representation of fact. All measurements/areas are approximate. The particulars including photographs and plans are for guidance only and are not necessarily comprehensive.

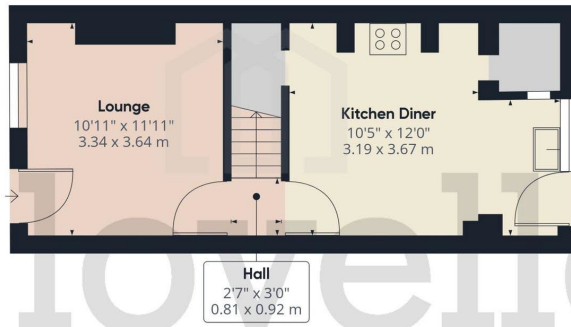

Ground Floor

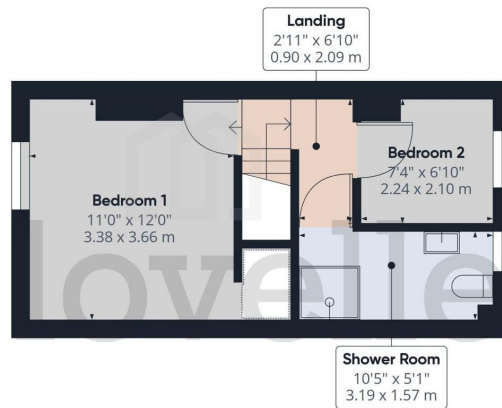

Approximate total area⁽¹⁾
589.67 ft²
54.78 m²

(1) Excluding balconies and terraces

While every attempt has been made to ensure accuracy, all measurements are approximate, not to scale. This floor plan is for illustrative purposes only.



When it comes to **property**
it must be

lovelle

01673 844069

marketrasen@lovelle.co.uk