



KALMARs

Denmark Hill, London, SE5
STUDIO FLAT



Denmark Hill, London, SE5

£275,000

Description

A delightful studio flat set on the first floor of this period property. The accommodation which is presented to the market in good decorative condition enjoys a 15'5 studio room, 8'1 contemporary fitted kitchen, modern fitted bathroom and an 8'3 storage room.

The property is situated in the heart of Camberwell town center with its array of shops, restaurants and transport links with Denmark Hill Station (0.4 miles) and Loughborough Junction (1 mile) and local bus routes.

The vendors have informed us that the current service charge is £1,000 PA GR £125 PA and the lease is in the region of 112 years.

EPC Rating - C





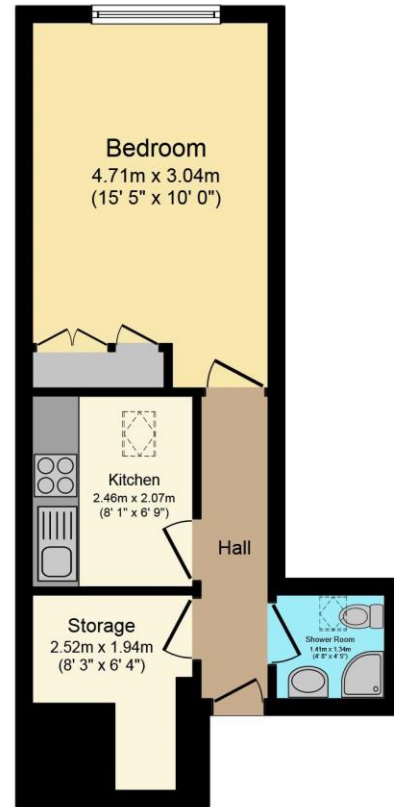

Second Floor

Total floor area 31.0 sq. m. (334 sq. ft.) approx

This floor plan is for illustrative purposes only. It is not drawn to scale. Any measurements, floor areas (including any total floor area), openings and orientation are approximate. No details are guaranteed, they cannot be relied upon for any purpose and they do not form part of any agreement. No liability is taken for any error, omission or misstatement. A party must rely upon its own inspection(s). Plan produced for Purple Bricks. Powered by www.focalagent.com

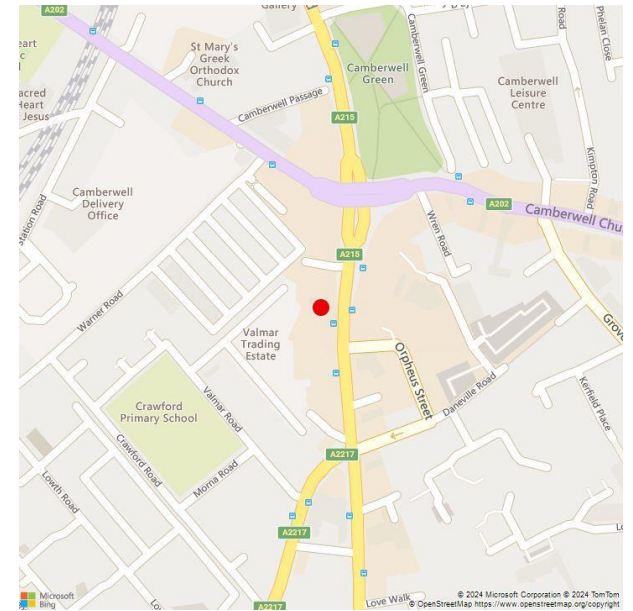

Error! Filename not specified.

KALMARS

Jamaica Wharf, 2 Shad Thames, London, SE1 2YU
T 0207 940 7980
E info@kalmars.com

IMPORTANT: we would like to inform prospective purchasers that these sales particulars have been prepared as a general guide only. A detailed survey has not been carried out, nor the services, appliances and fittings tested. Room sizes should not be relied upon for furnishing purposes and are approximate. If floor plans are included, they are for guidance only and illustration purposes only and may not be to scale. If there are any important matters likely to affect your decision to buy, please contact us before viewing the property.