



KALMARs

Neckinger Estate, London, SE16
2 Bedroom FLAT



Neckinger Estate, London, SE16

Leasehold £400,000

Description

Guide Price £400,000 to £425,000.

This property located on the Neckinger Estate, South East London, Bermondsey, is approximately 592 Sq Ft and comprises; Two-Bedrooms, One-Bathroom, One-reception Room and Kitchen.

There is a communal area enhancing social interaction, a designated parking space and a number of bars, restaurants and shops within 0.5 miles.

The nearest station is Bermondsey Station and is just 0.7 miles away

Service charge - £1,683.90 per year

EPC Rating – C

90 Years remaining on the leasehold.





Neckinger Estate, SE16 3QG

Approx. Gross Internal Area 592 Sq Ft - 55.00 Sq M

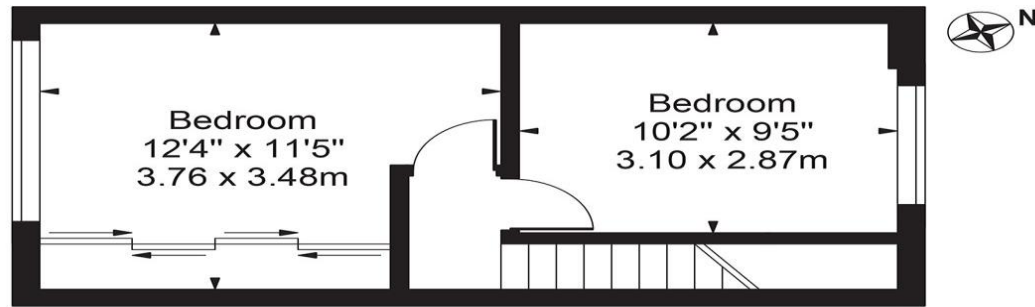

Third Floor



Second Floor

For Illustration Purposes Only - Not To Scale - Floor Plan by interDesign Photography
www.interdesignphotography.com

This floor plan should be used as general outline for guidance only.
All measurements are approximate and for illustration purposes only as defined by the RICS Code of Measuring Practice ©2016.

KALMARS

Jamaica Wharf, 2 Shad Thames, London, SE1 2YU

T 0207 940 7980

E info@kalmars.com

IMPORTANT: we would like to inform prospective purchasers that these sales particulars have been prepared as a general guide only. A detailed survey has not been carried out, nor the services, appliances and fittings tested. Room sizes should not be relied upon for furnishing purposes and are approximate. If floor plans are included, they are for guidance only and illustration purposes only and may not be to scale. If there are any important matters likely to affect your decision to buy, please contact us before viewing the property.