



Long View, Bath Road, Tetbury, Gloucestershire, GL8 8EE

Individual detached house
 Family-sized configuration
 Updated kitchen
 4 bedrooms
 Excellent reception space
 Ample private parking and garage
 Good-sized rear garden
 Within walking distance of the town centre
 No onward chain



01666 840 886
 jamespyle.co.uk



The Barn, Swan Barton, Sherston, Wiltshire, SN16 0LJ
 James Pyle Ltd trading as James Pyle & Co. Registered in England & Wales No: 08184953

Price Guide: £795,000

Approximately 1,435 sq.ft excluding garage

‘Positioned just half a mile outside of the town centre, this individual detached house offers great family-sized accommodation with a larger than average garden, ample private parking and a garage’



The Property

Long View is an individual detached modern house situated towards the edge of Tetbury and less than half a mile from the town centre. The property has been recently updated with new carpets and a stylish refitted kitchen whilst the accommodation presents as a blank canvas for the next owners to put their stamp on it. Internally, the accommodation extends to around 1,435 sq.ft with a detached single garage externally.

The ground floor opens to a front entrance hall with a WC off. There is excellent reception space comprising a large living/family room and separate a dining room, both featuring fireplaces at the focal point. The newly updated kitchen is equipped with an integrated fridge/freezer, oven and hob, and leads to a rear conservatory overlooking the garden.

Upstairs, there are four bedrooms and a family bathroom.

Externally, Long View benefits from ample private parking at the front in addition to the garage. The rear garden is also larger than average and is fully enclosed. A patio terrace is positioned to the side of the conservatory and a good-sized lawn is divided by paved paths beside a gravelled area with raised timber beds.

Situation

Tetbury is a thriving historic Cotswold market town with much of it dating back to the 17th and 18th Centuries. The town has a broad range of shops and amenities for everyday needs as well as a number of quality antique shops, excellent hotels, restaurants and cafes within the town centre. Further everyday needs include a large supermarket, hospital, surgeries and

post office whilst there are also excellent schools catering for all ages. Voted by Country Life magazine recently as the third most desirable town in the country, Tetbury is situated within an Area of Outstanding Natural Beauty and is surrounded by delightful Cotswold Countryside where there are ample opportunities for walking. Conveniently located less than half an hour from both the M4 and M5 motorway, Tetbury is within easy reach of Cirencester, Cheltenham, Bath, Bristol and Swindon. Close by is the beautiful Forest Commission run Westonbirt Arboretum and King Charles' Highgrove Estate. There is good access to nearby Kemble Railway Station which provides regular fast services to London and other regional centres.

Additional Information

The property is Freehold with oil-fired central heating, mains water, electrics and

drainage. The property is located within the Cotswold Area of Outstanding Natural Beauty. Superfast broadband is available and there is good mobile phone coverage with some limitations. Information taken from the Ofcom mobile and broadband checker website, please check the website for more information. Cotswold District Council Tax Band F.

Directions

From the centre of Tetbury, follow Church Street onto Bath Road across the bridge to leave the town. Locate the property on the right hand side after the turning to Berrells Road.

Postcode GL8 8EE

What3words: ///treaty.existence.royal



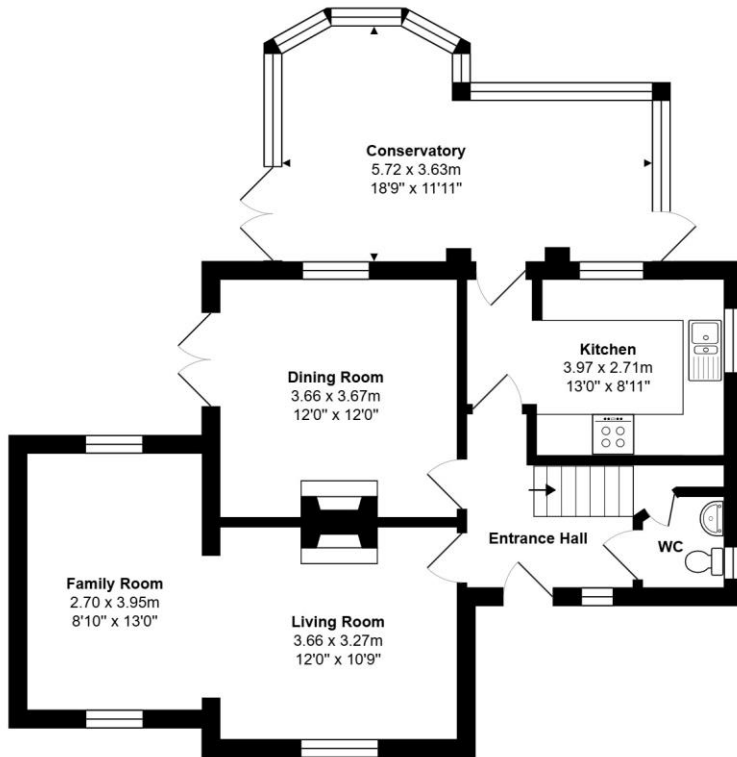

Ground Floor

Total Area: 133.3 m² ... 1435 ft² (excluding garage)

All measurements are approximate and for display purposes only

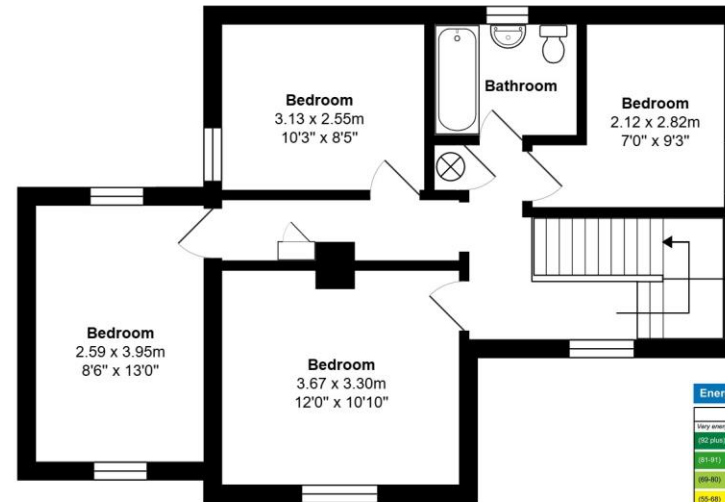

First Floor

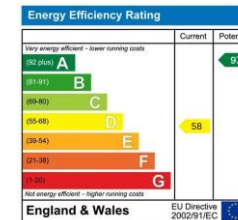

James Pyle Holdings Ltd and any parties they are acting for hereby give notice that these details are for guidance only and cannot guarantee accuracy of any description, dimension, condition or any required permission for occupation and use. It is not company policy to test any services or appliances in properties offered for sale and these should be verified by the purchaser's solicitors. James Pyle Holdings Ltd will not be liable for any loss arising from the use of these details. No responsibility is taken for any errors, omissions or misstatements within these particulars. It should not be assumed that the property has all the necessary planning, building regulation or other consents. These particulars do not form any part of any offer or contract and must not be relied upon as statements or representations of fact. James Pyle & Co is a trading name of James Pyle Holdings Ltd, registered in England & Wales. Registered number 10927906

COTSWOLD & COUNTY (HEAD OFFICE)

The Barn, Swan Barton, Sherston SN16 0LJ

01666 840 886 or 01452 812 054

LONDON (ASSOCIATE OFFICE)

121 Park Lane, Mayfair W1k 7AG

0207 0791 577