



Crossfell, Wilnecote Tamworth





## Property Description

This attractive, ideal first buy or investment offers a very well presented front garden on approach leading on to the entrance hall which has stairs up to the first floor and doors leading on to the spacious and well decorated lounge as well as the bright and well appointed kitchen.

Upstairs all bedrooms are good sizes and the bathroom is well presented. Moving out to the rear garden, buyers have a real treat with this well designed and presented low maintenance space ideal for those who like to enjoy outside space without dedicating too much time to gardening.

Locally, the home couldn't be better placed for amenities. There are schools in walking distance along with shops and other services such as a GP surgery close by, too.

## Entrance Hallway

Stairs to first floor accommodation, under stairs storage cupboard and further storage cupboard.

## Guest W.C

Double glazed window to front elevation, W.C, wash hand basin, cladded walls and ceiling.

## Lounge

17' 7" x 10' 4" ( 5.36m x 3.15m )  
Double glazed window to rear elevation and central heating radiator.

## Kitchen/ Diner

15' 8" x 11' 5" max ( 4.78m x 3.48m max )  
Double glazed window to rear elevation, door to rear elevation, a range of wall and base units with work surface over incorporating a sink with drainer unit, oven and hob, space and plumbing for washing machine, space for fridge freezer and central heating radiator.

## Landing

Double glazed window to front elevation, air conditioning and loft access via hatch.

## Bedroom One

14' 9" x 9' 1" ( 4.50m x 2.77m )

Double glazed window to rear elevation and central heating radiator.

## Bedroom Two

10' 7" x 11' 2" ( 3.23m x 3.40m )

Double glazed window to rear elevation and central heating radiator.

## Bedroom Three

11' 2" x 6' 4" ( 3.40m x 1.93m )

Double glazed window to rear elevation and central heating radiator.

## Bathroom

Double glazed window to front elevation, shower cubicle, W.C, wash hand basin and cladded ceiling.

## Front Garden

Decorative lawn with fencing to boundaries.

## Rear Garden

Raised decking area, laid to lawn, storage shed and fencing to boundaries.







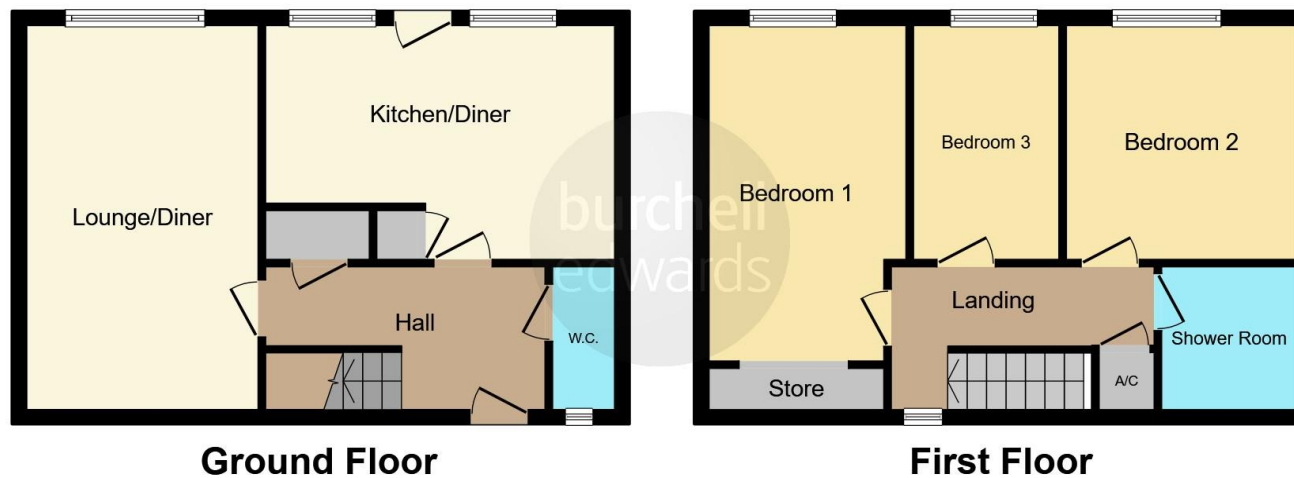

This floor plan is for illustrative purposes only. It is not drawn to scale. Any measurements, floor areas (including any total floor area), openings and orientation are approximate. No details are guaranteed, they cannot be relied upon for any purpose and they do not form part of any agreement. No liability is taken for any error, omission or misstatement. A party must rely upon its own inspection(s). Powered by [www.focalagent.com](http://www.focalagent.com)

To view this property please contact Burchell Edwards on

**T 01827 66400**  
**E [tamworth@burchelledwards.co.uk](mailto:tamworth@burchelledwards.co.uk)**

1 Bolebridge Street  
 TAMWORTH B79 7PA

EPC Rating: C

Tenure: Freehold

**view this property online [burchelledwards.co.uk/Property/TAM206478](http://burchelledwards.co.uk/Property/TAM206478)**



1. MONEY LAUNDERING REGULATIONS Intending purchasers will be asked to produce identification documentation at a later stage and we would ask for your co-operation in order that there will be no delay in agreeing the sale. 2. These particulars do not constitute part or all of an offer or contract. 3. The measurements indicated are supplied for guidance only and as such must be considered incorrect. Potential buyers are advised to recheck measurements before committing to any expense. 4. We have not tested any apparatus, equipment, fixtures, fittings or services and it is in the buyers interest to check the working condition of any appliances.

Burchell Edwards is a trading name of Connells Residential which is registered in England and Wales under company number 1489613, Registered Office is Cumbria House, 16-20 Hockliffe Street, Leighton Buzzard, Bedfordshire, LU7 1GN. VAT Registration Number is 500 2481 05.

**See all our properties at [www.burchelledwards.co.uk](http://www.burchelledwards.co.uk) | [www.rightmove.co.uk](http://www.rightmove.co.uk) | [www.zoopla.co.uk](http://www.zoopla.co.uk)**

Property Ref: TAM206478 - 0003