



Olton Road, Shirley Solihull

burchell
edwards



Property Description

Welcome to your dream home! Nestled in a serene setting, this stunning three/four bedroom detached property boasts a picturesque garden and an expansive driveway. Set back from the road, privacy is paramount, offering a tranquil oasis near Shirley and its amenities. With excellent school catchments, this residence promises an ideal family haven. Explore the vast potential within this generous plot, perfect for creating your personalized paradise. Don't miss this opportunity to embrace comfort, convenience, and endless possibilities!

Don't delay, call today!

Lounge

14' x 9' (4.27m x 2.74m)

Double glazed patio doors to rear elevation and carpet.

Dining Room

21' 4" x 10' 1" (6.50m x 3.07m)

Double glazed windows to front, rear and side elevations, laminate flooring, fire place and door to conservatory.

Kitchen

14' 1" x 8' (4.29m x 2.44m)

Double glazed window to front elevation, a range of wall and base units with work surface over incorporating a sink with drainer unit and tiled flooring.

Conservatory

21' 10" x 9' 10" (6.65m x 3.00m)

Double glazed patio doors to rear elevation, double glazed windows to rear and side elevations, tiled flooring and doors to lounge and dining room.

Bedroom One

14' 1" x 11' 7" max (4.29m x 3.53m max)
Double glazed window to rear elevation, double glazed window to balcony, fitted wardrobe, laminate flooring and central heating radiator.

Bedroom Two

14' x 9' max (4.27m x 2.74m max)
Double glazed window to rear elevation, central heating radiator, carpet and storage cupboard.

Bedroom Three

8' x 8' 8" (2.44m x 2.64m)
Double glazed window to front elevation, central heating radiator and carpet.

Bathroom

Double glazed window to side elevation, shower cubicle, wash hand basin, W.C, tiled walls, laminate flooring and heated towel rail.

Annex

Double glazed window to rear elevation, W.C and storage.

Front Garden

Block paved driveway providing off road parking.

Rear Garden

Large laid lawn garden.









Ground Floor



First Floor

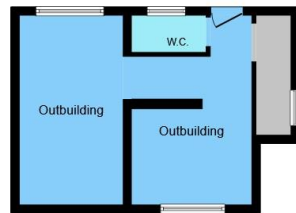

Outbuilding



This floor plan is for illustrative purposes only. It is not drawn to scale. Any measurements, floor areas (including any total floor area), openings and orientation are approximate. No details are guaranteed, they cannot be relied upon for any purpose and they do not form part of any agreement. No liability is taken for any error, omission or misstatement. A party must rely upon its own inspection(s). Powered by www.focalagent.com

To view this property please contact Burchell Edwards on

T 0121 733 3553
E shirley@burchelledwards.co.uk

183 Stratford Road Shirley
SOLIHULL B90 3AU

EPC Rating: D

Tenure: Freehold

view this property online burchelledwards.co.uk/Property/SHI207195



1. MONEY LAUNDERING REGULATIONS Intending purchasers will be asked to produce identification documentation at a later stage and we would ask for your co-operation in order that there will be no delay in agreeing the sale. 2. These particulars do not constitute part or all of an offer or contract. 3. The measurements indicated are supplied for guidance only and as such must be considered incorrect. Potential buyers are advised to recheck measurements before committing to any expense. 4. We have not tested any apparatus, equipment, fixtures, fittings or services and it is in the buyers interest to check the working condition of any appliances.

Burchell Edwards is a trading name of Connells Residential which is registered in England and Wales under company number 1489613, Registered Office is Cumbria House, 16-20 Hockliffe Street, Leighton Buzzard, Bedfordshire, LU7 1GN. VAT Registration Number is 500 2481 05.

See all our properties at www.burchelledwards.co.uk | www.rightmove.co.uk | www.zoopla.co.uk

Property Ref: SHI207195 - 0017