



Whittington Oval, Birmingham

burchell
edwards

Whittington Oval, Birmingham, B33 8JE

for sale offers over
£240,000



Property Description

LARGER STYLE! This is a fantastic FOUR bedroom property having good size bedrooms this could be that property you have been looking for! Having more space and size than other properties in the area. Being offered with NO UPWARD CHAIN this will not be around long! CALL NOW 0121 742 1725.

Entrance Hallway

Central heating radiator and storage cupboard.

Lounge

24' 10" x 7' 8" (7.57m x 2.34m)

Double glazed windows to front and rear elevations, two central heating radiators.

Kitchen

12' 2" x 9' 8" (3.71m x 2.95m)

Double glazed window to rear elevation, a range of wall and base units with work surface over incorporating a sink with drainer unit, gas hob and oven, pantry housing central heating boiler.



Landing

Double glazed window, loft access via hatch and storage cupboard.

Bedroom One

12' 3" x 12' 1" (3.73m x 3.68m)

Double glazed window and central heating radiator.

Bedroom Two

11' 7" x 8' 9" (3.53m x 2.67m)

Double glazed window and central heating radiator.

Bedroom Three

9' 8" x 8' 6" (2.95m x 2.59m)

Two double glazed windows and central heating radiator.

Bedroom Four

11' 2" x 6' 8" (3.40m x 2.03m)

Double glazed window.

Bathroom

Two double glazed windows, W.C, wash hand basin, central heating radiator, tiling to splash prone areas.

W.C

Double glazed window, W.C and wash hand basin.







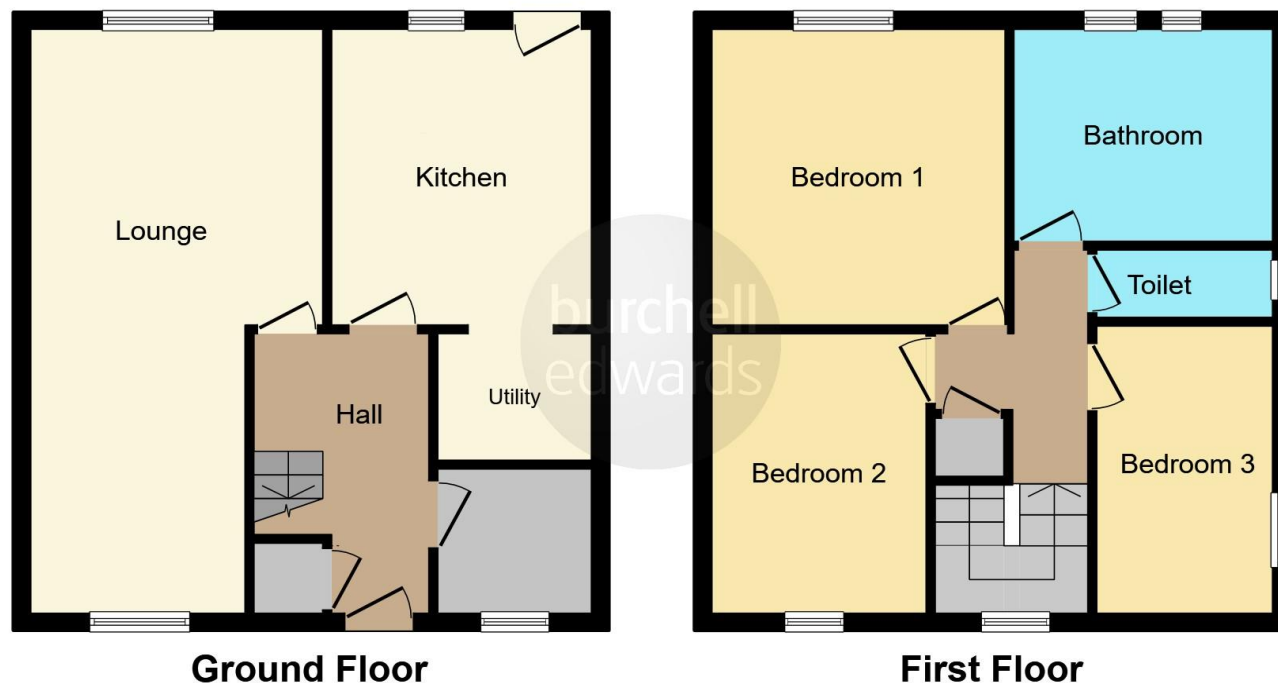

This floor plan is for illustrative purposes only. It is not drawn to scale. Any measurements, floor areas (including any total floor area), openings and orientation are approximate. No details are guaranteed, they cannot be relied upon for any purpose and they do not form part of any agreement. No liability is taken for any error, omission or misstatement. A party must rely upon its own inspection(s). Powered by www.focalagent.com

To view this property please contact Burchell Edwards on

T 0121 742 1725
E sheldon@burchelledwards.co.uk

2208 Coventry Road Sheldon
 BIRMINGHAM B26 3JH

EPC Rating: C Council Tax
 Band: B

Tenure: Freehold

view this property online burchelledwards.co.uk/Property/SHL210714



1. MONEY LAUNDERING REGULATIONS Intending purchasers will be asked to produce identification documentation at a later stage and we would ask for your co-operation in order that there will be no delay in agreeing the sale. 2. These particulars do not constitute part or all of an offer or contract. 3. The measurements indicated are supplied for guidance only and as such must be considered incorrect. Potential buyers are advised to recheck measurements before committing to any expense. 4. We have not tested any apparatus, equipment, fixtures, fittings or services and it is in the buyers interest to check the working condition of any appliances.

Burchell Edwards is a trading name of Connells Residential which is registered in England and Wales under company number 1489613, Registered Office is Cumbria House, 16-20 Hockliffe Street, Leighton Buzzard, Bedfordshire, LU7 1GN. VAT Registration Number is 500 2481 05.

See all our properties at www.burchelledwards.co.uk | www.rightmove.co.uk | www.zoopla.co.uk

Property Ref: SHL210714 - 0002