



Whitecroft Road  
Birmingham







### Property Description

This TWO BEDROOM semi detached property is on a very popular road in Sheldon. Close to local amenities, schools and transport links such as bus routes, M42 and Birmingham international airport and train station. This is just perfect for a FIRST TIME BUYER or FAMILY looking to get on the ladder! CALL NOW!

### Entrance Hallway

Door to side elevation, central heating radiator and under stairs storage cupboard.

### Kitchen

9' 10" max x 6' 2" ( 3.00m max x 1.88m )  
Double glazed window and door to rear elevation, a range of wall and base units with work surface over incorporating a sink with drainer unit, electric hob and oven, cooker hood, space and connections for washing machine, tiling to splash prone areas and central heating radiator.

### Lounge

13' 6" into bay x 16' 4" max ( 4.11m into bay x 4.98m max )  
Double glazed bay window to front elevation, double glazed window to front elevation and central heating radiator.



## Landing

Double glazed window to rear elevation and airing cupboard housing central heating boiler.

## Bedroom One

11' 7" max x 11' 11" into bay ( 3.53m max x 3.63m into bay )

Double glazed bay window to front elevation and central heating radiator.

## Bedroom Two

.10' 8" x 9' 4" ( 3.25m x 2.84m )

Double glazed window to rear elevation and central heating radiator.

## Bathroom

Double glazed windows to rear and side elevations, bath with shower over, wash hand basin, W.C, heated towel rail, tiling to splash prone areas and spotlights.













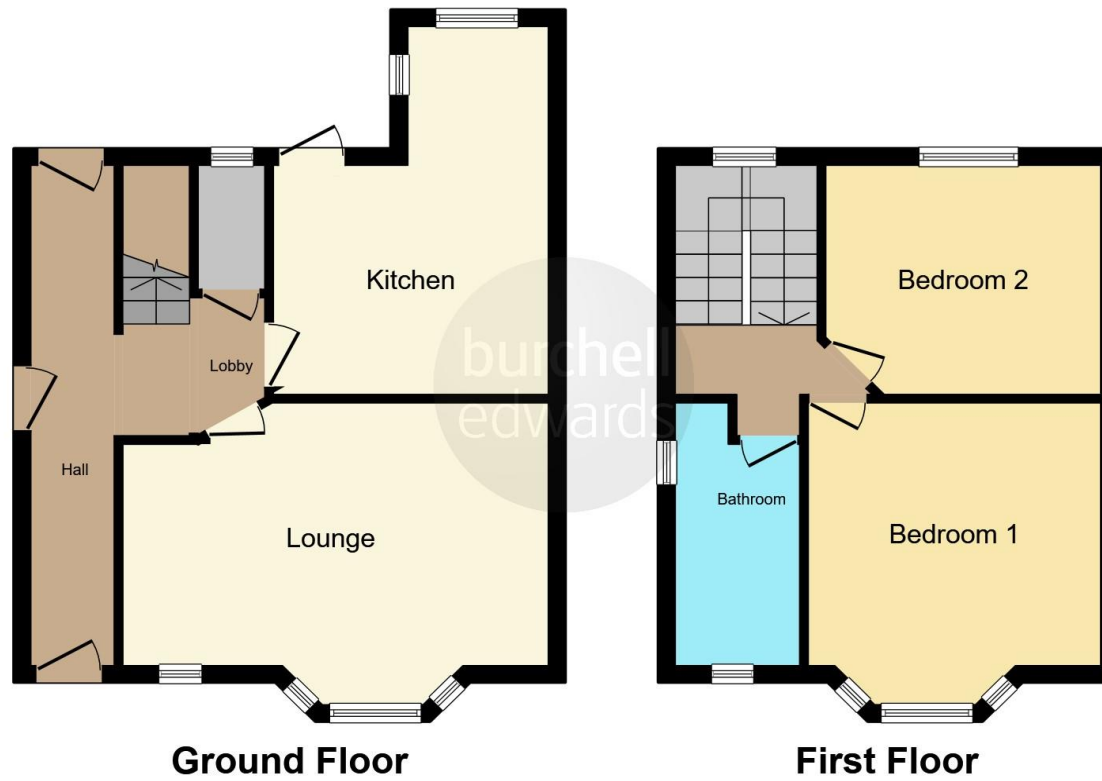

This floor plan is for illustrative purposes only. It is not drawn to scale. Any measurements, floor areas (including any total floor area), openings and orientation are approximate. No details are guaranteed, they cannot be relied upon for any purpose and they do not form part of any agreement. No liability is taken for any error, omission or misstatement. A party must rely upon its own inspection(s). Powered by [www.focalagent.com](http://www.focalagent.com)

To view this property please contact Burchell Edwards on

**T 0121 742 1725**  
**E [sheldon@burchelledwards.co.uk](mailto:sheldon@burchelledwards.co.uk)**

2208 Coventry Road Sheldon  
BIRMINGHAM B26 3JH

EPC Rating: D

Tenure: Freehold

**view this property online [burchelledwards.co.uk/Property/SHL210056](http://burchelledwards.co.uk/Property/SHL210056)**



1. MONEY LAUNDERING REGULATIONS Intending purchasers will be asked to produce identification documentation at a later stage and we would ask for your co-operation in order that there will be no delay in agreeing the sale. 2. These particulars do not constitute part or all of an offer or contract. 3. The measurements indicated are supplied for guidance only and as such must be considered incorrect. Potential buyers are advised to recheck measurements before committing to any expense. 4. We have not tested any apparatus, equipment, fixtures, fittings or services and it is in the buyers interest to check the working condition of any appliances.

Burchell Edwards is a trading name of Connells Residential which is registered in England and Wales under company number 1489613, Registered Office is Cumbria House, 16-20 Hockliffe Street, Leighton Buzzard, Bedfordshire, LU7 1GN. VAT Registration Number is 500 2481 05.

**See all our properties at [www.burchelledwards.co.uk](http://www.burchelledwards.co.uk) | [www.rightmove.co.uk](http://www.rightmove.co.uk) | [www.zoopla.co.uk](http://www.zoopla.co.uk)**

Property Ref: SHL210056 - 0004