



Coventry Road, Sheldon Birmingham





## Property Description

FANTASTIC LOCATION! This THREE BEDROOM semi detached is just perfect for someone to put their stamp on it! In need of updating but with loads of potential this had been priced to sell! Transport Routes to BIRMINGHAM CENTRE & AIRPORT, a stones throw from SOLIHULL this will not be around long! CALL NOW!

## Entrance Porch

Double glazed door to front elevation and tiled floor.

## Entrance Hallway

Single glazed door to front elevation, central heating radiator and under stairs storage.

## Lounge

13' 4" into bay x 10' 7" ( 4.06m into bay x 3.23m )  
Double glazed bay window to rear elevation, gas fire and central heating radiator.

## Dining Room

11' 2" x 12' 5" into bay ( 3.40m x 3.78m into bay )  
Double glazed bay window to front elevation and central heating radiator.

## Kitchen

7' 10" x 5' 8" ( 2.39m x 1.73m )  
Double glazed window to side elevation, single glazed door to rear elevation, a range of wall and base units with work surface over incorporating a sink with drainer unit, gas hob, electric oven and part tiled walls.



## Landing

Single glazed window to side elevation.

## Bedroom One

10' 8" x 13' 2" into bay ( 3.25m x 4.01m into bay )  
Double glazed bay window to front elevation.

## Bedroom Two

13' 9" into bay x 10' 9" ( 4.19m into bay x 3.28m )  
Double glazed bay window to rear elevation.

## Bedroom Three

7' x 5' 11" ( 2.13m x 1.80m )  
Double glazed window to front elevation.

## Bathroom

Double glazed window to rear elevation, loft access, bath with shower over, W.C and wash hand basin.

## Rear Garden

Slabbed patio and laid lawn.

## Garage







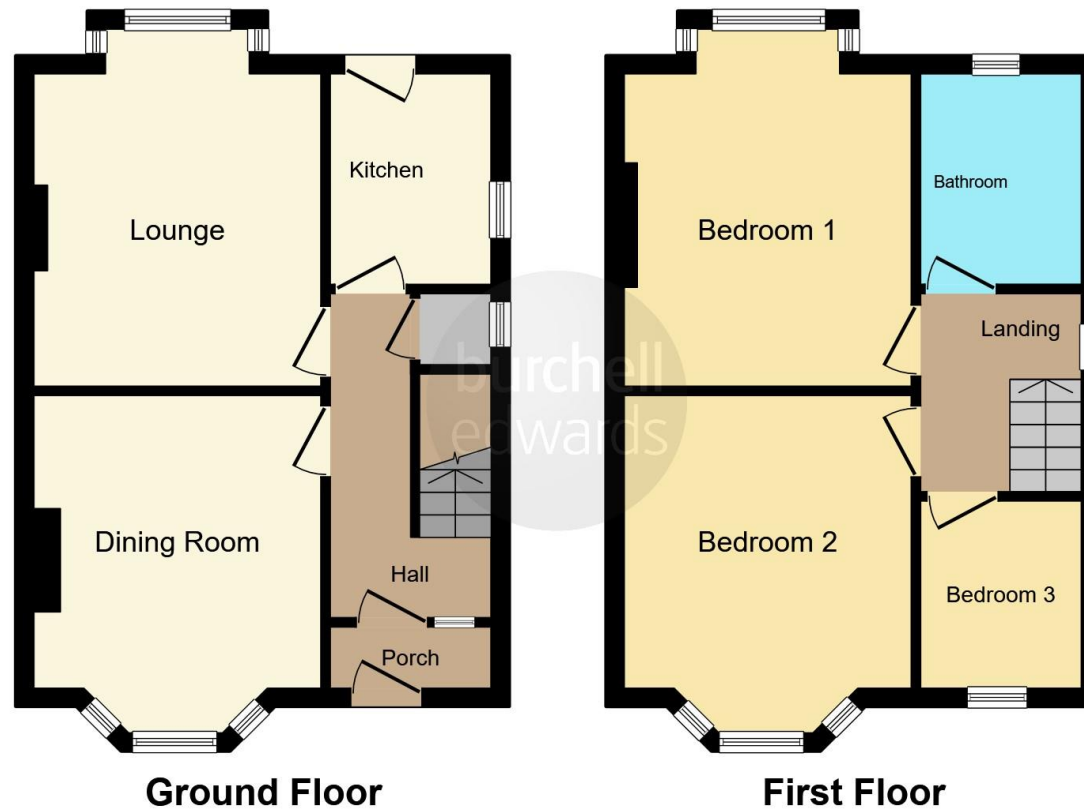

This floorplan is for illustrative purposes only and is not drawn to scale. Measurements, floor-areas, openings and orientations are approximate. They should not be relied upon for any purpose and do not form any part of an agreement. No liability is taken for any error or mis-statement. All parties must rely on their own inspections.

To view this property please contact Burchell Edwards on

**T 0121 742 1725**  
**E sheldon@burchelledwards.co.uk**

2208 Coventry Road Sheldon  
 BIRMINGHAM B26 3JH

EPC Rating: E

Tenure: Freehold

**view this property online** [burchelledwards.co.uk/Property/SHL209551](http://burchelledwards.co.uk/Property/SHL209551)



1. MONEY LAUNDERING REGULATIONS Intending purchasers will be asked to produce identification documentation at a later stage and we would ask for your co-operation in order that there will be no delay in agreeing the sale. 2. These particulars do not constitute part or all of an offer or contract. 3. The measurements indicated are supplied for guidance only and as such must be considered incorrect. Potential buyers are advised to recheck measurements before committing to any expense. 4. We have not tested any apparatus, equipment, fixtures, fittings or services and it is in the buyers interest to check the working condition of any appliances.

Burchell Edwards is a trading name of Connells Residential which is registered in England and Wales under company number 1489613, Registered Office is Cumbria House, 16-20 Hockliffe Street, Leighton Buzzard, Bedfordshire, LU7 1GN. VAT Registration Number is 500 2481 05.

**See all our properties at** [www.burchelledwards.co.uk](http://www.burchelledwards.co.uk) | [www.rightmove.co.uk](http://www.rightmove.co.uk) | [www.zoopla.co.uk](http://www.zoopla.co.uk)

Property Ref: SHL209551 - 0021