



The Fields  
Rainworth MANSFIELD



# The Fields

## Rainworth MANSFIELD NG21 0GY

for sale  
**£290,000**



### Property Description

Spacious Four-Bedroom Detached Home in The Fields, Rainworth

Located in the popular village of Rainworth, Mansfield, this well-presented four-bedroom detached home offers modern living in a peaceful setting.

The ground floor features a bright and airy lounge/diner, a well-equipped, modern kitchen with integral appliances included, and a convenient cloakroom.

Upstairs, there are four generously sized bedrooms, including a master with an ensuite, plus a family bathroom.

Externally, the front of the property boasts a driveway leading to a detached single garage, with a small flower bed adding charm. The low-maintenance rear garden includes a slabbed patio and lawned area.

Set in a desirable village location, this home is perfect for families or professionals seeking a well-appointed property. Contact us today to arrange a viewing!

### Entrance Hall

Entrance hall with wall mounted radiator and vinyl floor to finish.

### Cloakroom / Wc

Cloakroom with toilet and pedestal sink, wall mounted radiator and tiled floor to finish.

### Lounge

14' 7" x 15' 6" ( 4.45m x 4.72m )

Lounge comprises of French door to the rear, wall mounted radiator, storage cupboard and carpeted floor to finish.

### Kitchen

11' 3" x 8' 5" ( 3.43m x 2.57m )

The kitchen includes matching wall and base mounted units, stainless steel sink and drainer, double-glazed window to rear, wall mounted radiator, fridge/freezer, plumbing and space for washer, dishwasher, induction hob, cooker hood with integrated electric oven, and vinyl floor to finish.



## First Floor Landing

Landing offering loft access and wall mounted radiator, finished with carpeted floor.

## Bedroom One

.13' 1" x 10' 2" ( 3.99m x 3.10m )

The master bedroom comprising of double-glazed windows to front, wall mounted radiator, fitted wardrobes with carpeted floor to finish.

## En-Suite Shower Room

En-suite situated off the master bedroom includes walk-in shower with rainfall shower, pedestal wash-hand basin and toilet, tiling, wall mounted towel radiator, double glazed window to rear, and vinyl flooring to finish.

## Bedroom Two

9' 7" into recess x 13' 11" ( 2.92m into recess x 4.24m )

Bedroom two includes double-glazed window to rear, wall mounted radiator, and carpeted floor to finish.

## Bedroom Three

9' 6" x 11' 8" ( 2.90m x 3.56m )

Bedroom three comprises of double-glazed window to rear, wall mounted radiator, and carpeted floor to finish.

## Bedroom Four

7' 4" x 9' plus door recess ( 2.24m x 2.74m plus door recess )

Bedroom four includes double-glazed window to front, wall mounted radiator and carpeted floor to finish.

## Family Bathroom

The bathroom is finished with a ceramic toilet/sink, bath, wall mounted radiator, tiled splashback, and tiled floor to finish.

## Garage

9' 4" x 16' 11" at door opening ( 2.84m x 5.16m at door opening )

Garage is detached with up and over door, electrics and lighting with access door to the rear.

## Front Elevation

To the front of the property a driveway leading to a detached single garage, with a small flower bed.

## Rear Elevation

The rear garden includes a slabbed patio and lawned area.







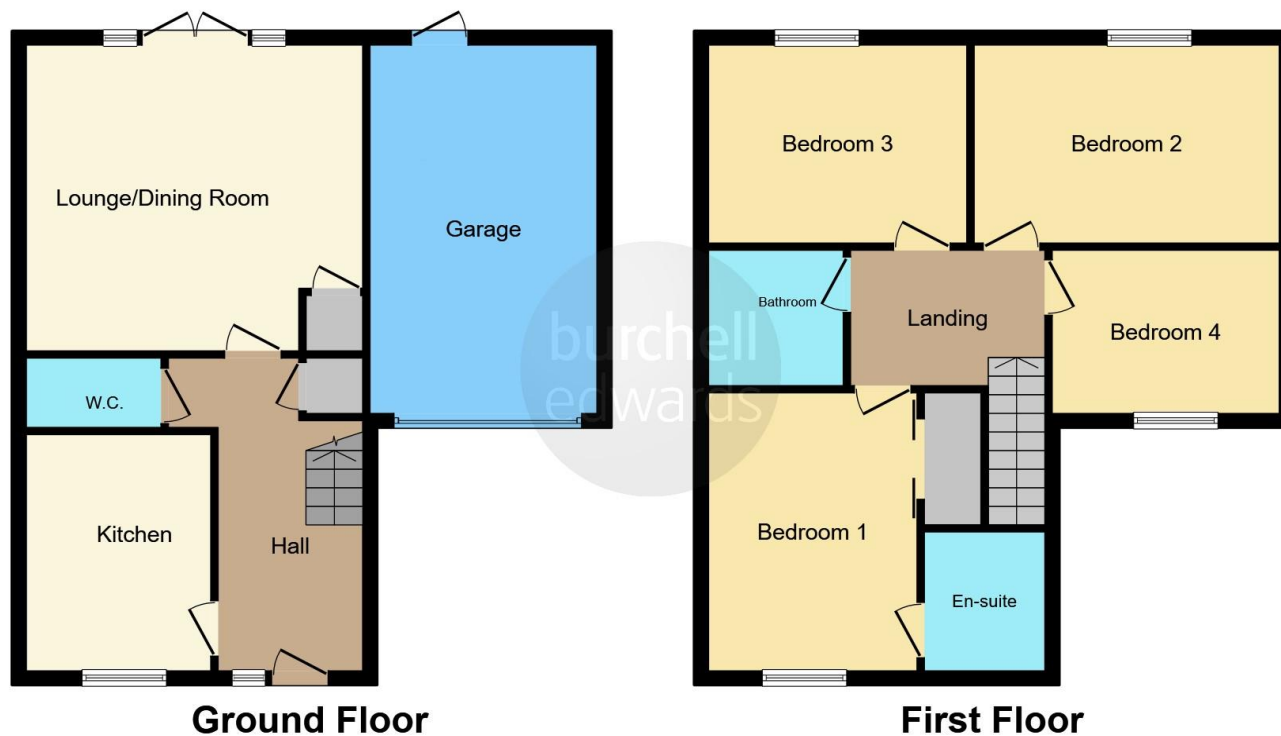

This floor plan is for illustrative purposes only. It is not drawn to scale. Any measurements, floor areas (including any total floor area), openings and orientation are approximate. No details are guaranteed, they cannot be relied upon for any purpose and they do not form part of any agreement. No liability is taken for any error, omission or misstatement. A party must rely upon its own inspection(s). Powered by [www.focalagent.com](http://www.focalagent.com)

To view this property please contact Burchell Edwards on

**T 01623 627727**  
**E [Mansfield@burchelledwards.co.uk](mailto:Mansfield@burchelledwards.co.uk)**

12 Albert Street  
 MANSFIELD NG18 1EB

EPC Rating: C Council Tax  
 Band: D

Tenure: Freehold

**view this property online [burchelledwards.co.uk/Property/MFD208788](http://burchelledwards.co.uk/Property/MFD208788)**



1. MONEY LAUNDERING REGULATIONS Intending purchasers will be asked to produce identification documentation at a later stage and we would ask for your co-operation in order that there will be no delay in agreeing the sale. 2. These particulars do not constitute part or all of an offer or contract. 3. The measurements indicated are supplied for guidance only and as such must be considered incorrect. Potential buyers are advised to recheck measurements before committing to any expense. 4. We have not tested any apparatus, equipment, fixtures, fittings or services and it is in the buyers interest to check the working condition of any appliances.

Burchell Edwards is a trading name of Connells Residential which is registered in England and Wales under company number 1489613, Registered Office is Cumbria House, 16-20 Hockliffe Street, Leighton Buzzard, Bedfordshire, LU7 1GN. VAT Registration Number is 500 2481 05.

**See all our properties at [www.burchelledwards.co.uk](http://www.burchelledwards.co.uk) | [www.rightmove.co.uk](http://www.rightmove.co.uk) | [www.zoopla.co.uk](http://www.zoopla.co.uk)**

Property Ref: MFD208788 - 0008