



Sheringham Drive
Mansfield



Sheringham Drive Mansfield NG18 4DL

for sale offers over
£200,000



Property Description

Burchell Edwards are excited to offer to the market a two-bed bungalow situated in the market town of Mansfield within the parish of Mansfield District of Nottinghamshire.

On approach you are greeted by an attractive and well-maintained garden and driveway leading to the rear garden and single detached garage. The front of the property has the added character of featured brickwork and matured bushes and shrubs.

This property offers two bedrooms finished with laminate floor to bedroom one and carpeted floor to bedroom two, a well-presented kitchen with wall and base units and includes integrated appliances and laminate flooring. The bathroom is well presented with white ceramic suite, walk in shower, under floor heating with full height tiling and tiled floor to finish. A spacious and light living room with fireplace and sliding door access to conservatory which includes utility area with plumbing and space for washer/dryer, tiled flooring and access to the rear garden.

To the rear of the property, you will find a low maintenance, gated and very well-presented garden with access to the garage, slatted finish and matured bushes and shrubs. The garage has front and side access and electrics so perfect for storage, parking or workshop.

For any enquiries, please contact us on 01623 627727

Front Elevation

On approach you have a driveway, matured bushes and shrubs with gated access to the rear garden.

Rear Elevation

Enclosed slatted and paved garden with matured bushes and plants, gated access from the front, conservatory and garage.

Entrance Hall

UPVC front door leading into entrance hall where you access all rooms excluding the conservatory and laminate floor to finish.

Living Room

14' 11" Plus door recess x 10' 10" Into chimney breast (4.55m Plus door recess x 3.30m Into chimney breast)

Light and airy living room with fireplace and surround, wall mounted radiator, sliding double glazed door to conservatory and laminate floor to finish.

Kitchen

8' 11" x 7' 10" (2.72m x 2.39m)

Included in the kitchen is wall and base mounted units with integrated electric oven, gas hob, extractor, undercounter fridge and freezer, stainless steel sink and drainer, wall mounted radiator, double glazed window to rear and laminate floor to finish.

Bedroom One

.13' 2" x 10' 11" (4.01m x 3.33m)

Bedroom one offers space for a double bed, wall mounted radiator, double glazed window to front and laminate floor to finish.

Bedroom Two

8' 11" x 9' 11" (2.72m x 3.02m)

Bedroom two includes wall mounted radiator, double glazed window to front and carpet to finish.

Bathroom

Fitted with white modern ceramic suite the bathroom offers full height tiling to walls and floor, walk in shower, mains tower radiator and under floor heating as well as double glazed window to side.

Conservatory

10' 1" x 8' (3.07m x 2.44m)

Accessed from the living room the

conservatory includes a utility area with plumbing and space for a washer or dryer, tiled floor to finish and double glazed windows and door leading on to the rear of the property.

Garage

18' 11" x 8' 11" (5.77m x 2.72m)

Detached build with side and up and over front access, concrete floor and electrics.







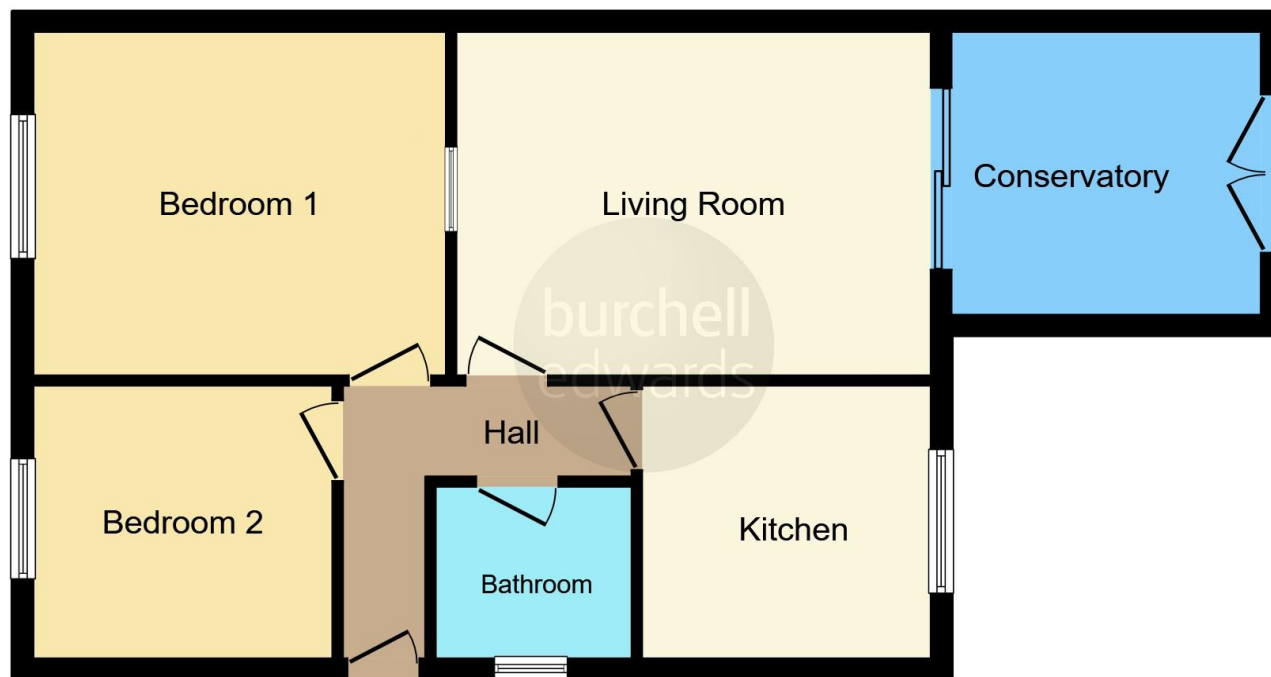

This floor plan is for illustrative purposes only. It is not drawn to scale. Any measurements, floor areas (including any total floor area), openings and orientation are approximate. No details are guaranteed, they cannot be relied upon for any purpose and they do not form part of any agreement. No liability is taken for any error, omission or misstatement. A party must rely upon its own inspection(s). Powered by www.focalagent.com

To view this property please contact Burchell Edwards on

T 01623 627727
E Mansfield@burchelledwards.co.uk

12 Albert Street
 MANSFIELD NG18 1EB

EPC Rating: C

Tenure: Freehold

view this property online burchelledwards.co.uk/Property/MFD208650



1. MONEY LAUNDERING REGULATIONS Intending purchasers will be asked to produce identification documentation at a later stage and we would ask for your co-operation in order that there will be no delay in agreeing the sale. 2. These particulars do not constitute part or all of an offer or contract. 3. The measurements indicated are supplied for guidance only and as such must be considered incorrect. Potential buyers are advised to recheck measurements before committing to any expense. 4. We have not tested any apparatus, equipment, fixtures, fittings or services and it is in the buyers interest to check the working condition of any appliances.

Burchell Edwards is a trading name of Connells Residential which is registered in England and Wales under company number 1489613, Registered Office is Cumbria House, 16-20 Hockliffe Street, Leighton Buzzard, Bedfordshire, LU7 1GN. VAT Registration Number is 500 2481 05.

See all our properties at www.burchelledwards.co.uk | www.rightmove.co.uk | www.zoopla.co.uk

Property Ref: MFD208650 - 0010