



Godfrey Street
Netherfield Nottingham

Godfrey Street Netherfield Nottingham NG4 2JG

for sale
£200,000



Property Description

SEMI DETACHED HOME !! SET OVER THREE FLOORS !! THREE DOUBLE BEDROOMS !! BESPOKE KITCHEN / DINER !! We at Burchell Edwards are delighted to offer to the market this well presented well maintained semi detached home that is located close to Victoria retail park and is ready for a new owner to love.

Located in a nice quiet residential road in the heart of Netherfield we have this charming semi detached home that has been renovated by the present owner and offers spacious bright living and is within the shortest of distance to the town centre and the Victoria retail park and will make for the perfect purchase.

The home comprises of lounge, modern newly fitted open plan kitchen/diner to the ground floor. The first floor holds two double bedrooms and the large family bathroom with the third double bedroom on the second floor.

To the rear is the private enclosed garden and there is private driveway parking to the front and ample non-permit street parking is also available.

We feel with what this home has to offer and the amazing location really makes this a must see so please call Burchell Edwards today to arrange your viewing.

To The Front

To the front of the property is a driveway with space for parking for one vehicle. The UPVC front door leads directly into the open plan kitchen/diner.

Kitchen/Diner

24' 7" x 12' 11" (7.49m x 3.94m)

Having two double-glazed side aspect windows and door and a rear aspect double-glazed window. Fitted with laminate flooring and a radiator. The bespoke kitchen has a selection of wall and base units including two integrated eye-level ovens, extractor fan and a central island unit.

Living Room

11' 8" x 11' 2" (3.56m x 3.40m)

Having a double-glazed front aspect window with laminate flooring and a radiator.

Bedroom One

11' 9" x 11' 1" (3.58m x 3.38m)

Having a double-glazed front aspect window with fitted carpet and a radiator.

Bedroom Two

10' 2" x 8' 3" (3.10m x 2.51m)

Having a double-glazed side aspect window with fitted carpet and a radiator.

Bathroom

Having a double-glazed side aspect window with linoleum flooring and a fitted radiator. Suite includes a walk-in shower, a panelled bath, a low-level WC and a handwash basin.

Bedroom Three

11' 8" x 9' 2" (3.56m x 2.79m)

Located on the second floor. Having a double-glazed side aspect window with fitted carpet and a radiator with spacious storage.

To The Rear

Having a patio area leading to a grass lawn.









Ground Floor

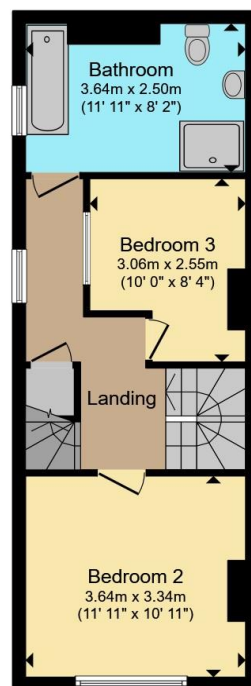

First Floor



Second Floor

Total floor area 96.8 m² (1,042 sq.ft.) approx

This floor plan is for illustrative purposes only. It is not drawn to scale. Any measurements, floor areas (including any total floor area), openings and orientation are approximate. No details are guaranteed, they cannot be relied upon for any purpose and they do not form part of any agreement. No liability is taken for any error, omission or misstatement. A party must rely upon its own inspection(s). Powered by www.propertybox.io



To view this property please contact Burchell Edwards on

T 01159 327232
E ilkeston@burchelledwards.co.uk

21 Bath Street
ILKESTON DE7 8AH

EPC Rating: D Council Tax
Band: A

Tenure: Freehold

view this property online burchelledwards.co.uk/Property/IST207482



1. MONEY LAUNDERING REGULATIONS Intending purchasers will be asked to produce identification documentation at a later stage and we would ask for your co-operation in order that there will be no delay in agreeing the sale. 2. These particulars do not constitute part or all of an offer or contract. 3. The measurements indicated are supplied for guidance only and as such must be considered incorrect. Potential buyers are advised to recheck measurements before committing to any expense. 4. We have not tested any apparatus, equipment, fixtures, fittings or services and it is in the buyers interest to check the working condition of any appliances.

Burchell Edwards is a trading name of Connells Residential which is registered in England and Wales under company number 1489613, Registered Office is Cumbria House, 16-20 Hockliffe Street, Leighton Buzzard, Bedfordshire, LU7 1GN. VAT Registration Number is 500 2481 05.

See all our properties at www.burchelledwards.co.uk | www.rightmove.co.uk | www.zoopla.co.uk

Property Ref: IST207482 - 0002