



Boundary Road, Birmingham





Property Description

A beautifully presented 2 bedroom apartment in the popular Highcroft estate that would be an ideal first home or investment buy to let with no upward chain. Offering spacious and modern internals with two double bedrooms, lounge, kitchen/diner, bathroom, walkable local amenities, and more. Call to book your viewing with Burchell Edwards today.

Entrance Hallway

Laminate flooring and two storage cupboards.

Lounge/ Kitchen

16' 1" x 22' 9" (4.90m x 6.93m)

Lounge Area

Double glazed doors out to juliet balcony and laminate flooring.

Kitchen Area

A range of wall and base units with work surface over incorporating a sink with drainer unit, electric hob and cooker, extractor hood, integrated fridge freezer, space and plumbing for washing machine.

Bedroom One

10' 2" max x 16' (3.10m max x 4.88m)
Double glazed window to front elevation and electric storage heater.

Bedroom Two

10' 1" x 9' 1" (3.07m x 2.77m)
Double glazed window to front elevation and electric radiator.

Bathroom

Modern suite comprising of wash hand basin, W.C, bath with shower over, extractor fan and electric wall mounted heater.







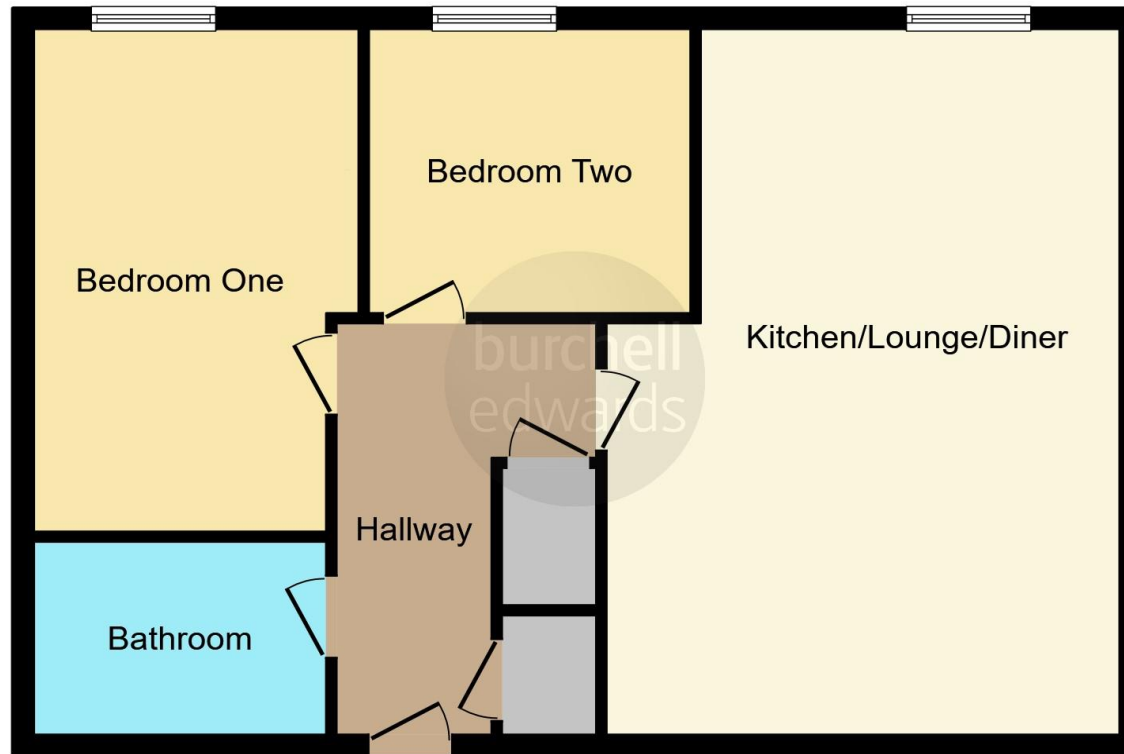

This floor plan is for illustrative purposes only. It is not drawn to scale. Any measurements, floor areas (including any total floor area), openings and orientation are approximate. No details are guaranteed, they cannot be relied upon for any purpose and they do not form part of any agreement. No liability is taken for any error, omission or misstatement. A party must rely upon its own inspection(s). Powered by www.focalagent.com

To view this property please contact Burchell Edwards on

T 0121 373 6320
E erdington@burchelledwards.co.uk

Unit 3 Queens Court, Gravelly Hill Erdington
BIRMINGHAM B23 6BJ

EPC Rating: C

Tenure: Leasehold

view this property online burchelledwards.co.uk/Property/ERD206753

This is a Leasehold property with details as follows; Term of Lease 150 years from 20 Sep 2024. Should you require further information please contact the branch. Please Note additional fees could be incurred for items such as Leasehold packs.



1. MONEY LAUNDERING REGULATIONS Intending purchasers will be asked to produce identification documentation at a later stage and we would ask for your co-operation in order that there will be no delay in agreeing the sale. 2. These particulars do not constitute part or all of an offer or contract. 3. The measurements indicated are supplied for guidance only and as such must be considered incorrect. Potential buyers are advised to recheck measurements before committing to any expense. 4. We have not tested any apparatus, equipment, fixtures, fittings or services and it is in the buyers interest to check the working condition of any appliances.

Burchell Edwards is a trading name of Connells Residential which is registered in England and Wales under company number 1489613, Registered Office is Cumbria House, 16-20 Hockliffe Street, Leighton Buzzard, Bedfordshire, LU7 1GN. VAT Registration Number is 500 2481 05.

See all our properties at www.burchelledwards.co.uk | www.rightmove.co.uk | www.zoopla.co.uk

Property Ref: ERD206753 - 0002