



Knights Close, Birmingham





Property Description

Burchell Edwards, Erdington are proud to present to you this beautifully presented one bedroom studio apartment! This property would be perfect for first time buyers or buy to let investors! This one bedroom apartment offers a large bedroom/lounge, fully fitted kitchen and a easy maintainable bathroom. Externally there is large communal garden which is maintained. Call Burchell Edwards now to avoid missing out!

Communal Entrance

Door to front elevation.

Entrance Hallway

Timber door to front elevation.

Cloakroom

Electric meter and laminate flooring.

Lounge

14' 9" x 8' 11" (4.50m x 2.72m)

Two single glazed windows to side elevation, laminate flooring and electric radiator.

Kitchen

8' 6" x 8' 2" (2.59m x 2.49m)

Double glazed window to side elevation, a range of wall and base units with work surface over incorporating a sink with drainer unit, cooker, hob, tiling to walls and laminate flooring.

Bathroom

Shower cubicle, W.C, wash hand basin, tiling to walls and laminate flooring.







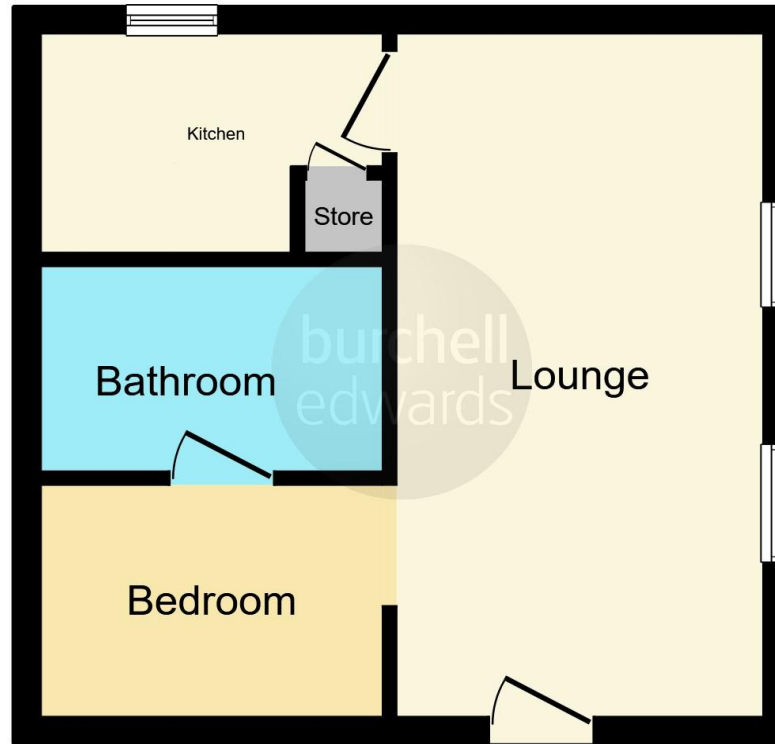

This floor plan is for illustrative purposes only. It is not drawn to scale. Any measurements, floor areas (including any total floor area), openings and orientation are approximate. No details are guaranteed, they cannot be relied upon for any purpose and they do not form part of any agreement. No liability is taken for any error, omission or misstatement. A party must rely upon its own inspection(s). Powered by www.focalagent.com

To view this property please contact Burchell Edwards on

T 0121 373 6320
E erdington@burchelledwards.co.uk

Unit 3 Queens Court, Gravelly Hill Erdington
BIRMINGHAM B23 6BJ

EPC Rating: D

Tenure: Leasehold

view this property online burchelledwards.co.uk/Property/ERD206581

This is a Leasehold property. We are awaiting further details about the Term of the lease. For further information please contact the branch. Please note additional fees could be incurred for items such as Leasehold packs.



1. MONEY LAUNDERING REGULATIONS Intending purchasers will be asked to produce identification documentation at a later stage and we would ask for your co-operation in order that there will be no delay in agreeing the sale. 2. These particulars do not constitute part or all of an offer or contract. 3. The measurements indicated are supplied for guidance only and as such must be considered incorrect. Potential buyers are advised to recheck measurements before committing to any expense. 4. We have not tested any apparatus, equipment, fixtures, fittings or services and it is in the buyers interest to check the working condition of any appliances.

Burchell Edwards is a trading name of Connells Residential which is registered in England and Wales under company number 1489613, Registered Office is Cumbria House, 16-20 Hockliffe Street, Leighton Buzzard, Bedfordshire, LU7 1GN. VAT Registration Number is 500 2481 05.

See all our properties at www.burchelledwards.co.uk | www.rightmove.co.uk | www.zoopla.co.uk

Property Ref: ERD206581 - 0002