



Brookvale Park Road, BIRMINGHAM





Property Description

A beautifully presented three bedroom, one exception room family home in a popular area that would be an ideal first time buy or investment buy to let! This stunning property has been upgraded throughout and offers fantastic style and character for all to appreciate. Benefits include recently refurbished and good local commuter options via public transport or motorway links. Book your viewing with Burchell Edwards estate agents today to avoid missing out!

Entrance Porch

Electric and gas meters.

Entrance Hallway

Stairs to first floor accommodation and door into:

Lounge/ Diner

17' 9" into bay x 11' 11" into recess (5.41m into bay x 3.63m into recess)

Double glazed baywindow to front elevation, wooden flooring, spotlights, central heating radiator and storage under stairs.

Kitchen

9' 9" x 9' 4" (2.97m x 2.84m)

Double glazed window and door to rear elevation, a range of wall and base units with work surface over incorporating a sink with drainer unit, integrated cooker and hob, combi boiler, spotlights, tiling to splash prone areas and central heating radiator.



Landing

Loft access and doors off to:

Bedroom One

14' 3" into bay x 17' 1" into recess (4.34m into bay x 5.21m into recess)

Double glazed bay window and further window to front elevation, carpet, storage cupboard and central heating radiator.

Bedroom Two

13' 4" x 9' 4" (4.06m x 2.84m)

Double glazed window to rear elevation, carpet and central heating radiator.

Bedroom Three

9' 6" x 7' 6" (2.90m x 2.29m)

Double glazed window to rear elevation, carpet and central heating radiator.

Bathroom

Double glazed window to rear elevation, W.C, wash hand basin, tiled flooring, bath, tiled walls and spotlights.

Front Garden

Pathway leading to garden and grey rendered frontage.

Rear Garden

Patio area leading to laid lawn.







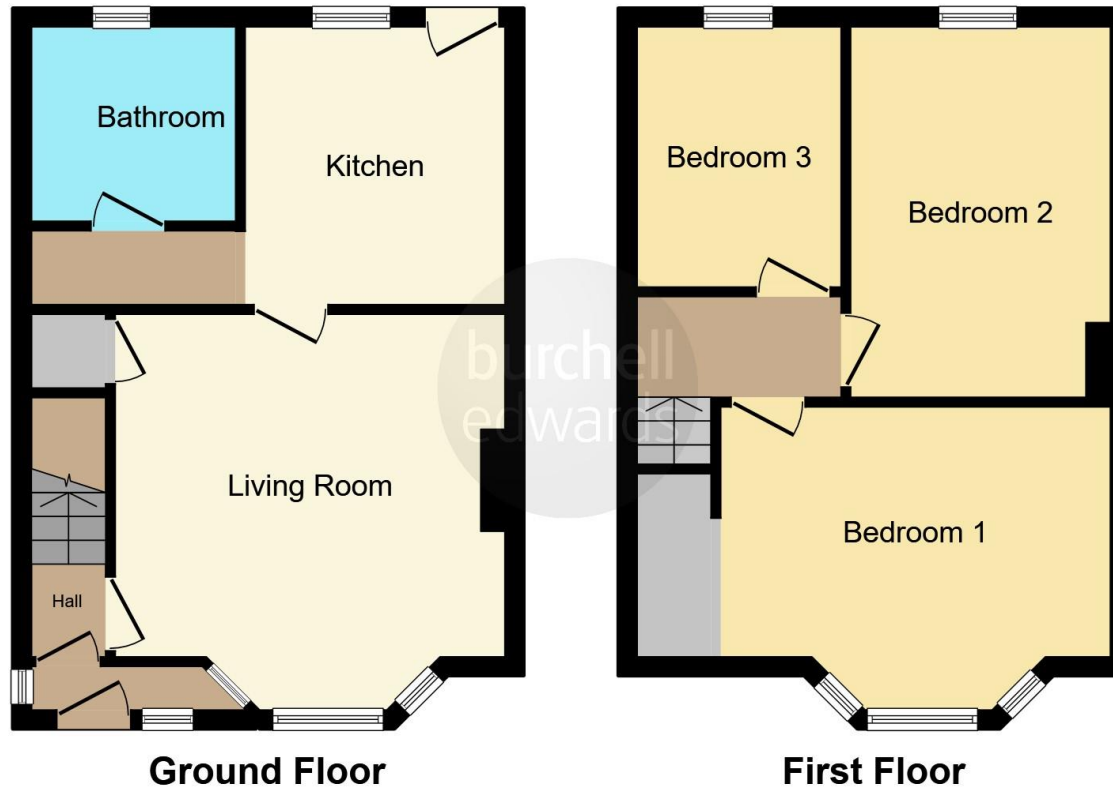

This floor plan is for illustrative purposes only. It is not drawn to scale. Any measurements, floor areas (including any total floor area), openings and orientation are approximate. No details are guaranteed, they cannot be relied upon for any purpose and they do not form part of any agreement. No liability is taken for any error, omission or misstatement. A party must rely upon its own inspection(s). Powered by www.focalagent.com

To view this property please contact Burchell Edwards on

T 0121 373 6320
E erdington@burchelledwards.co.uk

Unit 3 Queens Court, Gravelly Hill Erdington
 BIRMINGHAM B23 6BJ

EPC Rating: D

Tenure: Freehold

view this property online burchelledwards.co.uk/Property/ERD206135



1. MONEY LAUNDERING REGULATIONS Intending purchasers will be asked to produce identification documentation at a later stage and we would ask for your co-operation in order that there will be no delay in agreeing the sale. 2. These particulars do not constitute part or all of an offer or contract. 3. The measurements indicated are supplied for guidance only and as such must be considered incorrect. Potential buyers are advised to recheck measurements before committing to any expense. 4. We have not tested any apparatus, equipment, fixtures, fittings or services and it is in the buyers interest to check the working condition of any appliances.

Burchell Edwards is a trading name of Connells Residential which is registered in England and Wales under company number 1489613, Registered Office is Cumbria House, 16-20 Hockliffe Street, Leighton Buzzard, Bedfordshire, LU7 1GN. VAT Registration Number is 500 2481 05.

See all our properties at www.burchelledwards.co.uk | www.rightmove.co.uk | www.zoopla.co.uk

Property Ref: ERD206135 - 0002