



Penns Lane, Coleshill Birmingham





## Property Description

Burchell Edwards are proud to present this three bedroom, mid-terraced property with parking located in Coleshill. This property is available with no upwards chain.

## Entrance Hallway

Door to front elevation, laminate flooring, stairs to first floor accommodation and central heating radiator.

## Lounge

18' 6" x 10' 10" max ( 5.64m x 3.30m max )  
Double glazed window to front elevation, double glazed patio doors to rear elevation, two central heating radiators and laminate flooring.

## Kitchen

11' 8" x 8' 10" ( 3.56m x 2.69m )  
Double glazed window to rear elevation, a range of wall and base units with work surface over incorporating a sink with drainer unit, hob, cooker hood, washing machine, oven, tiled flooring, central heating boiler and storage cupboard.



## Landing

Airing cupboard, carpet and loft access.

## Bedroom One

9' 6" x 10' 11" ( 2.90m x 3.33m )

Double glazed window to rear elevation, central heating radiator and carpet.

## Bedroom Two

9' 1" x 9' 10" ( 2.77m x 3.00m )

Two double glazed windows to front elevation, carpet and central heating radiator.

## Bedroom Three

6' 2" x 6' 11" ( 1.88m x 2.11m )

Double glazed window to front elevation and carpet.

## Bathroom

Double glazed window to rear elevation, wash hand basin, W.C, bath, shower, lino flooring and central heating radiator.

## Front Garden

Paved driveway providing off road parking.

## Rear Garden

Decking, laid to lawn, plants and shrubs.







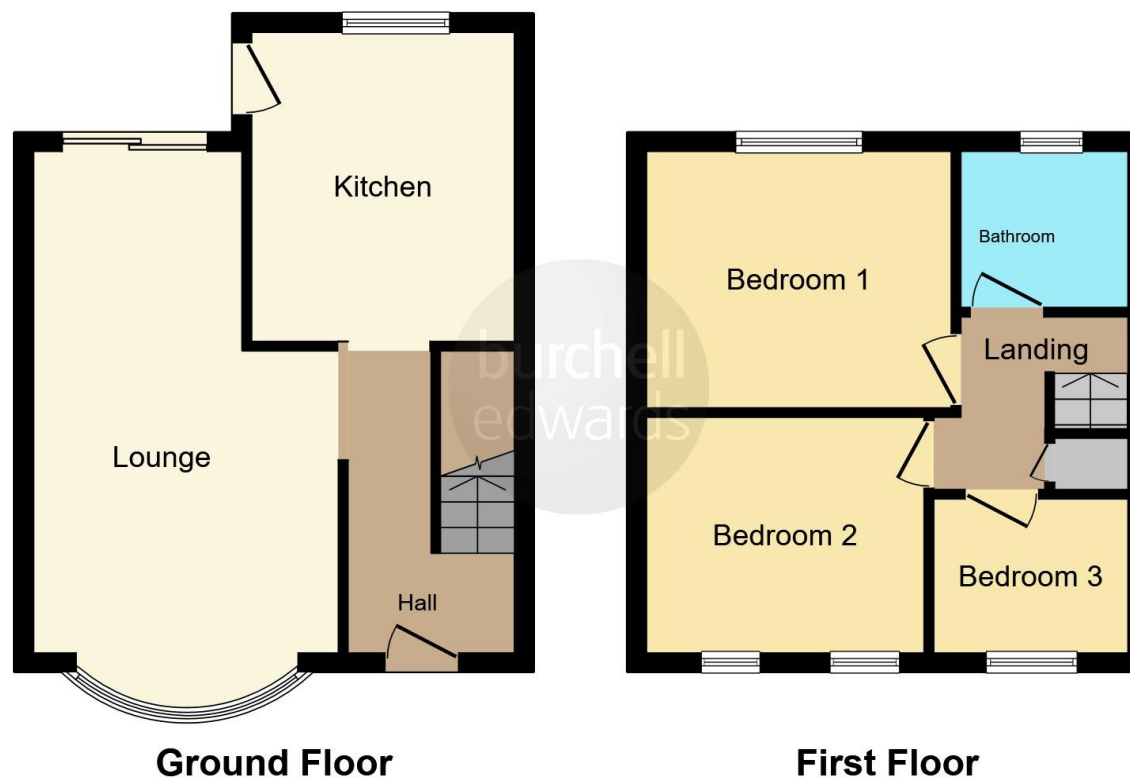

This floor plan is for illustrative purposes only. It is not drawn to scale. Any measurements, floor areas (including any total floor area), openings and orientation are approximate. No details are guaranteed, they cannot be relied upon for any purpose and they do not form part of any agreement. No liability is taken for any error, omission or misstatement. A party must rely upon its own inspection(s). Powered by [www.focalagent.com](http://www.focalagent.com)

To view this property please contact Burchell Edwards on

**T 0121 749 7888**  
**E [castlebromwich@burchelledwards.co.uk](mailto:castlebromwich@burchelledwards.co.uk)**

2-4 Hurst Lane  
 BIRMINGHAM B34 7HR

EPC Rating: Awaited

Tenure: Freehold

**view this property online [burchelledwards.co.uk/Property/CBW209807](http://burchelledwards.co.uk/Property/CBW209807)**



1. MONEY LAUNDERING REGULATIONS Intending purchasers will be asked to produce identification documentation at a later stage and we would ask for your co-operation in order that there will be no delay in agreeing the sale. 2. These particulars do not constitute part or all of an offer or contract. 3. The measurements indicated are supplied for guidance only and as such must be considered incorrect. Potential buyers are advised to recheck measurements before committing to any expense. 4. We have not tested any apparatus, equipment, fixtures, fittings or services and it is in the buyers interest to check the working condition of any appliances.

Burchell Edwards is a trading name of Connells Residential which is registered in England and Wales under company number 1489613, Registered Office is Cumbria House, 16-20 Hockliffe Street, Leighton Buzzard, Bedfordshire, LU7 1GN. VAT Registration Number is 500 2481 05.

**See all our properties at [www.burchelledwards.co.uk](http://www.burchelledwards.co.uk) | [www.rightmove.co.uk](http://www.rightmove.co.uk) | [www.zoopla.co.uk](http://www.zoopla.co.uk)**

Property Ref: CBW209807 - 0002