



Tulip Road
Tutbury Burton-On-Trent



Tulip Road Tutbury Burton-On-Trent DE13 9LX

for sale
£325,000



Property Description

A stunning, modern, three bedroom detached family home in the beautiful village of Tutbury that offers modern style and immaculate presentation throughout! This beautiful family home is available with no upward chain and benefits from a larger than average rear garden for a new build home. Internally the property has stunning presentation and is decorated in a neutral but broadly appealing style. Book your viewing with Burchell Edwards today!

Entrance Hallway

Storage cupboard housing central heating boiler, stairs to first floor accommodation and central heating radiator.

Guest W.C

Double glazed window to side elevation, W.C, wash hand basin, central heating radiator and extractor.

Lounge

19' 6" x 10' 3" (5.94m x 3.12m)
Double glazed window and French doors to rear elevation and central heating radiator.

Kitchen/ Diner

11' 11" max x 15' 3" max (3.63m max x 4.65m max)
Two double glazed windows and door to side elevation, a range of wall and base units with work surface over incorporating a sink with drainer unit, integrated cooker and hob, extractor hood and integrated fridge freezer.

Landing

Double glazed window to side elevation, loft access via hatch and airing cupboard.

Bedroom One

18' 8" x 9' 4" (5.69m x 2.84m)
Two double glazed windows to front elevation, central heating radiator and built in wardrobe.

En-Suite

W.C, wash hand basin, shower cubicle, extractor fan, heated towel rail and tiling to walls.

Bedroom Two

12' 2" max x 8' 4" (3.71m max x 2.54m)
Double glazed window to rear elevation and central heating radiator.

Bedroom Three

10' 5" x 7' 1" (3.17m x 2.16m)
Double glazed window to rear elevation and central heating radiator.

Bathroom

W.C, wash hand basin, heated towel rail, bath, extractor fan and half tiled walls.

Rear Garden

Slabbed patio and large lawned area.

Garage

Single garage with up and over door to front elevation, power and lighting.







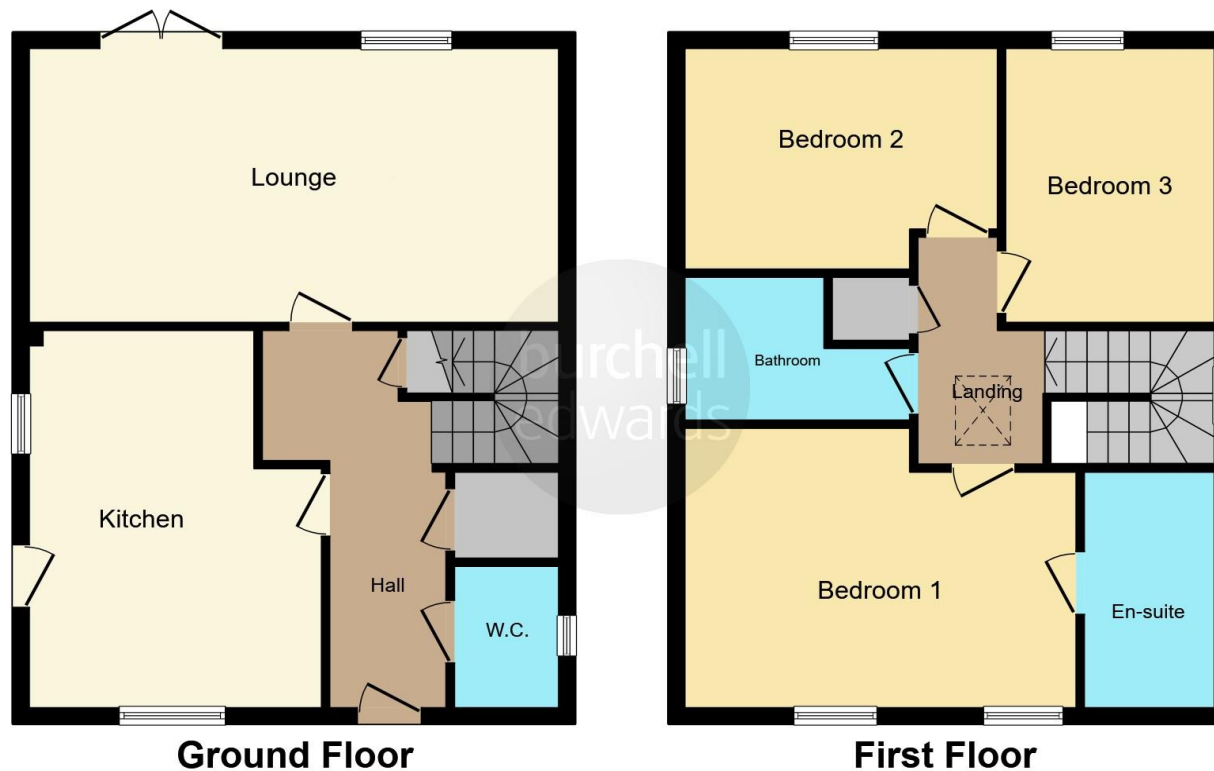

This floor plan is for illustrative purposes only. It is not drawn to scale. Any measurements, floor areas (including any total floor area), openings and orientation are approximate. No details are guaranteed, they cannot be relied upon for any purpose and they do not form part of any agreement. No liability is taken for any error, omission or misstatement. A party must rely upon its own inspection(s). Powered by www.focalagent.com

To view this property please contact Burchell Edwards on

T 01283 530 169
E burton@burchelledwards.co.uk

Britannia House Station Street
 BURTON-ON-TRENT DE14 1AN

EPC Rating: B

Tenure: Freehold

view this property online burchelledwards.co.uk/Property/BUT210460



1. MONEY LAUNDERING REGULATIONS Intending purchasers will be asked to produce identification documentation at a later stage and we would ask for your co-operation in order that there will be no delay in agreeing the sale. 2. These particulars do not constitute part or all of an offer or contract. 3. The measurements indicated are supplied for guidance only and as such must be considered incorrect. Potential buyers are advised to recheck measurements before committing to any expense. 4. We have not tested any apparatus, equipment, fixtures, fittings or services and it is in the buyers interest to check the working condition of any appliances.

Burchell Edwards is a trading name of Connells Residential which is registered in England and Wales under company number 1489613, Registered Office is Cumbria House, 16-20 Hockliffe Street, Leighton Buzzard, Bedfordshire, LU7 1GN. VAT Registration Number is 500 2481 05.

See all our properties at www.burchelledwards.co.uk | www.rightmove.co.uk | www.zoopla.co.uk

Property Ref: BUT210460 - 0003