



Harper Avenue, Burton-On-Trent

burchell  
edwards





## Property Description

Burchell Edwards are delighted to bring to market this 3-bedroom semi-detached family home, on a popular road with good local schooling within easy reach.

This 1950's property welcomes you with off-road parking to the front, where gated side access also leads around to the rear garden. A patio area sits in front of a long rear plot, which boasts natural lawn and fruit trees, finishing with greenhouse and shed to the end.

Entry at the front door opens into hallway, with stairs up to the 1st floor and doorway off into lounge reception room. This leads through to an airy and light kitchen-diner, thanks to large French patio doors opening out to the rear. The fully-fitted kitchen has ample storage and modern units.

The 1st floor accommodation consists of 2 double bedrooms and further single, as well as family bathroom with full 3-piece suite. Finally, the landing space offers ladder access to the boarded and insulated loft space. Viewing advised.

## Entrance Hallway

Laminate flooring and central heating radiator.

## Lounge

11' 11" x 13' 10" ( 3.63m x 4.22m )

Double glazed window to front elevation, central heating radiator, laminate flooring, gas fire place and storage under stairs.

## Kitchen/ Diner

16' 11" x 9' 6" ( 5.16m x 2.90m )

Double glazed window and French patio doors to rear elevation, a range of wall and base units with work surface over incorporating a sink with drainer unit, double gas cooker, extractor, vertical central heating radiator, space and plumbing for washing machine, vinyl flooring and tiling to splash prone areas.

## Landing

Double glazed window to side elevation, loft access and carpet.

## Bedroom One

12' 8" x 10' 2" ( 3.86m x 3.10m )

Double glazed window to rear elevation with blinds, carpet and central heating radiator.

## Bedroom Two

9' x 10' 1" ( 2.74m x 3.07m )

Double glazed window to front elevation with blinds, carpet and central heating radiator.

## Bedroom Three

9' 8" x 6' 6" ( 2.95m x 1.98m )

Double glazed window to rear elevation with blinds, carpet and central heating radiator.

## Bathroom

Double glazed window to side elevation, wash hand basin, W.C, electric shower over bath, vinyl flooring, extractor, full height tiles and central heating radiator.

## Loft Space

Insulated and boarded with ladder access.

## Front Garden

Two car block paved driveway providing off road parking.

## Rear Garden

Laid to lawn, patio area, outdoor sockets, outdoor tap, storage shed, greenhouse, gated side access and fencing to boundaries.











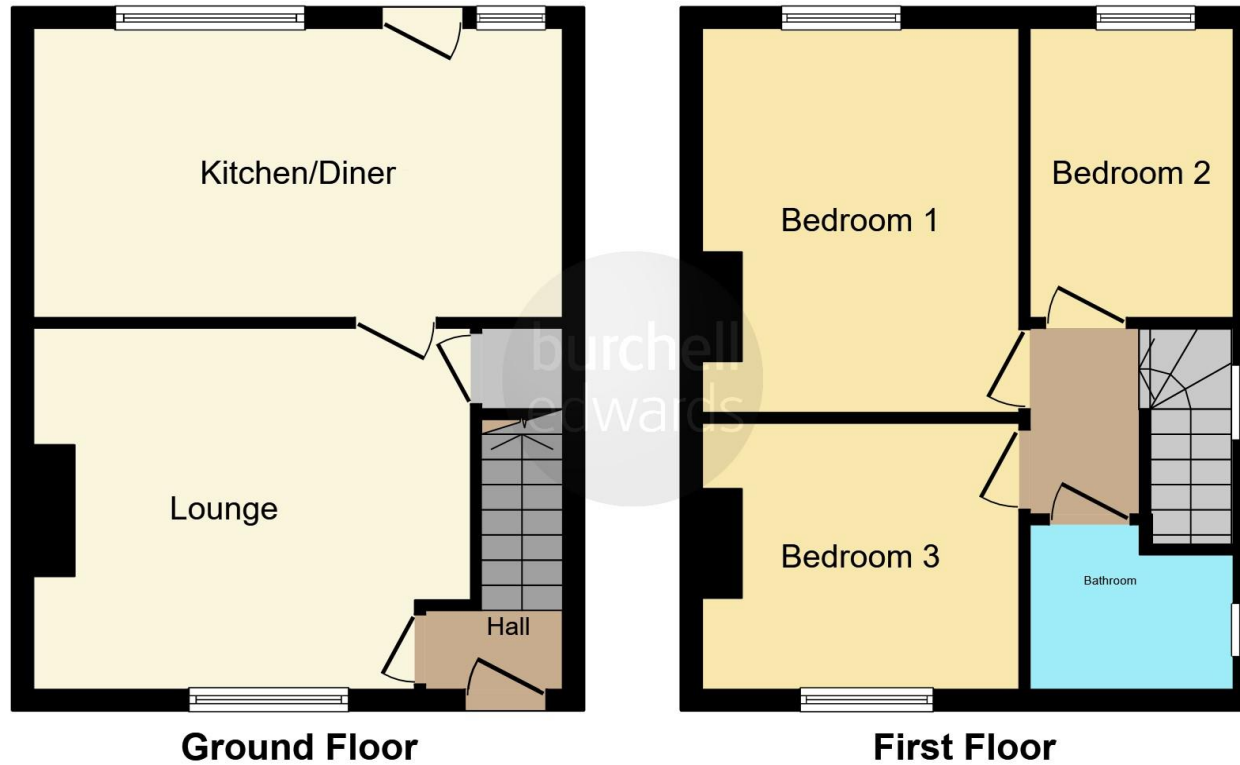

This floor plan is for illustrative purposes only. It is not drawn to scale. Any measurements, floor areas (including any total floor area), openings and orientation are approximate. No details are guaranteed, they cannot be relied upon for any purpose and they do not form part of any agreement. No liability is taken for any error, omission or misstatement. A party must rely upon its own inspection(s). Powered by [www.focalagent.com](http://www.focalagent.com)

To view this property please contact Burchell Edwards on

**T 01283 530 169**  
**E [burton@burchelledwards.co.uk](mailto:burton@burchelledwards.co.uk)**

Britannia House Station Street  
 BURTON-ON-TRENT DE14 1AN

**EPC Rating: D**

Tenure: Freehold

**view this property online [burchelledwards.co.uk/Property/BUT209898](http://burchelledwards.co.uk/Property/BUT209898)**



1. MONEY LAUNDERING REGULATIONS Intending purchasers will be asked to produce identification documentation at a later stage and we would ask for your co-operation in order that there will be no delay in agreeing the sale. 2. These particulars do not constitute part or all of an offer or contract. 3. The measurements indicated are supplied for guidance only and as such must be considered incorrect. Potential buyers are advised to recheck measurements before committing to any expense. 4. We have not tested any apparatus, equipment, fixtures, fittings or services and it is in the buyers interest to check the working condition of any appliances.

Burchell Edwards is a trading name of Connells Residential which is registered in England and Wales under company number 1489613, Registered Office is Cumbria House, 16-20 Hockliffe Street, Leighton Buzzard, Bedfordshire, LU7 1GN. VAT Registration Number is 500 2481 05.

**See all our properties at [www.burchelledwards.co.uk](http://www.burchelledwards.co.uk) | [www.rightmove.co.uk](http://www.rightmove.co.uk) | [www.zoopla.co.uk](http://www.zoopla.co.uk)**

Property Ref: BUT209898 - 0002