



Luton Road
Church Gresley SWADLINCOTE



Luton Road Church Gresley SWADLINCOTE DE11 9TF

for sale
£500,000



Property Description

This stunning six bedroom detached family home is situated in a popular estate position in Church Gresley, Swadlincote. The spacious accommodation offers everything for the family and needs to be seen to fully appreciate the size and finish on offer. Comprising of lounge, dining room, study, kitchen diner, utility and w/c on the ground floor, four bedrooms, an en-suite and the family bathroom on the first floor, while to the second floor are a further two bedrooms, one of which also has an en-suite. Outside to the side is a driveway providing off road parking and access into the double garage while to the rear is a low maintenance garden with patio and artificial lawn.

Kitchen

12' 5" x 12' 2" (3.78m x 3.71m)

A range of wall and base units with work surfaces over and integrated induction hob, double oven, full size fridge/freezer and dishwasher.

Utility Room

6' 10" x 6' 5" (2.08m x 1.96m)

Wall and base units and space and plumbing for a washer/dryer.

Approach

Double driveway and double garage.

Entrance Hall

Laminate floor.

Cloakroom

WC, hand wash basin and central heating radiator.

Lounge

18' x 13' 10" (5.49m x 4.22m)

Windows to side and rear aspect, patio doors to rear aspect, laminate floor and gas fire with surround and mantle over.

Dining Room

12' 7" x 8' 7" (3.84m x 2.62m)

Windows to front aspect, laminate floor and central heating radiator.

Study

10' x 8' 6" (3.05m x 2.59m)

Windows to front aspect, laminate floor and central heating radiator.

Bedroom One

13' 10" x 13' 9" (4.22m x 4.19m)
Walk-in wardrobes, carpet and central heating radiator.

En Suite

Double shower cubicle, bath, WC, hand wash basin and tiled to splashback areas.

Bedroom Two

12' 9" x 8' 8" (3.89m x 2.64m)
Window to front aspect, carpet and central heating radiator.

Bedroom Three

12' 8" x 9' 6" (3.86m x 2.90m)
Window to rear aspect, fitted wardrobes, carpet and central heating radiator.

Bedroom Four

11' 5" x 8' 6" (3.48m x 2.59m)
Window to front aspect, fitted wardrobes, carpet and central heating radiator.

Bathroom

Frosted window to front aspect, shower, bath, WC, hand wash basin, tiled to splashback areas and central heating radiator.

Second Floor

Bedroom Five

14' 9" x 11' 7" (4.50m x 3.53m)
Velux window, carpet and central heating radiator.

En Suite

Shower, WC, hand wash basin, tiled to splashback areas and central heating radiator.

Bedroom Six

15' 1" x 7' 9" (4.60m x 2.36m)
Velux window, carpet and central heating radiator.

Garden

Low maintenance garden with a patio and artificial lawn.



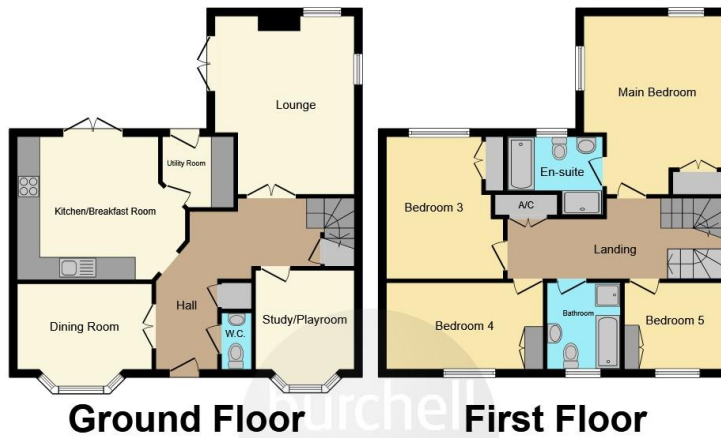

This floorplan is for illustrative purposes only and is not drawn to scale. Measurements, floor-areas, openings and orientations are approximate. They should not be relied upon for any purpose and do not form any part of an agreement. No liability is taken for any error or mis-statement. All parties must rely on their own inspections.

To view this property please contact Burchell Edwards on

T 01283 530 169
E burton@burchelledwards.co.uk

Britannia House Station Street
 BURTON-ON-TRENT DE14 1AN

EPC Rating: C

Tenure: Freehold

view this property online burchelledwards.co.uk/Property/BUT208825



1. MONEY LAUNDERING REGULATIONS Intending purchasers will be asked to produce identification documentation at a later stage and we would ask for your co-operation in order that there will be no delay in agreeing the sale. 2. These particulars do not constitute part or all of an offer or contract. 3. The measurements indicated are supplied for guidance only and as such must be considered incorrect. Potential buyers are advised to recheck measurements before committing to any expense. 4. We have not tested any apparatus, equipment, fixtures, fittings or services and it is in the buyers interest to check the working condition of any appliances.

Burchell Edwards is a trading name of Connells Residential which is registered in England and Wales under company number 1489613, Registered Office is Cumbria House, 16-20 Hockliffe Street, Leighton Buzzard, Bedfordshire, LU7 1GN. VAT Registration Number is 500 2481 05.

See all our properties at www.burchelledwards.co.uk | www.rightmove.co.uk | www.zoopla.co.uk

Property Ref: BUT208825 - 0003