

Knowlton Gardens, Bournemouth, BH9 3RB



£1,400 Per Calendar Month



**** AVAILABLE NOW ** BEAUTIFUL 3BEDROOM FAMILY HOUSE ** PARKING ** GARDEN ** RECENTLY REFURBISHED ** IDEAL MUSCLIFF LOCATION ****

Belvoir Bournemouth are pleased to offer this beautiful 3 bedroom house to let. Ideal Muscliff location, close to Castlepoint

Good size garden, parking and plenty of living space!
Must be seen!! Just been decorated recently.

Available now

Deposit £1615
Council tax band C
EPC band D

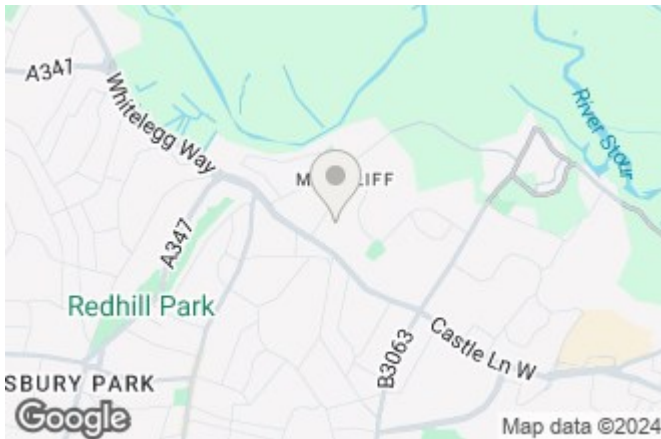

GROUND FLOOR

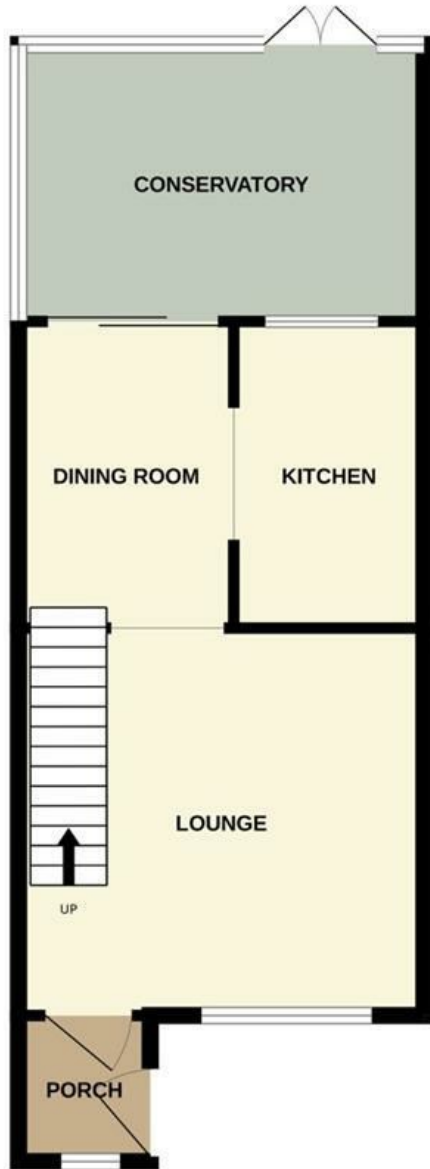

1ST FLOOR

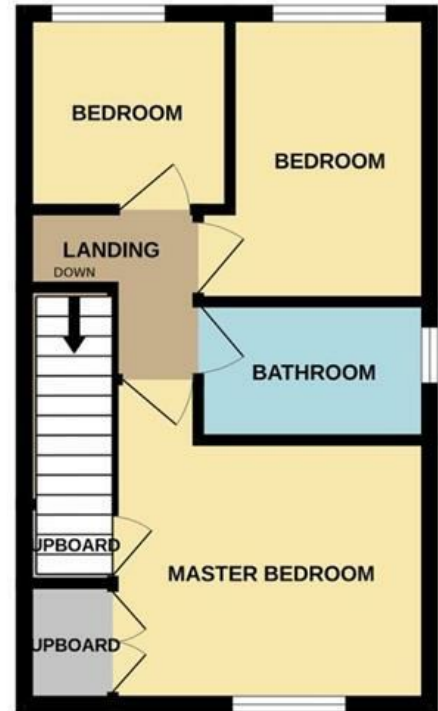

Whilst every attempt has been made to ensure the accuracy of the floorplan contained here, measurements of doors, windows, rooms and any other items are approximate and no responsibility is taken for any error, omission or mis-statement. This plan is for illustrative purposes only and should be used as such by any prospective purchaser. The services, systems and appliances shown have not been tested and no guarantee as to their operability or efficiency can be given.
Made with Metropix ©2024.

Energy Efficiency Rating		Current	Potential
Very energy efficient - lower running costs			
(92 plus) A			89
(81-91) B			
(69-80) C			
(55-68) D		68	
(39-54) E			
(21-38) F			
(1-20) G			
Not energy efficient - higher running costs			
England & Wales		EU Directive 2002/91/EC	

Environmental Impact (CO ₂) Rating		Current	Potential
Very environmentally friendly - lower CO ₂ emissions			
(92 plus) A			
(81-91) B			
(69-80) C			
(55-68) D			
(39-54) E			
(21-38) F			
(1-20) G			
Not environmentally friendly - higher CO ₂ emissions			
England & Wales		EU Directive 2002/91/EC	