



Holt Crescent
Heath Hayes

Holt Crescent Heath Hayes



Lovett&Co. Estate Agents are pleased to offer TO LET this well presented two bedroom mid terraced house set on a quiet cul-de-sac.

The property is well placed to provide easy access to Cannock & Hednesford town centres, both offering a wide range of amenities with both local & national bus and train services available. The location also benefits from being just a few minutes away from Cannock Chase, an area of outstanding natural beauty. Commuter benefits include A460, A5 and M6 toll road linking the midlands motorway network.

The standout features of the property include: spacious lounge-diner, superb modern fitted kitchen, private rear garden and off road parking.

SORRY NO SMOKERS, DSS OR PETS

The property comprises:

RECEPTION HALL:

LOUNGE-DINER:

11' 6" x 16' 8" (3.50m x 5.07m)

KITCHEN:

7' 9" x 9' 3" (2.37m x 2.82m)

FIRST FLOOR LANDING:

MASTER BEDROOM:

11' 7" x 9' 3" (3.53m x 2.82m)

BEDROOM TWO:

11' 6" x 9' 9" (3.51m x 2.98m)

FAMILY BATHROOM:

EXTERNALLY:

Externally the property features: off road parking and a private rear garden.

VIEWING:

Please contact us on 01543 889410 if you would like to arrange a viewing appointment for this property or require further information.

DISCLAIMER:

These particulars are set up as a general outline only for the guidance of intending purchasers or lessees, and do not constitute part of an offer or contract. All descriptions, dimensions, references to conditions and necessary permissions for use and occupation and other details are given in good faith and are believed to be correct but any intending purchasers or tenants should not rely on them as representations or fact but must satisfy themselves by inspection or otherwise as to the correctness of each of them. No person in the employment of Lovett&Co has any authority to make or give any representation or warranty whatsoever in relation to this property.



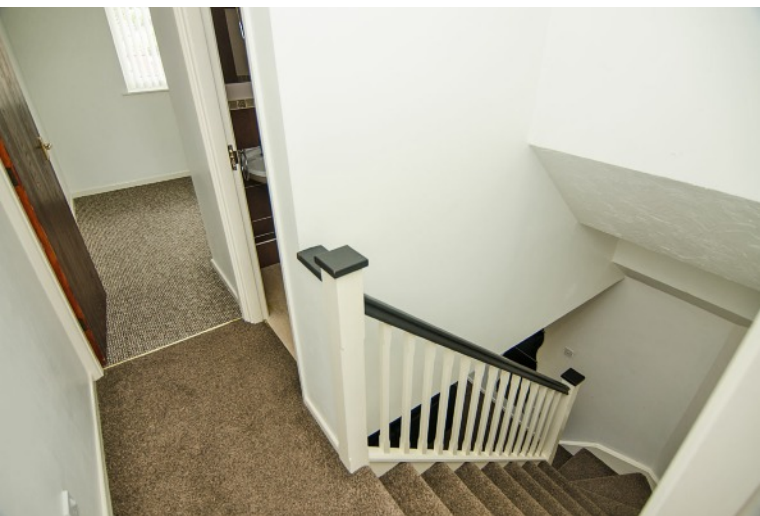

Ground Floor

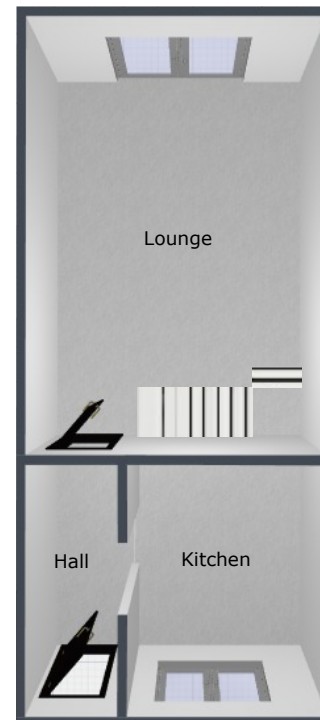

First Floor



FOR ILLUSTRATIVE PURPOSES ONLY, NOT TO SCALE

