



Rugeley Road  
Chase Terrace



# Rugeley Road Chase Terrace



Lovett&Co. Estate Agents are pleased to offer for sale this two bedroom end terraced home ideal for first time buyers or investors.

The property boasts a modern finish throughout with briefly comprises: front lounge, modern fitted breakfast kitchen, landing, two bedrooms and a modern bathroom. There is also a low maintenance landscaped private rear garden with patio, artificial grass area and gated side access which collects the sun all day long.

Other features include: UPVC double glazing and gas central heating throughout.

Rugeley Road is ideally placed to take advantage of local amenities. Sankeys corner is a short walk away, whilst a range of further facilities are close by including: Doctors surgery, Morrisons superstore, good local schooling, and excellent leisure facilities within the wider area of Burntwood. Commuter benefits include A5, A38 and the M6 toll Road linking the Midlands Motorway network and there are both Cross and Inter City railway lines available from Lichfield Cathedral City with its tourist links and Garrick Theatre, being approximately 4 miles away.

## **LOUNGE:**

12' 3" x 11' 3" ( 3.73m x 3.43m )

UPVC entrance door and window to the front,, carpeted flooring, ceiling light point, radiator with cover, feature recessed shelving units and door to the kitchen.

## **BREAKFAST KITCHEN:**

11' 11" x 11' 2" ( 3.63m x 3.40m )

Range of matching wall and base units incorporating cabinets, drawers and work surfaces plus breakfast bar, inset bowl sink and drainer with mono tap, space for cooker and further white goods such as a large fridge-freezer and washing machine, oven and 4 ring hob with extractor fan, wall tiling, tiled flooring, LED lighting, UPVC window and door to the garden plus door to the stairs.

## **FIRST FLOOR LANDING:**

Carpeted flooring, ceiling light point, doors off to two bedrooms and the bathroom.

## **BEDROOM ONE:**

11' 11" x 11' 3" ( 3.63m x 3.43m )

Carpeted flooring, radiator, ceiling light point and window to front.

## **BEDROOM TWO:**

11' 4" x 6' 10" ( 3.45m x 2.08m )

Built in cupboard, carpeted flooring, ceiling light point, radiator and window to the rear.

## **MODERN BATHROOM:**

White suite comprising: bath with shower above, pedestal wash hand basin, low level W/C, wall tiling, tiled flooring, heated towel rail, ceiling light and window to rear.

## **VIEWING:**

Please contact us on 01543 889410 if you would like to arrange a viewing appointment for this property or require further information.





#### DISCLAIMER:

These particulars are set up as a general outline only for the guidance of intending purchasers or lessees, and do not constitute part of an offer or contract. The sellers has given permission for all descriptions, dimensions, references to conditions, tenure, service charges and necessary permissions for use, occupation and other details to be used and we have taken them in good faith whether

included or not & whilst we believe them to be correct, any intending purchasers or tenants should not rely on them as representations or fact but must satisfy themselves by inspection or otherwise as to the correctness of each of them and have this certified during the conveyancing by their solicitor. No person in the employment of Lovett&Co has any authority to make or give any representation or warranty whatsoever in relation to this property.

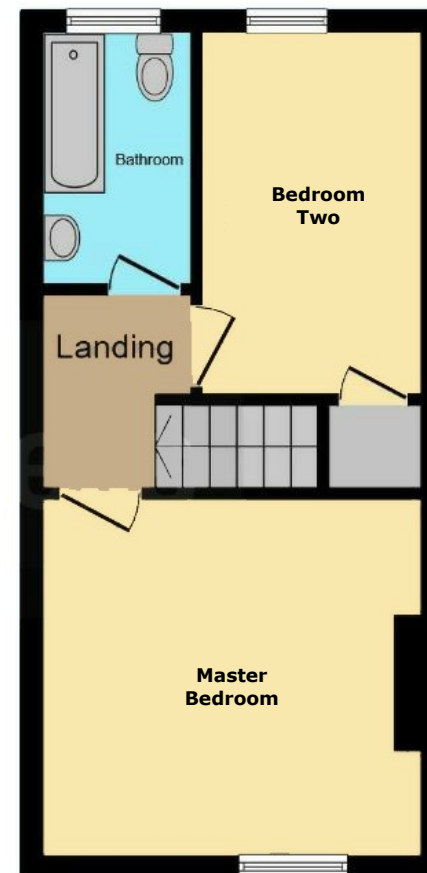
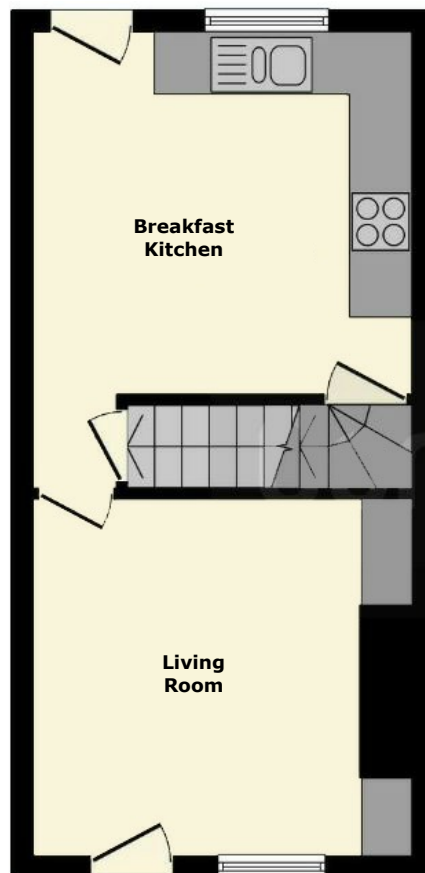

FOR ILLUSTRATIVE PURPOSES ONLY, NOT TO SCALE



