



Cooke Way  
Hednesford

# Cooke Way Hednesford



Lovett&Co. Estate Agents are pleased to offer for sale this well presented two bedroom end-terraced property situated on a the popular new residential development just off Lime Pit Lane.

The property briefly comprises: entrance hallway opening to the kitchen, guest WC, spacious rear lounge-diner, landing, family bathroom and two double bedrooms.

The property occupies a generous plot, one of the largest two bedrooms plots on the estate. Externally there is a private driveway with parking for three cars plus a large private landscaped rear garden with decking area ideal for entertaining, lawn perfect for children and pets to play plus a large shed (negotiable).

The property is well placed to provide easy access to Cannock & Hednesford town centres, both offering a wide range of amenities with both local & national bus and train services available. The location also benefits from being just a few minutes away from Cannock Chase, an area of outstanding natural beauty. Commuter benefits include A460, A5 and M6 toll road linking the midlands motorway network.

## **RECEPTION HALL:**

Entrance door, light point, tiled flooring, store cupboard, doors to the guest WC and lounge plus opening to the the kitchen.

## **KITCHEN:**

6' 5" x 8' 8" (1.95m x 2.65m)

Range of matching wall and base units incorporating cabinets, drawers and work surfaces, inset bowl sink and drainer with mono

tap, integrated oven and 4 ring hob with extractor hood, space for a fridge-freezer and washing machine, tiled flooring, light point and window to the front.

## **LOUNGE:**

13' 0" x 16' 3" (3.95m x 4.95m)

Carpeted flooring, TV aerial & phone sockets, ceiling light point, radiator, French doors to the garden and stairs to the first floor.

## **FIRST FLOOR LANDING:**

Carpeted flooring, ceiling light point, doors off to two bedrooms, family bathroom and access to the loft space.

## **MASTER BEDROOM:**

13' 0" x 9' 4" (3.95m x 2.85m)

Carpeted flooring, radiator, ceiling light point and windows to the front.

## **BEDROOM TWO:**

13' 0" x 8' 4" (3.95m x 2.55m)

Built in wardrobe, carpeted flooring, ceiling light point, radiator and window to rear.

## **FAMILY BATHROOM:**

6' 1" x 6' 4" (1.85m x 1.92m)

White suite comprising: bath with shower over, pedestal wash hand basin, low level W/C, wall tiling, tiled flooring, ceiling light point, radiator and window to side.

## **VIEWING:**

Please contact us on 01543 889410 if you would like to arrange a viewing appointment for this property or require further information.





**DISCLAIMER:**  
These particulars are set up as a general outline only for the guidance of intending purchasers or lessees, and do not constitute part of an offer or contract. The sellers has given permission for all descriptions, dimensions, references to conditions, tenure, service charges and necessary permissions for use, occupation and other details to be used and we have taken them in good faith whether included or not &

whilst we believe them to be correct, any intending purchasers or tenants should not rely on them as representations or fact but must satisfy themselves by inspection or otherwise as to the correctness of each of them and have this certified during the conveyancing by their solicitor. No person in the employment of Lovett&Co has any authority to make or give any representation or warranty whatsoever in relation to this property.

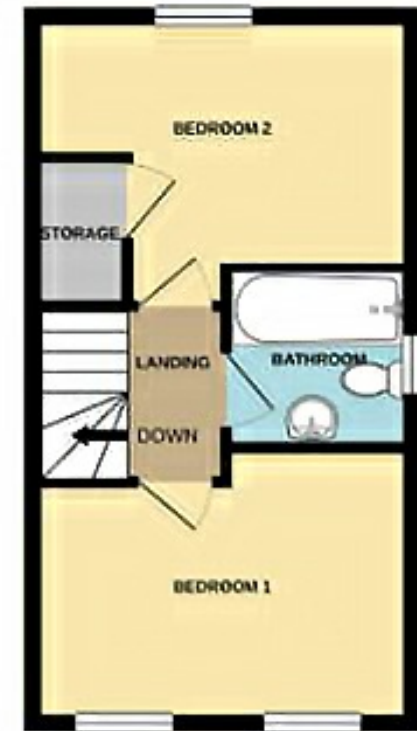
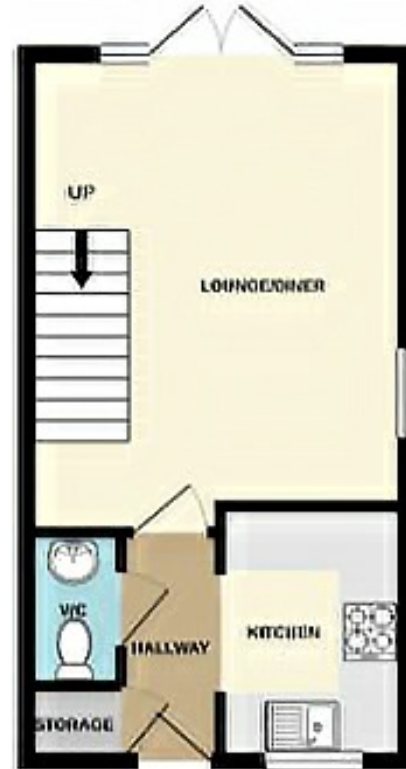

FOR ILLUSTRATIVE PURPOSES ONLY, NOT TO SCALE

