

2 Marshall Street  
Heanor  
Derbyshire  
DE75 7AT  
01773715790  
info@taylorbrownandsimms.co.uk  
www.taylorbrownandsimms.co.uk

**TAYLOR BROWN  
& SIMMS**

ESTATE AGENTS

**The Old Pond, Ilkeston Road, Heanor, Derbyshire, DE75 7BP**  
**£240,000**



**FEATURES:**

- DETACHED BUNGALOW
- THREE BEDROOMS
- SPACIOUS THROUGHOUT
- LOUNGE DINER
- MODERN FITTED KITCHEN
- MODERN FITTED BATHROOM
- GARAGE AND DRIVEWAY
- GOOD SIZED PLOT
- LANDSCAPED GARDENS
- MUST BE VIEWED

**COUNCIL TAX BAND: C EPC RATING: D**

#### **Entrance Hallway**

Doors to all rooms, storage cupboard housing the boiler, storage cupboard, radiator.

#### **Kitchen**

3.28 m x 3.58 m (10'9" x 11'9")

Two UPVC double glazed windows to side aspect, door to side aspect, a range of base and wall units with roll top work surface with upstand, sink unit, integrated oven, hob and extractor above, plumbing for washing machine, space for fridge, vinyl flooring and radiator.

#### **Lounge Diner**

7.15 m x 3.59 m (23'5" x 11'9")

UPVC double glazed windows to rear aspect, UPVC patio doors to rear aspect, two radiators, tv point.

#### **Bathroom**

UPVC double glazed window to front aspect, a modern three piece suite comprising of double shower cubicle, hand wash basin and WC set in a vanity unit, part tiled walls, vinyl flooring, towel rail.

#### **Bedroom One**

9.50 m x 3.62 m (31'2" x 11'11")

Two UPVC double glazed windows to rear aspect, radiator, fitted wardrobes.

#### **Bedroom Two**

3.59 m x 2.82 m (11'9" x 9'3")

UPVC double glazed window to front aspect, radiator.

#### **Bedroom Three**

2.34 m x 1.97 m (7'8" x 6'6")

UPVC double glazed window to front aspect, radiator.

#### **Outside**

To the front of the property is a lawned area, to the rear of the property is a lawned garden which leads around to the side of the property. Wooden garden shed, mature shrubs and borders. Being enclosed via fencing.

There is also a separate detached garage with parking to the front.

## GROUND FLOOR

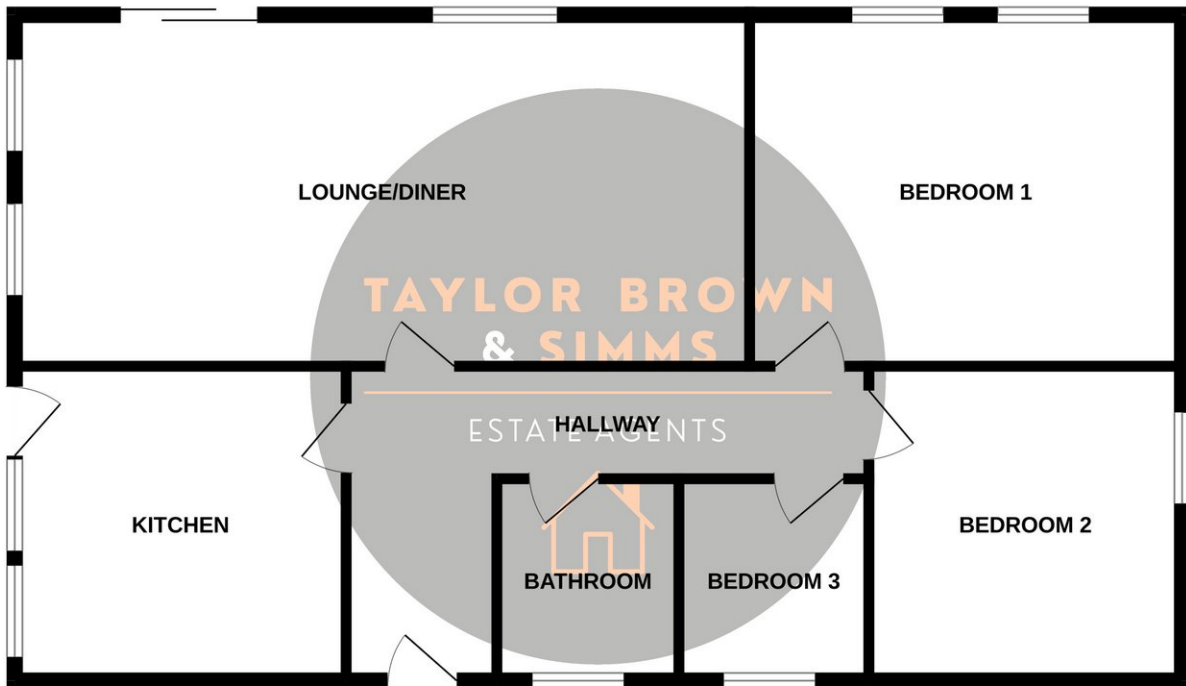

Whilst every attempt has been made to ensure the accuracy of the floorplan contained here, measurements of doors, windows, rooms and any other items are approximate and no responsibility is taken for any error, omission or mis-statement. This plan is for illustrative purposes only and should be used as such by any prospective purchaser. The services, systems and appliances shown have not been tested and no guarantee as to their operability or efficiency can be given.  
Made with Metropix ©2024

### NOTICE TO PROSPECTIVE PURCHASERS

Please note that the information contained within this brochure is understood to be correct and accurate to the best of Taylor Brown & Simms Estate Agents knowledge. However, the information and measurements should not be relied upon to form any part of a contract or any offer made. The information offered is for guidance only particularly in relation to any listed appliances being in full working order. Purchasers should make their own investigations to verify correctness of same particularly if they intend to purchase the property for a specific use or purpose. The information contained within the brochure should not be republished or copied in any way for any other form of advertising or use without Taylor Brown & Simms permission.