

7 Burton Street, Market Harborough, LE16 9GY



£440,000

This prominent and well presented family home is situated on the popular Farndon Fields development located to the southern side of Market Harborough, all within walking distance to the excellent local amenities, shops, schools and station. The property is well balanced offering great living spaces, four bedrooms and delightful Westerly facing garden! The property also benefits from owning a singular solar panel. The accommodation briefly comprises: Entrance hall, lounge, kitchen/diner, WC, main bedroom with en-suite, three further bedrooms and family bathroom. Outside there is off road parking for multiple vehicles, single garage and generous rear garden. The property is offered to market with no upward chain!

Service without compromise

Entrance Hall



The double height and impressive entrance hall is accessed via a double glazed front door with double glazed full length side panes. Doors off to: Lounge and kitchen/diner. Access to under stairs storage. Radiator.

Lounge 20'2 x 11'3 (6.15m x 3.43m)



UPVC double glazed windows to front and side aspects. Tri-fold double glazed doors out to: Rear garden. TV and telephone point. 2 x radiators.

Kitchen/Diner 20'2 x 8'8 (6.15m x 2.64m)



The kitchen has a selection of fitted base and wall units with a Granite worktop over, a 1 1/2 inset stainless steel sink and stylish glass splash back. There is a fully integrated fridge/freezer, dishwasher, single fan assisted oven and five ring gas hob with extractor over. The kitchen/diner has tiled flooring, LED spotlights and tri-fold double glazed doors out to: Rear garden. There is also a good sized utility cupboard with space and plumbing for a freestanding washing machine. Opening through to: Inner hall with stairs rising to: First floor and door to: WC.

Kitchen Area



Dining Area



WC 5'6 x 5'0 (1.68m x 1.52m)

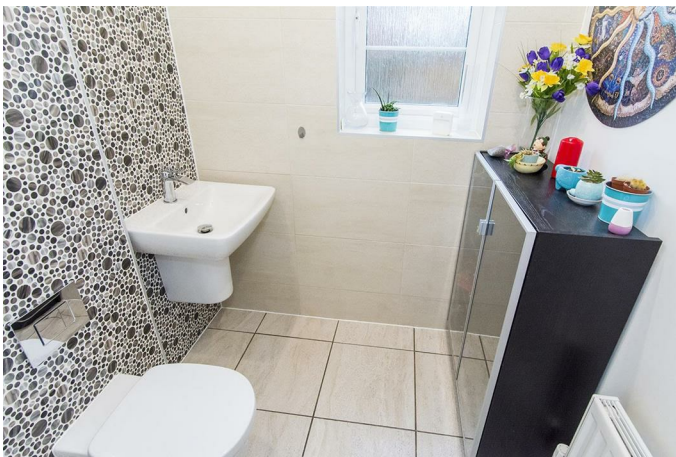

Comprising: Low level WC and wash hand basin. Feature floor and wall tiling. LED spotlights. Radiator. UPVC double glazed window to rear aspect.

Landing

UPVC double glazed window to front aspect. Doors off to: Bedrooms and bathroom. Airing cupboard housing boiler and solar power instrument panel. Loft hatch access. Radiator.

Bedroom One 12'2 (max) x 10'7 (max) (3.71m (max) x 3.23m (max))



UPVC double glazed window to front aspect. Built-in wardrobe with sliding doors. TV point. Radiator. Door to: En-Suite

En-Suite 7'9 x 4'0 (2.36m x 1.22m)



Comprising: Double shower enclosure with feature wall tiling and rainfall shower attachment, low level WC and wash hand basin. There is a built-in storage cupboard, LED mirror, chrome heated towel rail, LED spotlights and tiled flooring.

Bedroom Two 11'5 x 10'3 (3.48m x 3.12m)



UPVC double glazed window to front aspect. TV point. Radiator.

Bedroom Three 9'11 x 7'6 (3.02m x 2.29m)



UPVC double glazed window to rear aspect. TV point. Radiator.

Bedroom Four 9'0 x 6'4 (2.74m x 1.93m)



Currently being used as a study by the previous owner this flexible room could be used as an occasional bedroom, nursery or study. There is a UPVC double glazed window to the rear aspect. Radiator.

Bathroom 7'3 x 6'4 (2.21m x 1.93m)



Comprising: Panelled bath with mixer tap and shower over, low level WC and wash hand basin over a fitted vanity unit. Feature floor and wall tiling. Chrome heated towel rail. LED spotlights. UPVC double glazed window to rear aspect.



Outside



The property occupies a prominent and pleasant position set back from the road having a landscaped front garden area, off road parking for multiple vehicles and a single garage with up and over door having power and light. There is a pedestrian gate providing access into the rear garden. The delightful Westerly facing garden is generous in size being partially walled with a paved patio seating area, lawn and borders.

Solar Panel

The property benefits from a solar panel that is owned outright. The Solar Panel is are only to warm the hot water most efficient in summer months, which the Gas Boiler is available as an alternative or supplement.

Floor Plan

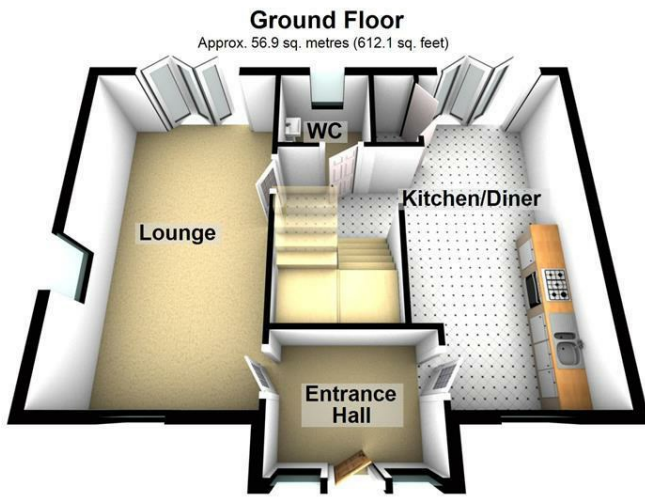

Total area: approx. 113.6 sq. metres (1223.1 sq. feet)

THIS FLOOR PLAN WAS PRODUCED BY ADAMS AND JONES ESTATE AGENTS AND REMAINS PROPERTY OF THEM INDEFINITELY. ADAMS AND JONES RESERVE THE RIGHT TO CHARGE A FEE TO ANY OTHER AGENT OR VENDOR ATTEMPTING TO USE THESE PLANS FOR MARKETING PURPOSES WITHOUT PRIOR WRITTEN PERMISSION.
Plan produced using PlanUp.

Area Map

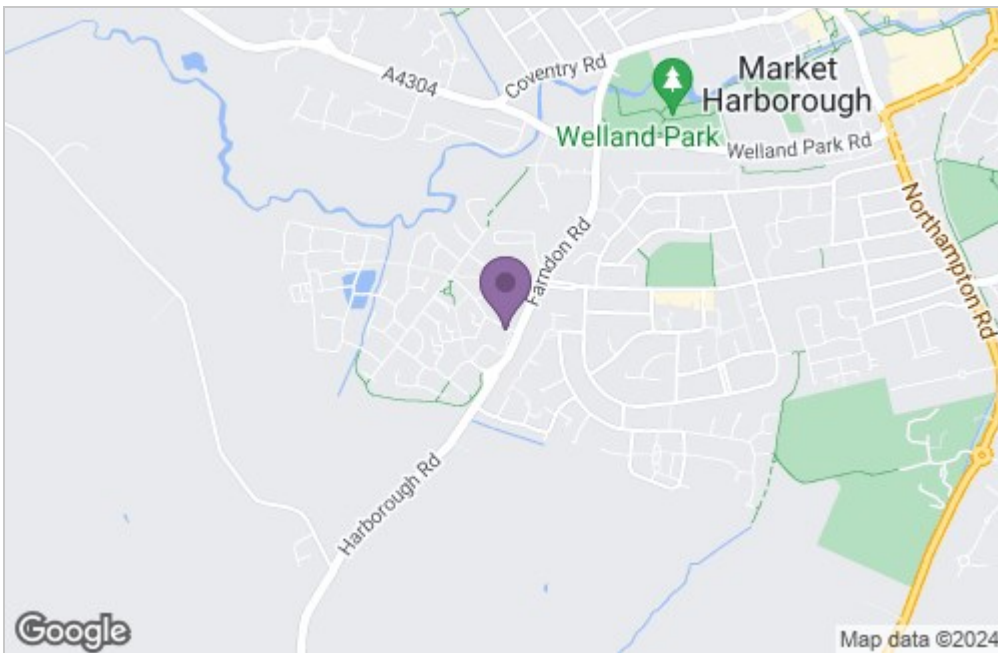

Energy Efficiency Graph

Energy Efficiency Rating		
	Current	Potential
Very energy efficient - lower running costs		
(92 plus) A		
(81-91) B		
(69-80) C		
(55-68) D		
(39-54) E		
(21-38) F		
(1-20) G		
Not energy efficient - higher running costs		
	81	89
England & Wales EU Directive 2002/91/EC		
Environmental Impact (CO ₂) Rating		
	Current	Potential
Very environmentally friendly - lower CO ₂ emissions		
(92 plus) A		
(81-91) B		
(69-80) C		
(55-68) D		
(39-54) E		
(21-38) F		
(1-20) G		
Not environmentally friendly - higher CO ₂ emissions		
England & Wales EU Directive 2002/91/EC		

Service without compromise