



Shirley Gardens, W7

£299,950

This well presented one bedroom first floor flat within a purpose-built development is conveniently located and offered to the market with no onward chain.

Situated in a quiet cul-de-sac approx 0.5 miles from West Ealing (Elizabeth line) station and Waitrose with easy access to the shops and amenities of West Ealing and Ealing Broadway.

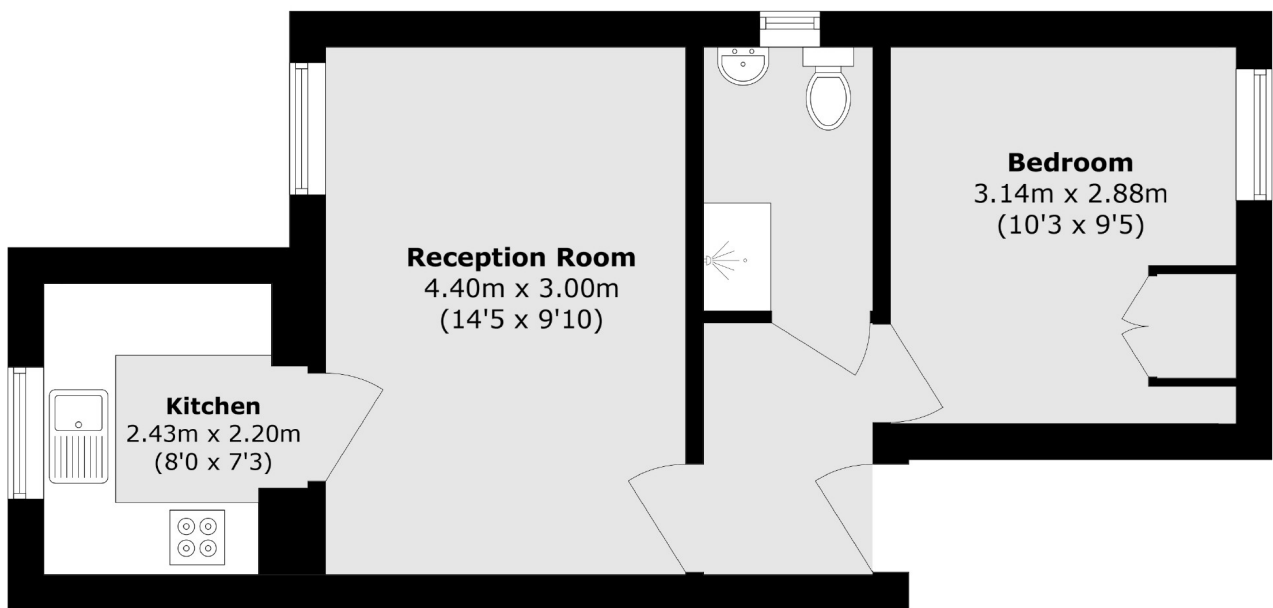

Total area (approx.): 34.9 sq. m (375.6 sq. ft)

Robertson Smith & Kempson Hanwell Sales
69 Greenford Avenue,
London, W7 1LL
020 8566 2339
hanwellsales@robertsonsmithandkempson.co.uk

Energy Rating: C. We aim to make our particulars both accurate and reliable. However they are not guaranteed; nor do they form part of an offer or contract. If you require clarification on any points then please contact us, especially if you're traveling some distance to view. Please note that appliances and heating systems have not been tested and therefore no warranties can be given as to their good working order.